

Hobie H-Crate Assembly and Installation Instructions

Parts List

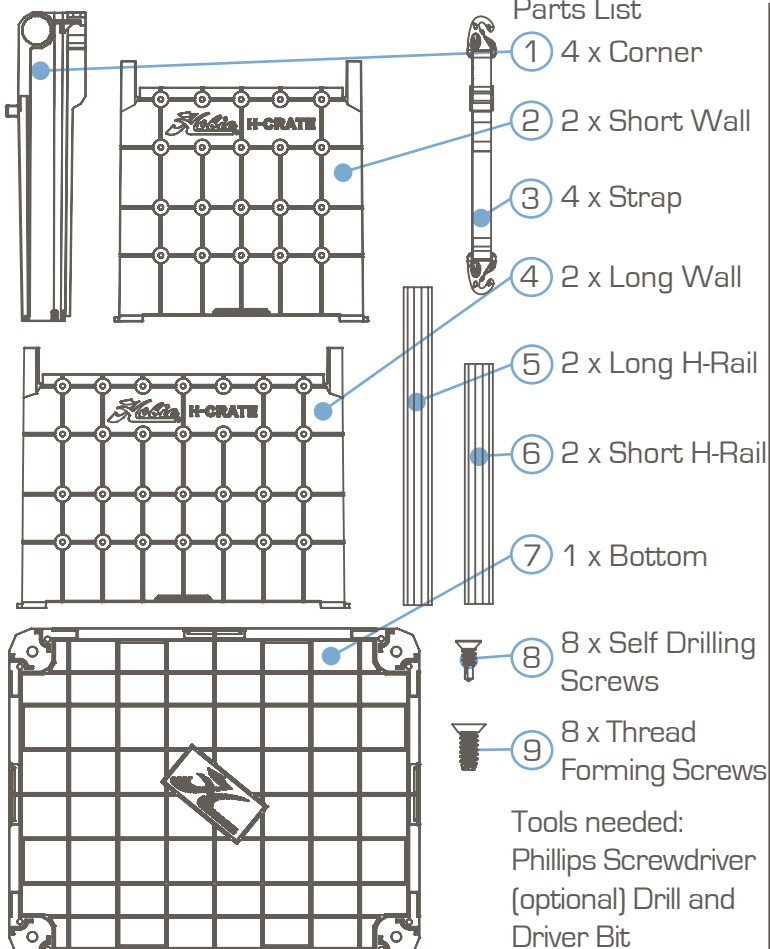

- ① With the flat surfaces aligned, insert 2 long and 1 short H-Rail section into two upside down corner pieces. Then connect the remaining corners using the short H-Rail segment sliding both assemblies together. Ensure the rails go all the way into the corners. You may need to push them together using a flat surface for leverage.

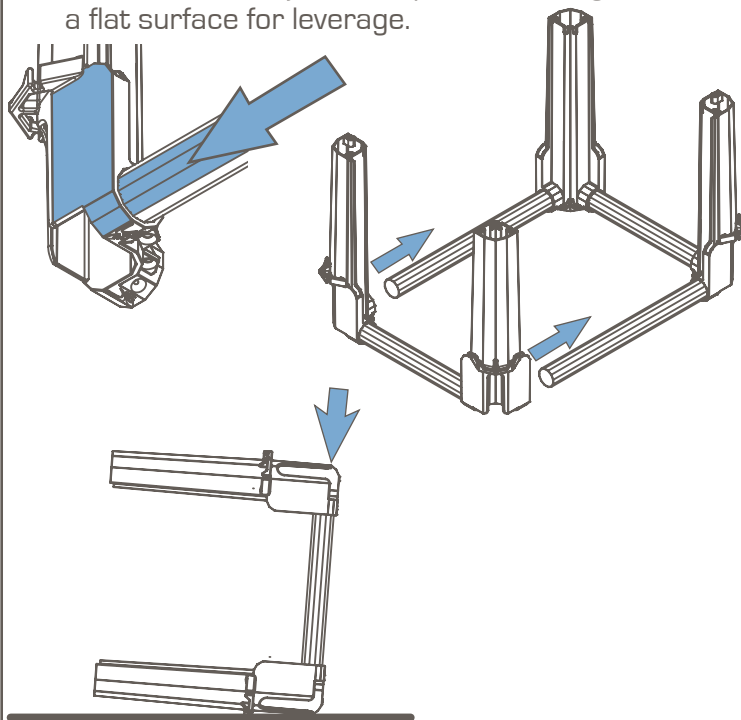

- ② Slide the wall sections into the corners using the tabs at the top and bottom to align.

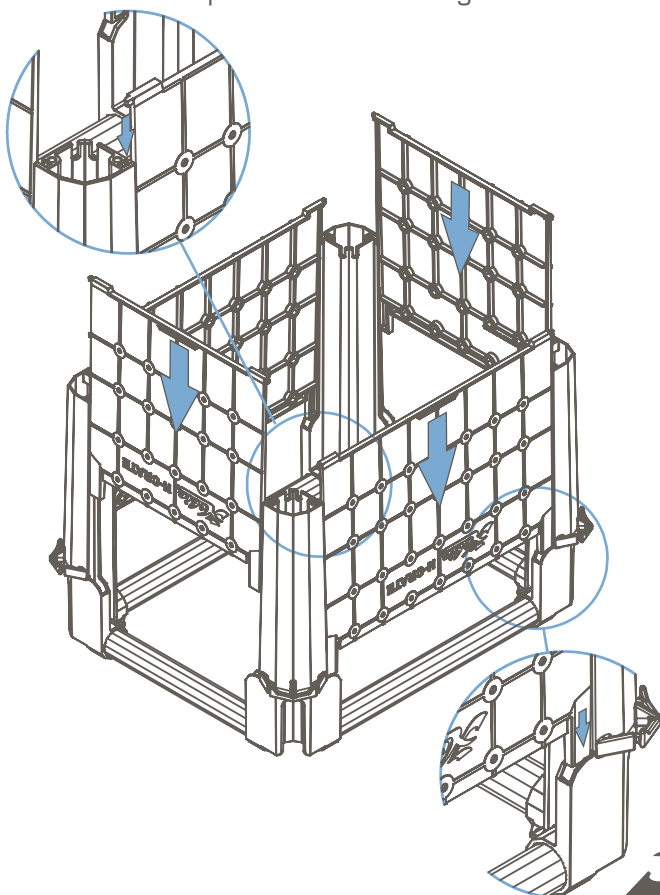

- ③ Align the bottom of the crate. To secure it, first push in the centers of the walls to clear the center snaps and install the thread forming screws in the corners. (optional) To add extra rigidity, you may install the self tapping screws into the holes on top of the corners using a drill.

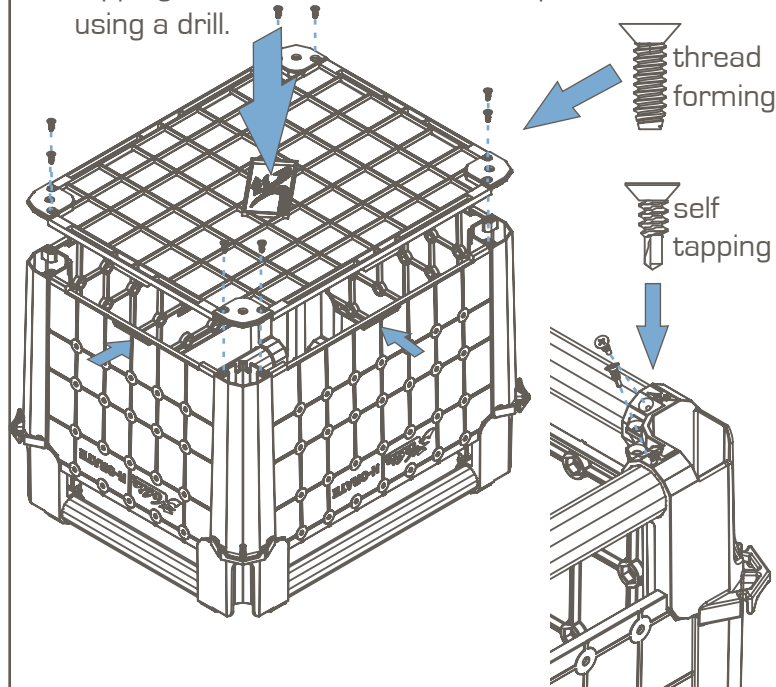

Hobie

REV 141203

- ④ To interlock the tabs in the bottom, turn crate right side up and push the bottoms of the walls outward until the tabs are interlocked.

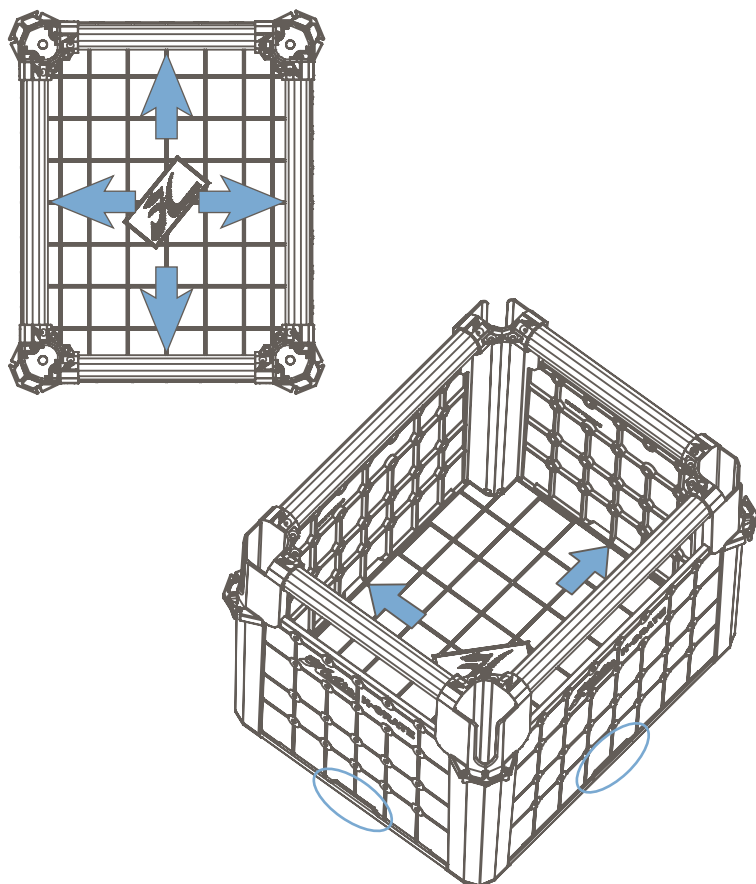

- ⑤ Attach the straps to the pad eyes on each corner of the crate. Install H-Crate in tankwell of kayak and attach clips to available pad eyes. Tighten straps by pulling the loose end of the strap.

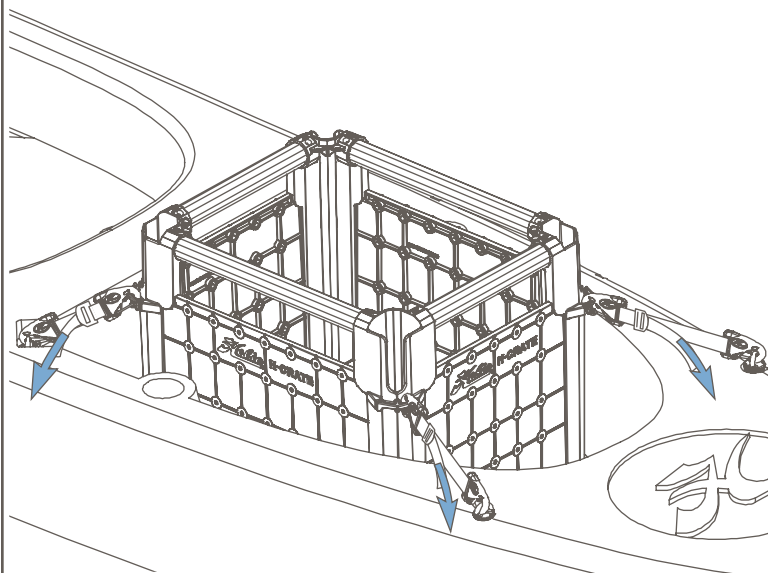

- ⑥ To secure rods, pull bungee handle over reel handle and secure in slot next to pad eye.

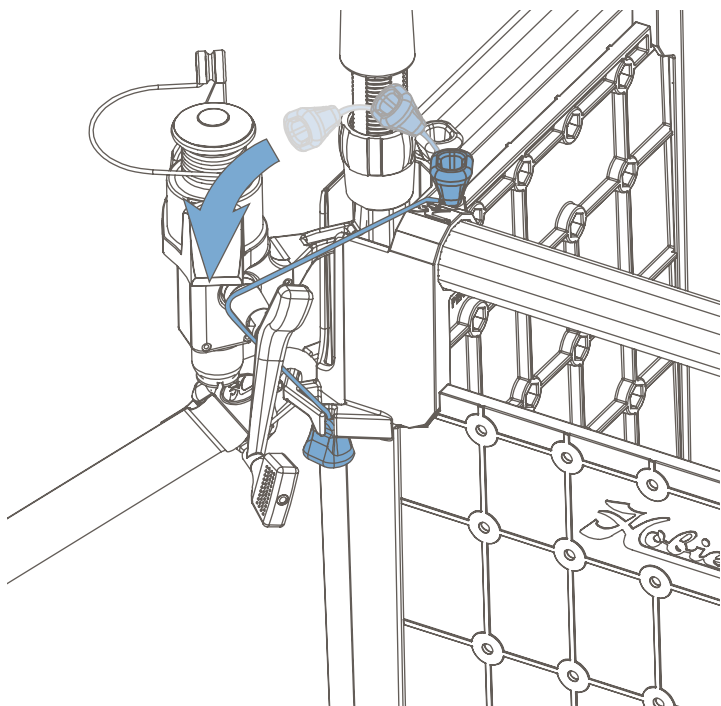

- ⑦ Customize your H-Crate! Here are a few ideas:

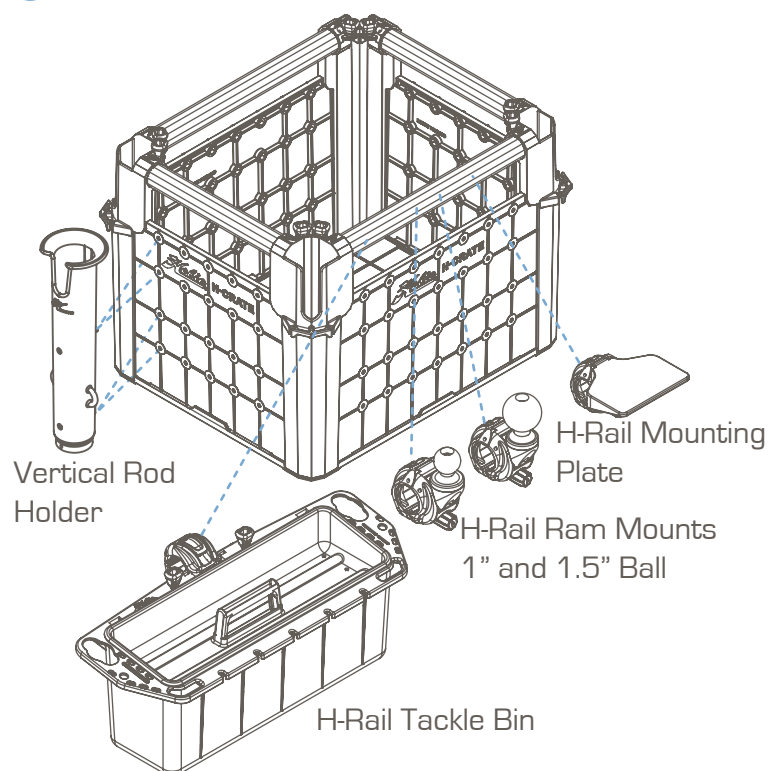

For more tips, tricks and videos go to:
HobieFishing.com

Hobie