

HOBIE GETAWAY PARTS

REPLACEMENT HULL 2021+ / left 37010003
 REPLACEMENT HULL 2021+ / right 37020003

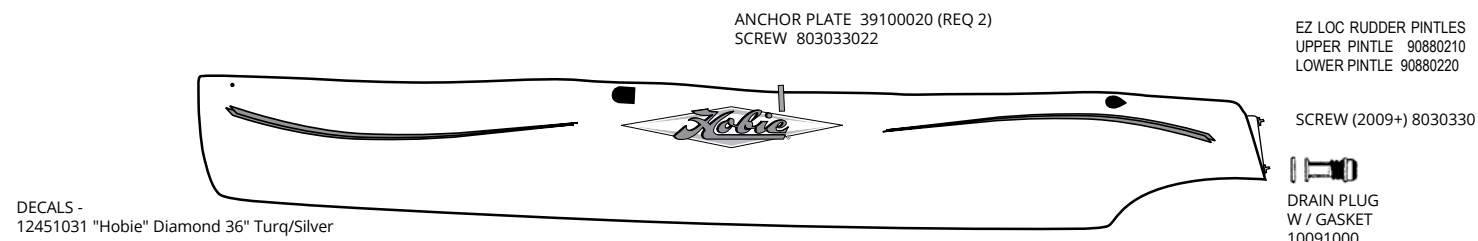

DECALS -
 12451031 "Hobie" Diamond 36" Turq/Silver

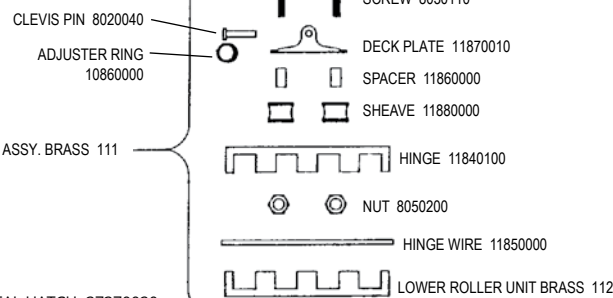
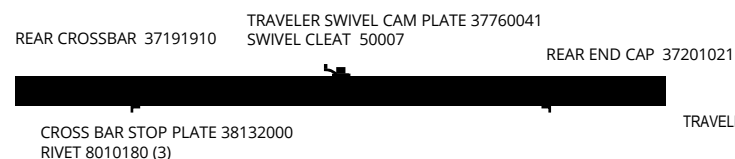
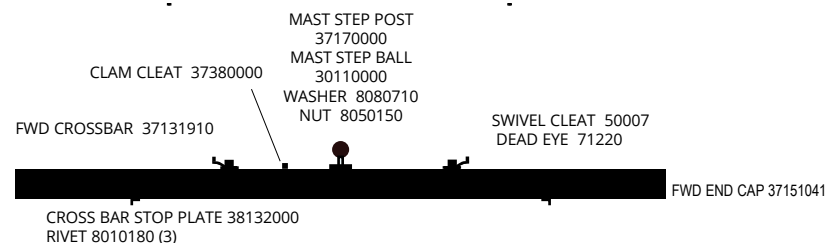

ORIGINAL HATCH*
 *Replacement "O" Ring Seal
 # SPA-4SEAL-S Available from imtra.com
 Not stocked by Hobie Cat

HOBIE TWIST AND SEAL HATCH 37370020
 GASKET 71707002 (REQ 2)
 SCREWS 8032120 (REQ 14)
 5" HATCH (INSIDE) 41370000
 DRAIN ELBOW FITTING 37370036

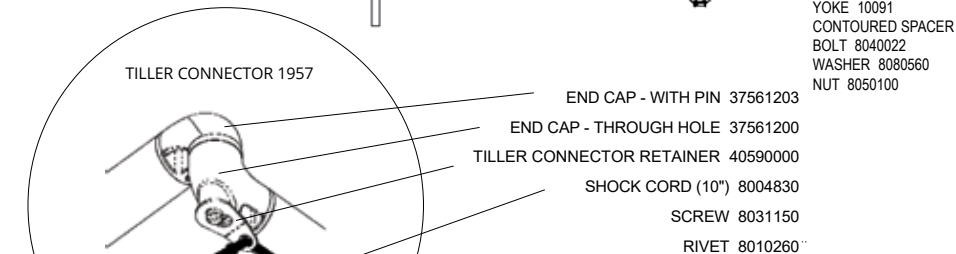
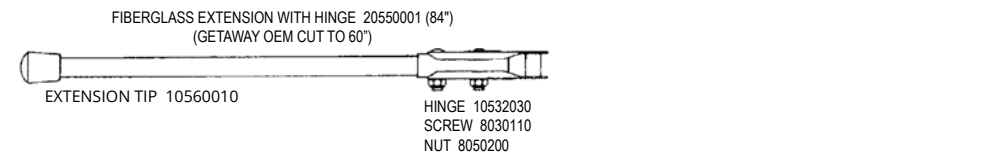
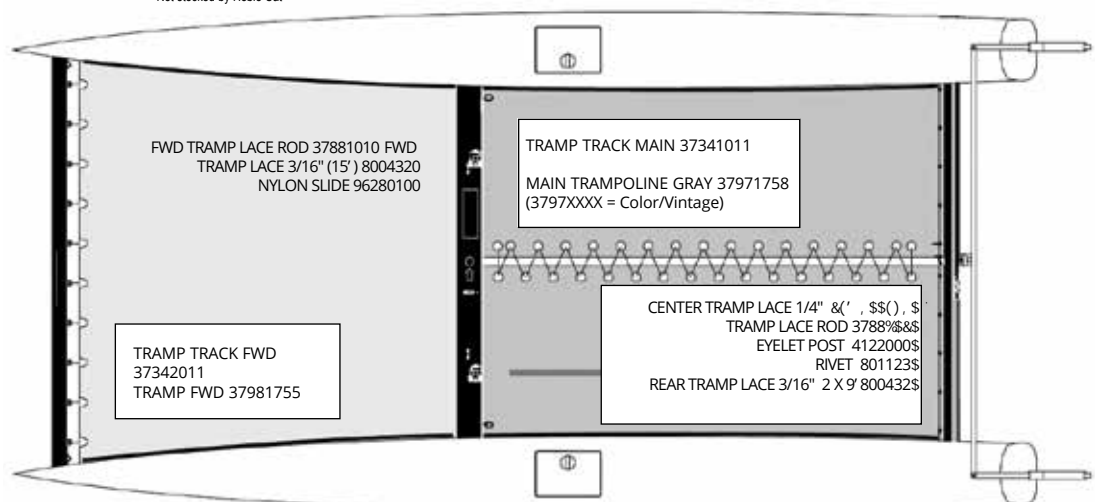

RUDDER ASSEMBLY - EZ LOC 37312000

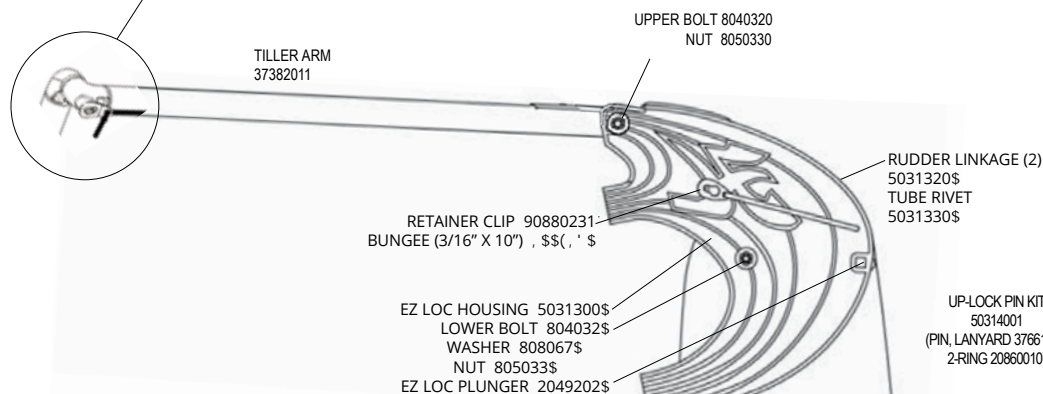

UPDATE OLDER GETAWAY TO EZ LOC

- (2) 37312000 EZ LOC RUDDER ASSEMBLY
- (1) 37524001 TILLER CROSSBAR
- (1) 20550001 HIKING STICK
- (2) 90880210 PINTLE - UPPER
- (2) 90880220 PINTLE - LOWER
- (12) 8030330 SCREW 1/4-20 X 5/8

DANGER:
 ALWAYS USE EXTREME CAUTION WHILE RAISING AND LOWERING YOUR MAST, CONTACT WITH A POWER LINE COULD BE FATAL.

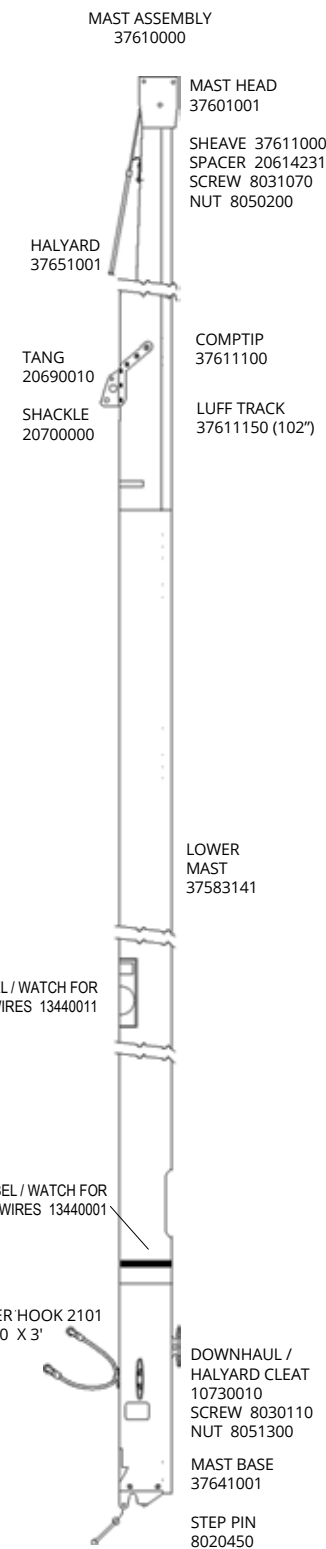

EZ LOC RUDDER BLADE 20491000

FORESTAY / BRIDLES

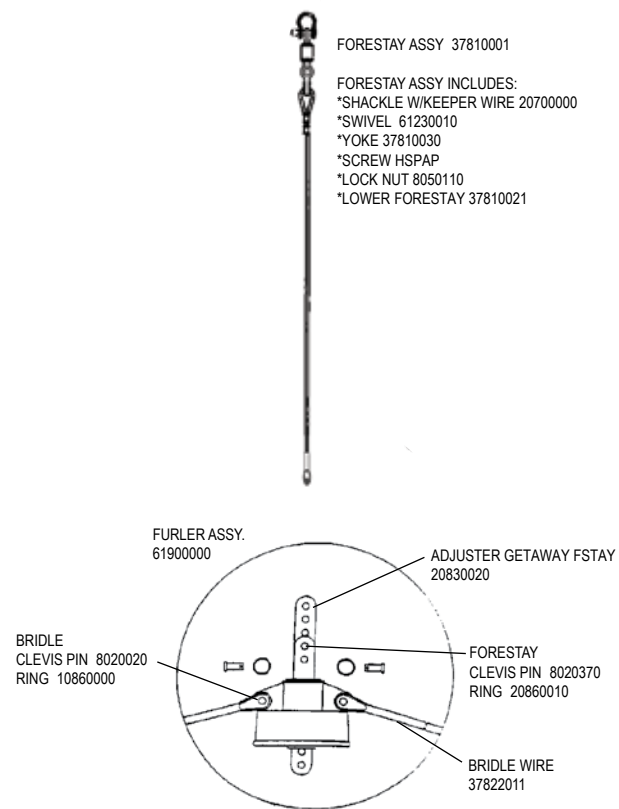

ROLLER FURLER DETAIL

FURLER TUNE UP KIT 61900900
 INCLUDES: BEARINGS, BEARING CAGE, NYLINER, NYLON SLEEVE, DARBY RINGS, SPOOL, HOUSING

- CLEVIS PIN 8020370 RING 20860010
- SHACKLE 10700010
- ADJUSTER 20830020 GTWY FSTAY
- NYLINER 8061100
- NYLON SLEEVE 61941000
- YOKE 61980010
- SPOOL & HOUSING SEE BELOW
- SLEEVE 61951020
- DARBY RING 8062510
- BEARING RACE 61920010
- ***** BEARINGS (REQUIRES 18) 61670010
- BEARING CAGE 61930010
- BEARING RACE 61920010
- DARBY RING 8062500
- TUBE 61910010
- SPOOL & HOUSING 61960001
- NOT SHOWN
- LINE 8004530 X 18" SCREW 8030500

SHROUDS

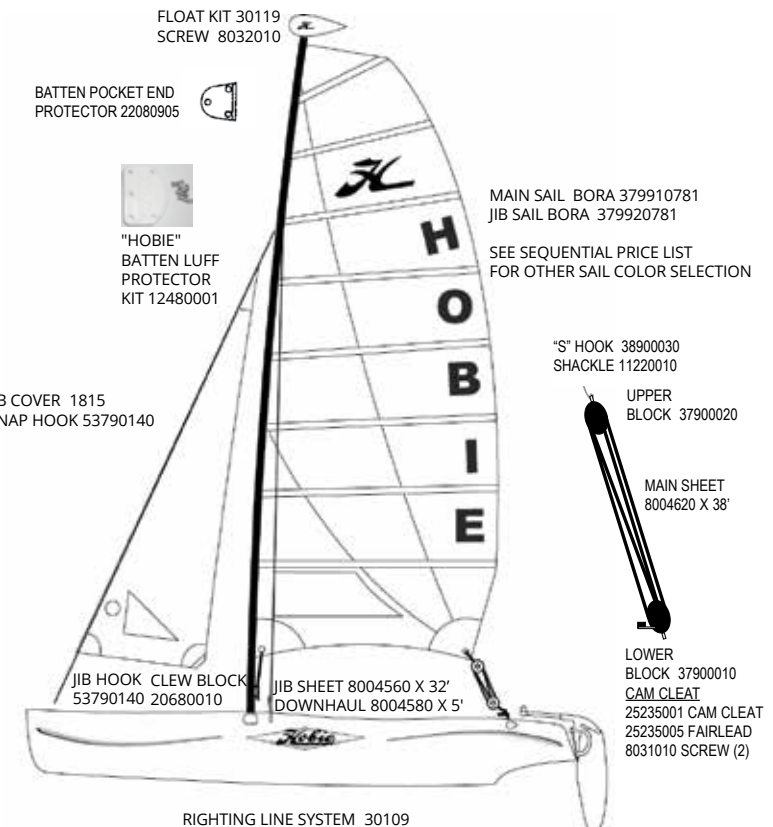
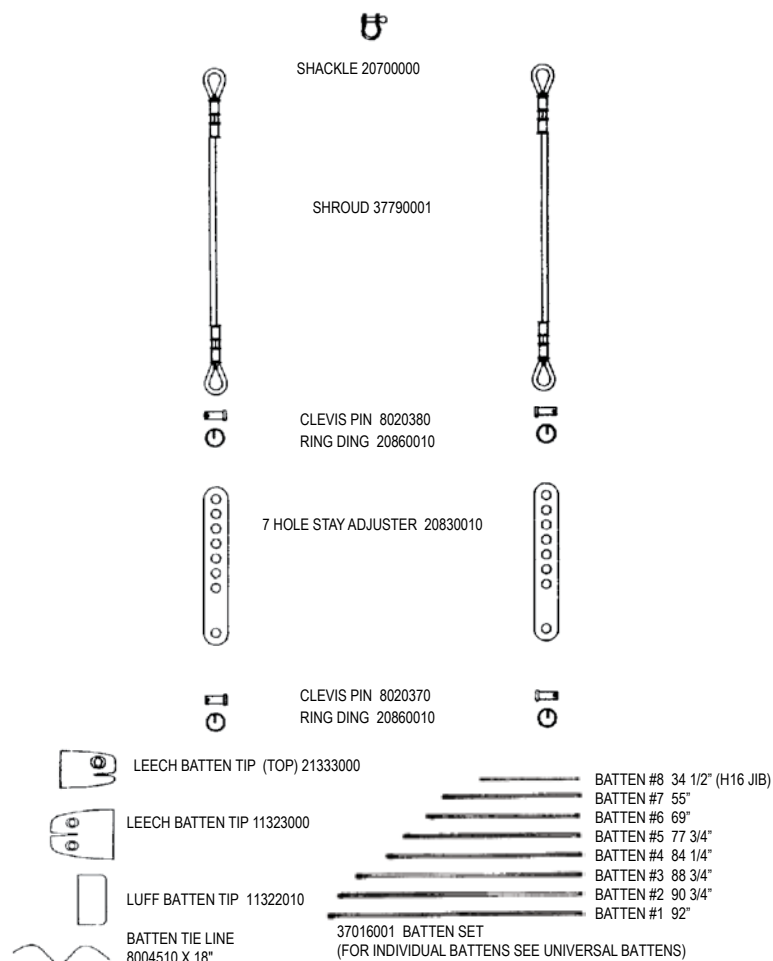

MODEL / YEAR / ACCESSORY VARIATIONS

TILLER CROSSBAR 37524001 (EZ LOC RUDDERS)
 TILLER CROSSBAR 37521001 (OLDER RUDDER CASTINGS / M20 STYLE CONNECTORS)

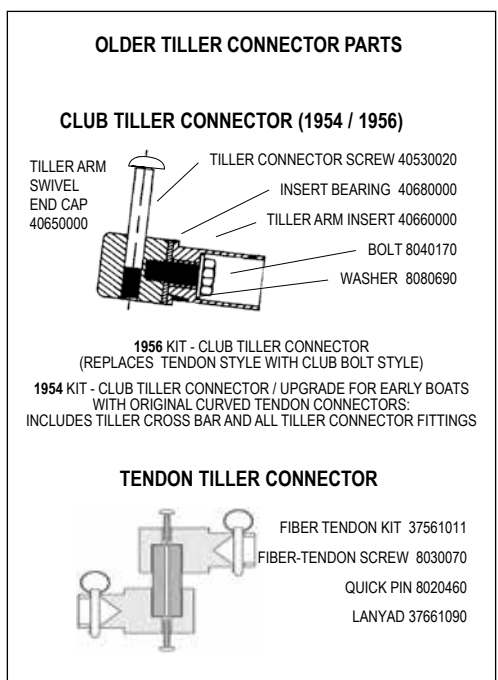

RUDDER ASSEMBLY
 Pre-"EZ LOC" Rudder System
 * = SUB ASSEMBLY PART / INCLUDED WITH CASTING

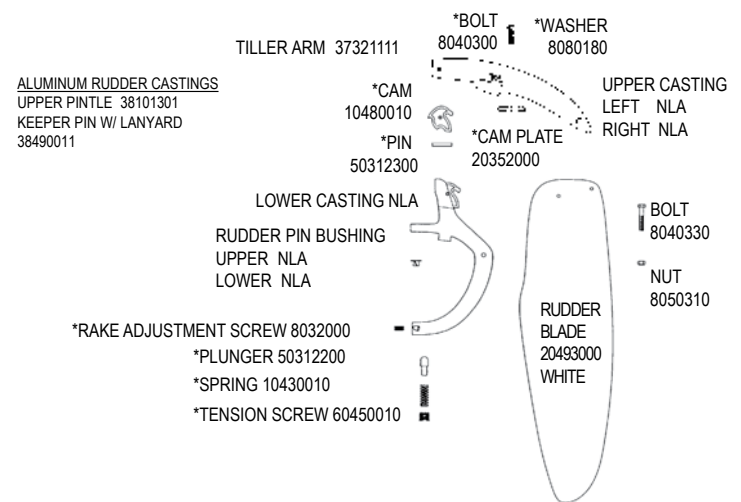

37001035 GETAWAY SUS WING ASSEMBLY (WITH GRAY COVER)

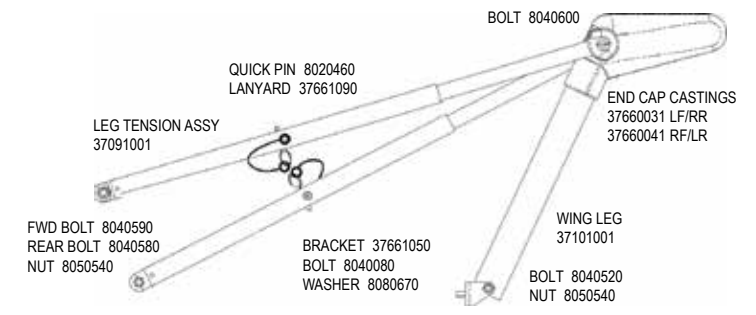
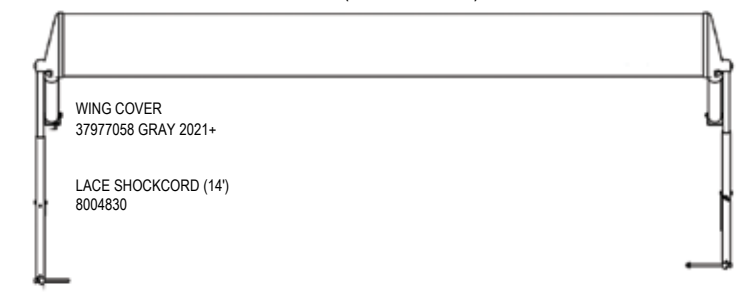

GETAWAY RIVET GUIDE
 () INDICATES QUANTITY NEEDED TO FASTEN PART

| | |
|-------------------------|--------------|
| MAST | |
| HEAD | 8010120 (2) |
| HALYLARD HOOK | 8011230 (2) |
| TANG | 8010120 (12) |
| | 8011290 (12) |
| BUNGEE PAD EYE | 8010180 (2) |
| | 8011290 (2) |
| HALYARD CLEAT | 8010120 (2) |
| | 8011290 (2) |
| BASE | 8010130 (4) |
| | 8011290 (4) |
| BOW SPREADER BAR | |
| PLATES, BRIDLE BOW TANG | 8010180 (4) |
| INTERNAL STIFFENER | 8010200 (4) |
| MAIN CROSSBAR | |
| BEAM STOP PLATES | 8010180 (6) |
| CLEAT | 8010180 (1) |
| PADEYES | 8010180 (4) |
| JAM CLEAT | 8010130 (1) |
| CLEATS, SWIVEL | 8010130 (6) |
| PADEYES | 8010130 (4) |
| END CAPS | 8010200 (10) |
| REAR CROSS BAR | |
| PADEYE | 8010180 (2) |
| BEAM STOP PLATES | 8010180 (6) |
| CLEAT PLATE | 8010130 (4) |
| TRAMP LACE POSTS | 8011230 (10) |
| END CAPS | 8010200 (8) |