



Hobie® Mirage® 360xr
Pro Angler 12/14 Manual

In 1950, Hobie's dream was born in his parents' garage when he decided to apply his love of woodworking to the sport of surfing. Dad backed out the Buick... Hobie carved out his very first surfboard...

Hobie's business of fun had begun.

Anatomy	5
Assembly	6
MirageDrive®	8
On The Water	12
Vantage Seating.....	13
Tuning	17
Fishfinder Option.....	19
H-Rail System	27
Storage and Transport	31
Maintenance and Care	34
Safety	36
Warranty.....	38

If you have any questions about assembly or installation, visit
www.hobie.com/support/

or scan the QR code below with your smart phone
to view instructional videos



1. Hull
2. Vantage Chair
3. MirageDrive 360
4. Paddle and T-Handle
5. Lowrance Ready Components
6. Tackle Management Rack
7. 2X Plano® 3640 Tackle Boxes
8. 2X H-Rail Rod Rack
9. H-Rail Cup Holder
10. Mirage Well Scupper Plug
11. 2X Steering Handle Components
12. 360 Steering Handle

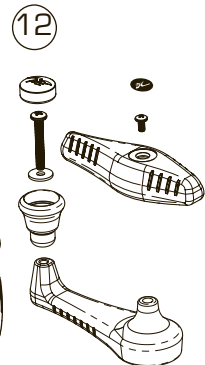
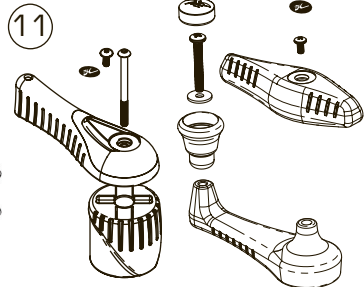
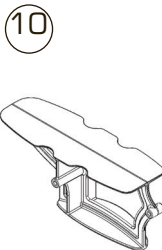
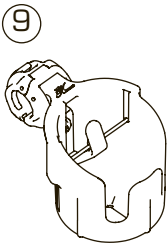
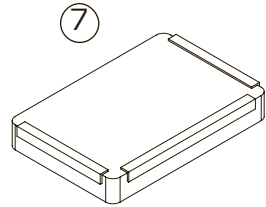
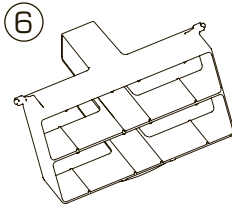
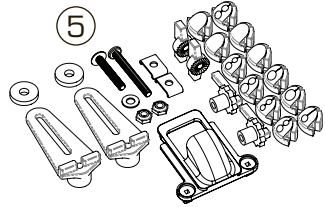
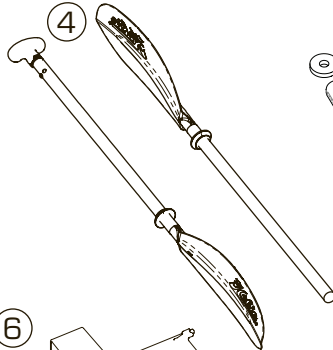
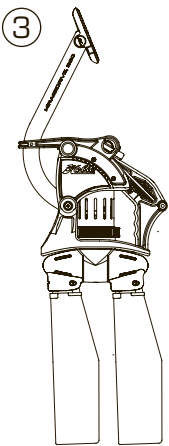
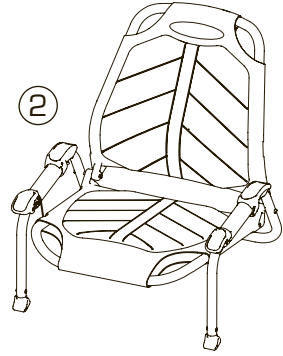
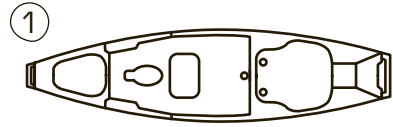

Items not shown to scale

Tackle Management Rack Installation

①

Twist handle counter-clockwise and open lid

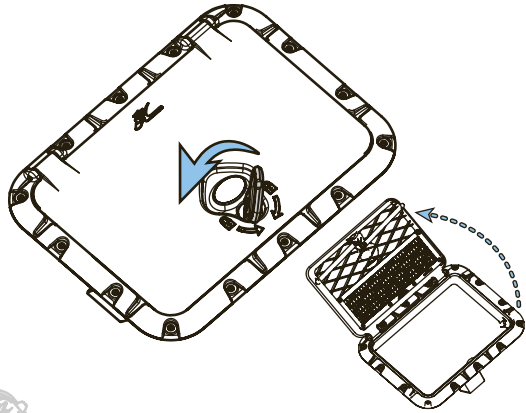

②

Press rack to the side to insert pin into the hole and lower the other side to snap in place.

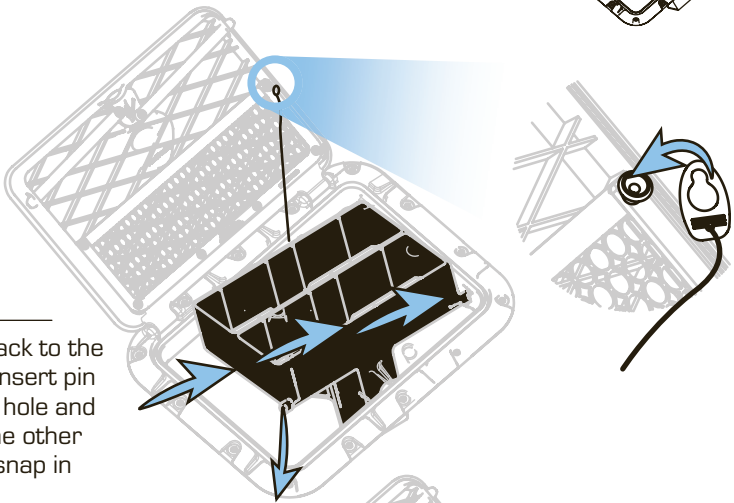

③

Secure clip to post

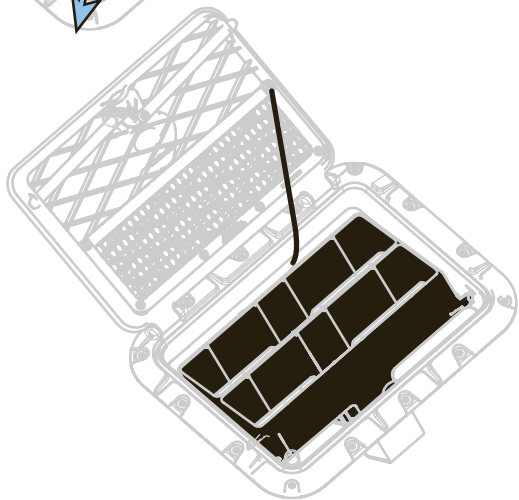

Steering Handles

①

Install the steering handle and riser on the right side.

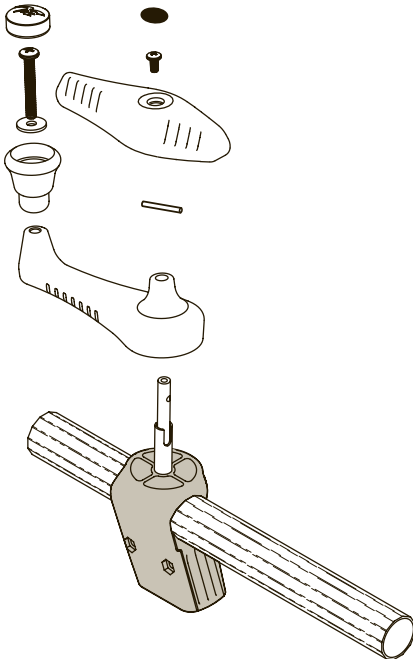
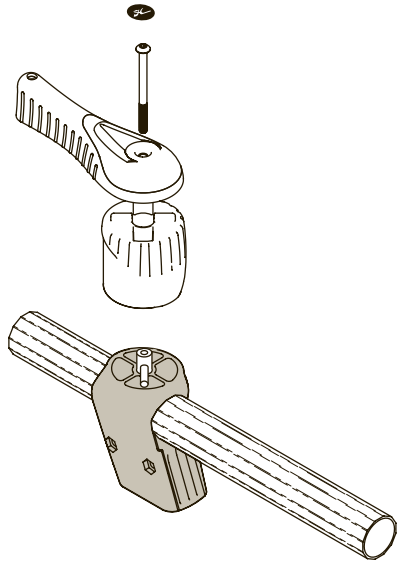

②

Install the combination rudder handle and 360 handle on the left side.

To attach the rudder handle to the crank, reach into the hatch and push up on the steering assembly while pressing down on the rudder handle.

To attach the 360 handle, press pin through hole in 360 crank, place 360 handle over crank and pin, screw handle to crank.

Installation

①

Make sure the steering handle is straight.

Lower drive straight down making sure the fins are facing forward.

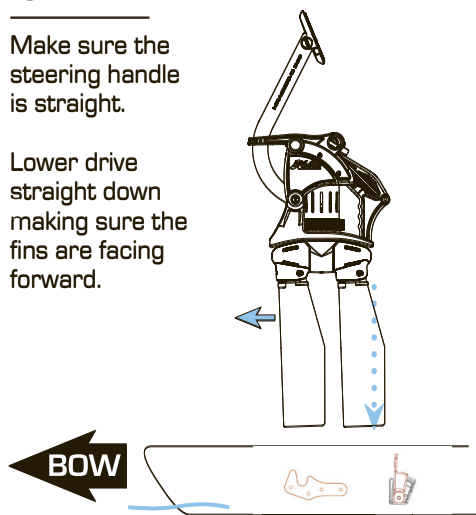

②

Press down to lock drive into Click and Go.

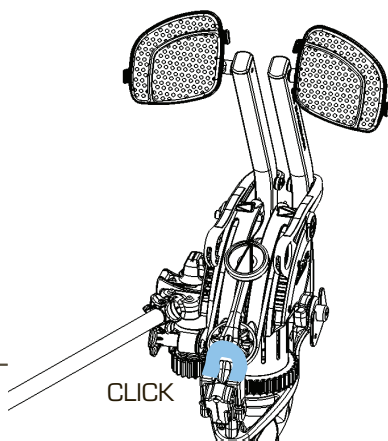

Removal

①

With fins facing forward, pull back the Click and Go lever

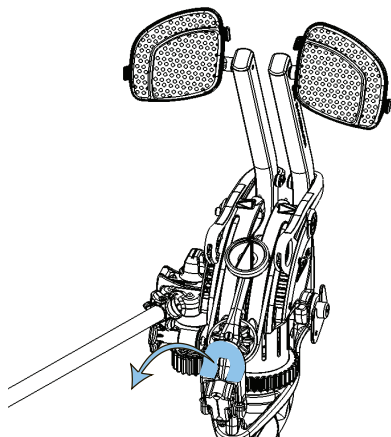

②

Lift drive straight up.

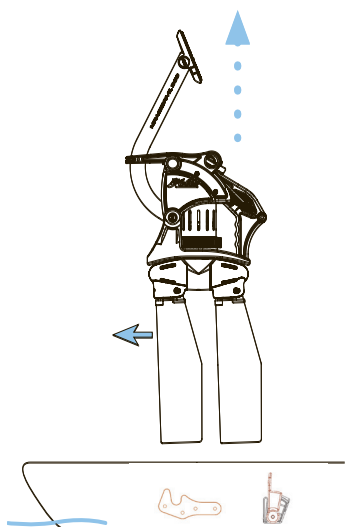

Pedal Adjustment

①

Squeeze the trigger and pull up on the adjustment handle.

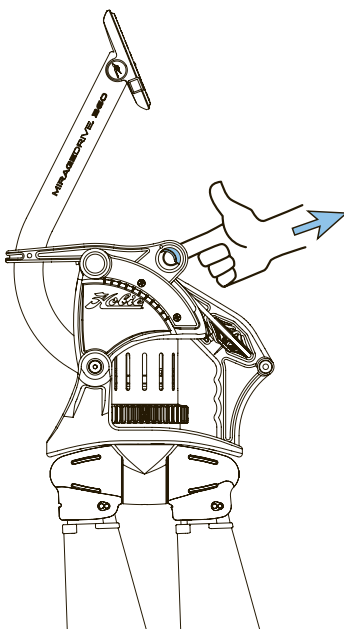

②

Adjust cranks by sliding the adjustment handle. Make sure both cranks are positioned to the same number.

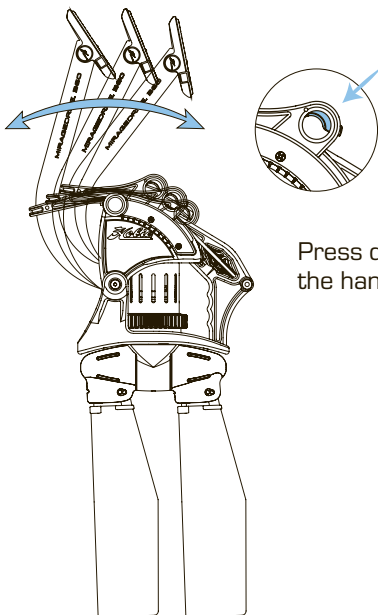

Press down on the handle to lock.

③

With both feet on the pedals together (fins straight down), your knees should be comfortably bent and not over-crunched or extended.

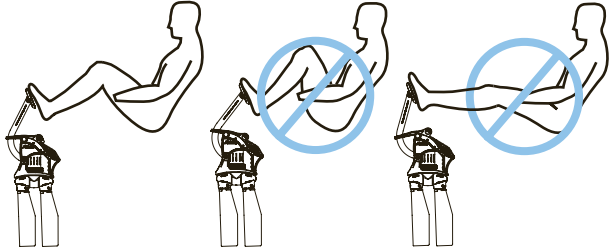

360 Steering

①

Turning the 360 handle rotates the lower unit of the drive.

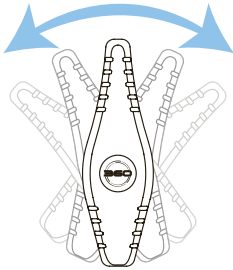

②

The indicator arrow on the drive shows you the orientation of the lower unit.

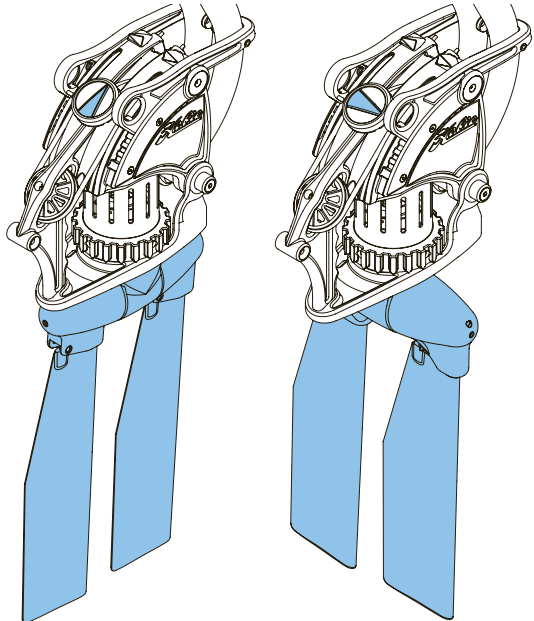

To lock drive in forward or back position, pull up on lock knob.

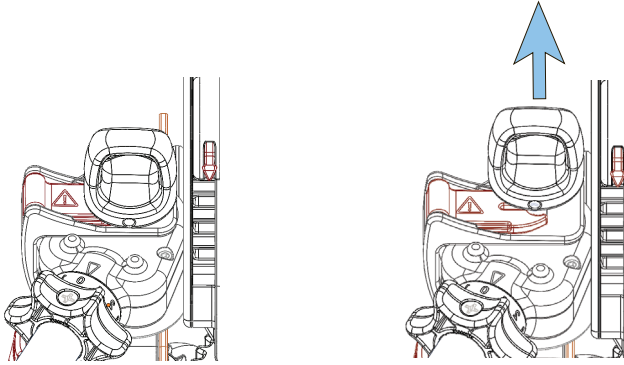

To decouple drive from steering system, slide the red release to the left and push lock knob all the way down. Drive can then be rotated by twisting lock knob.

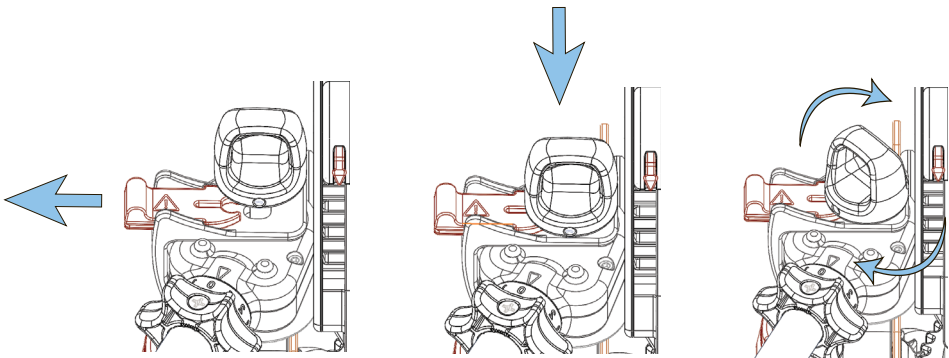

To tension steering belt, twist adjuster dial either direction, selecting 1 (lowest tension) through 5 (highest tension).

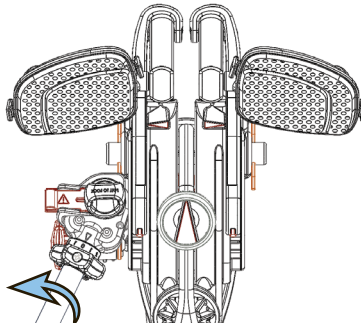

Shallow Water

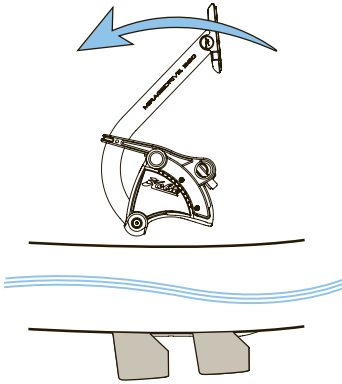

Press either pedal forward in shallow water to raise fins flat against the hull. Pressing one pedal fully forward will orient the fins with the kayak underside.

Kick Up Fins

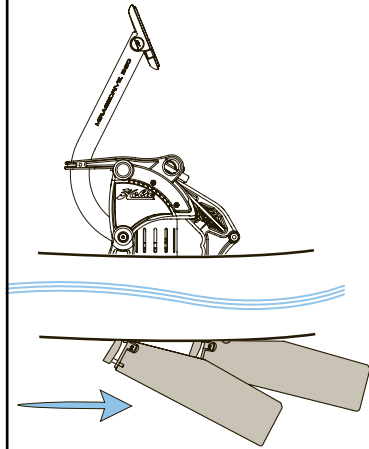

The fins will automatically kick up upon impacting with any object. They will automatically lock back into position when pedaling resumes.

Beaching

To avoid unnecessary sand intrusion, remove drive from boat before beaching.



Kick Up Fin Adjustment

If the fins do not stay locked into position and feel loose, you'll need to adjust the kick-up set screw.

①

The set screw is located in the housing at the base of the fin.

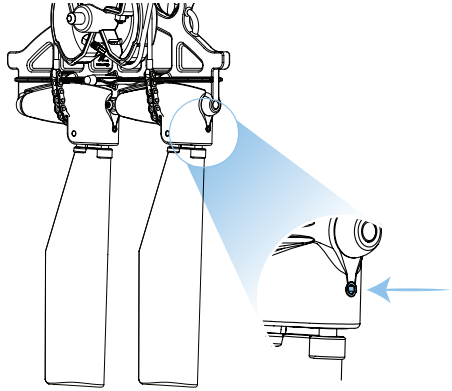

②

Make sure that the fin is completely engaged into the sprocket.

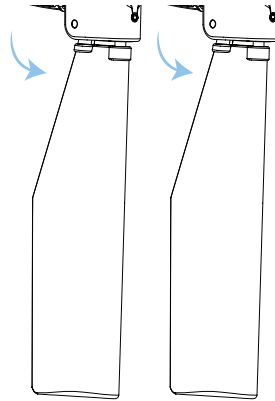

③

Tighten the screw (Phillips or Flat Head Screwdriver) 1/4 turn at a time until the set screw just touches the fin.

Test the fin by moving it in and out of the kick-up position to determine if it needs to be tightened or loosened.

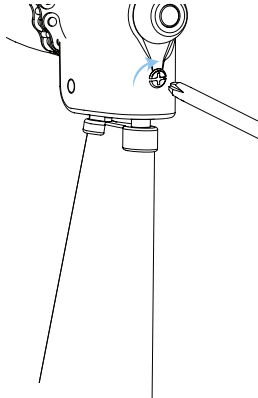

Installation

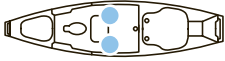

①

Lock chair feet to boat.

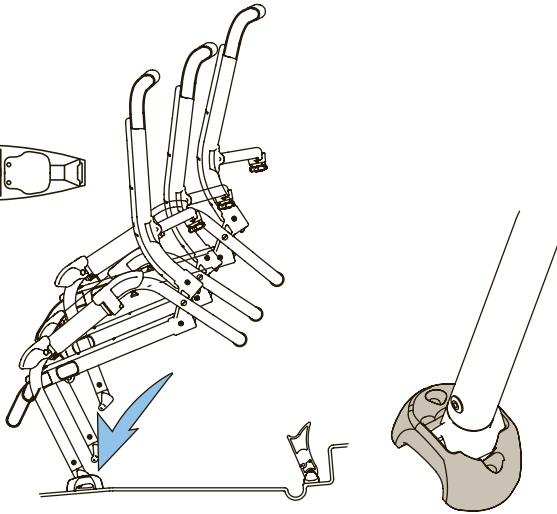

②

Pivot chair onto kick-stand.

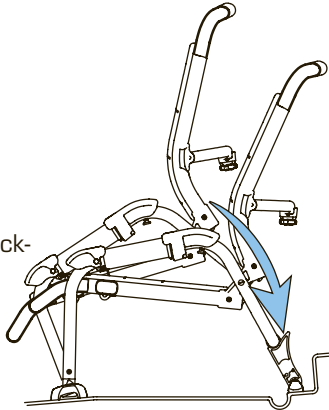

③

Place webbing strap over pin on the seat frame and hook clip. This will secure the seat in the event of a flip.



Attention!

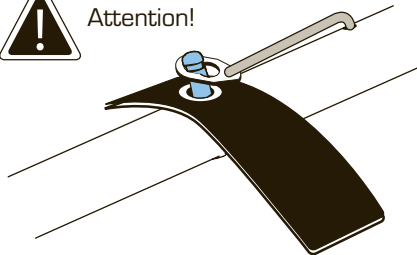

Lowering



①

Shift weight forward and tilt seat up.

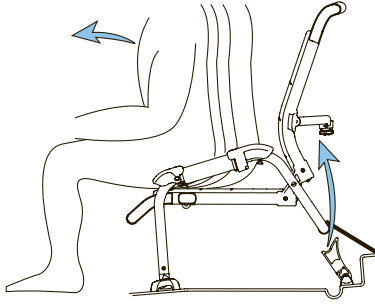

②

Pull and hold seat handle.

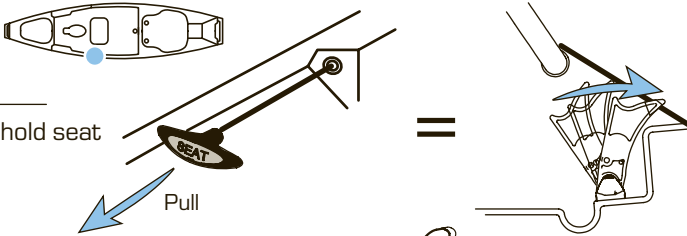

③

Lean back to lower seat.

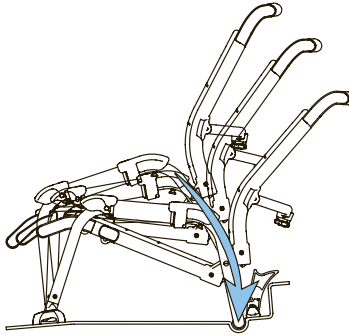

Raising

①

Shift weight forward and tilt seat up.

②

Lean back to lower seat onto kickstand.

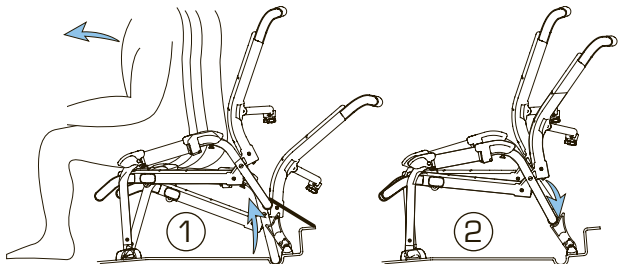

Back and Bottom Adjustment



1

Slide adjuster grip (on armrest) forward.

2

Rotate grips to adjust seat.

3

Make sure adjuster grip locks securely.

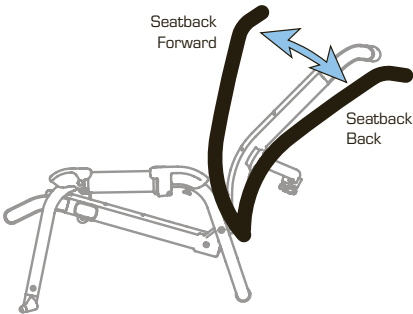
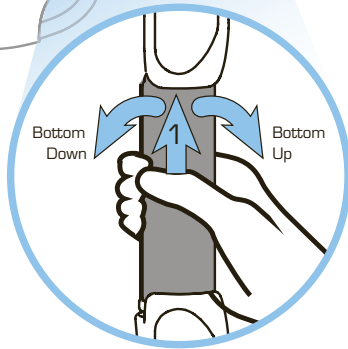
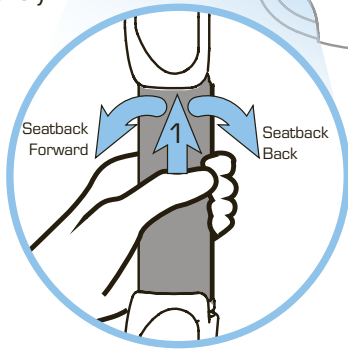
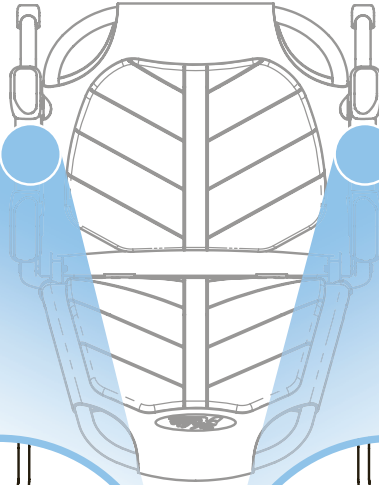

Lean forward to make seatback adjustment easier.

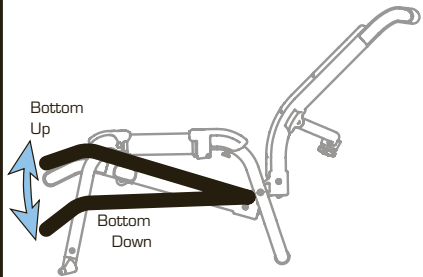

Ease weight off seat to make adjusting seat bottom easier.

Lumbar Adjustment

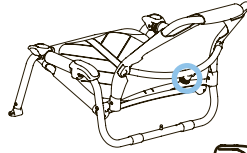

①

Pull knob to release lumbar.

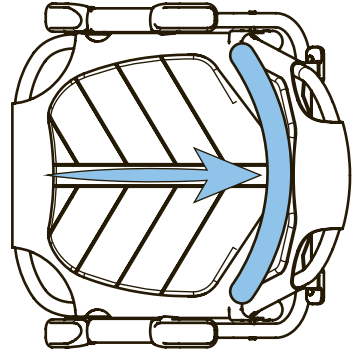
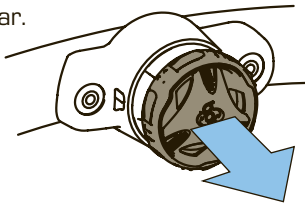

②

Press knob to lock lumbar.

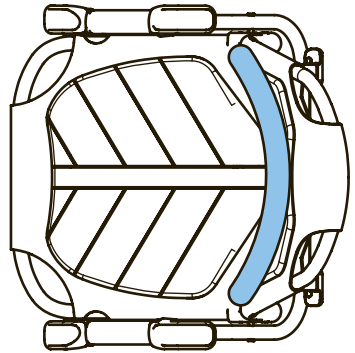
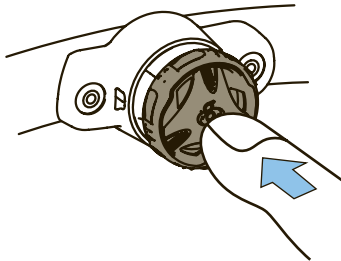

③

Rotate knob to tension lumbar.

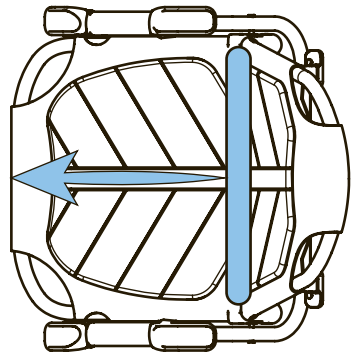
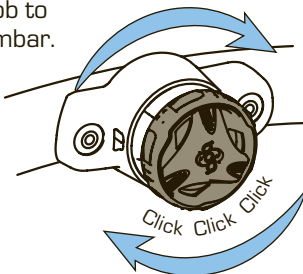

Rudder Down and Up

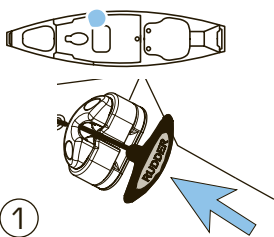

①

Uncleat and release.

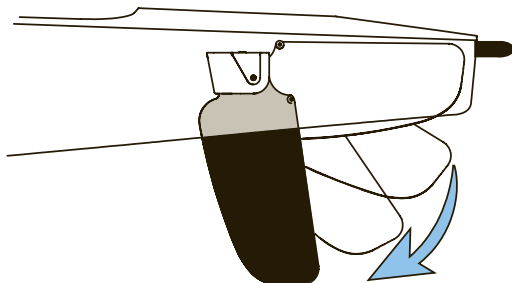

②

Pull and cleat.

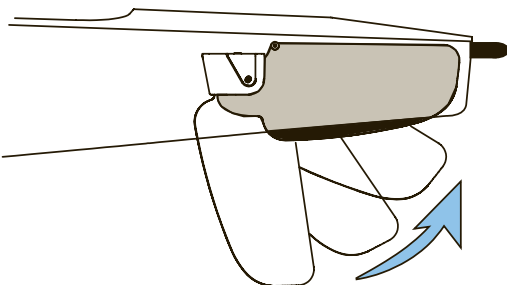
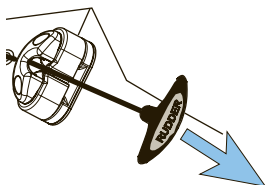

Skeg Operation

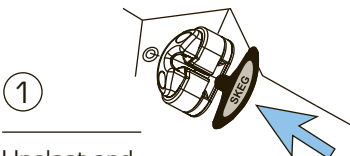

①

Uncleat and release the skeg line to lower the skeg and have the boat track straight.

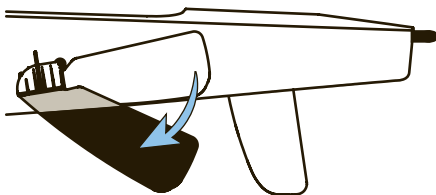

②

Pull and cleat the skeg line to have the boat be more maneuverable.

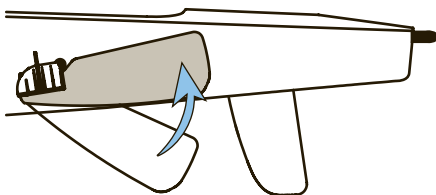
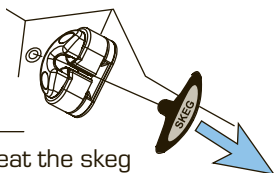

Rudder Line Tension



①

Pull knob to release rudder line.



②

Press knob to lock rudder line.

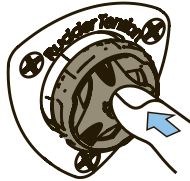

BOA® Rudder Line Tension Included on Pro Angler Mirage 360 models.

③

Rotate knob to tension rudder line.

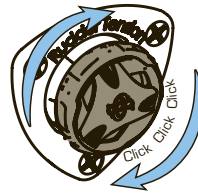

Underseat Strap

Use strap under seat to hold down optional tackle boxes.

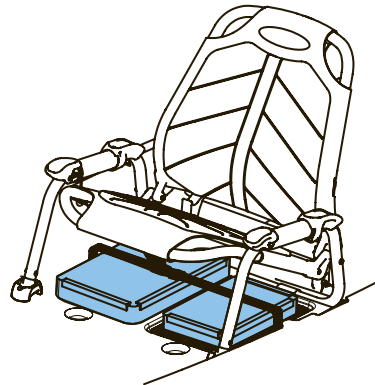

With the seat in the low position, use this same strap to hold down the seat during transport.

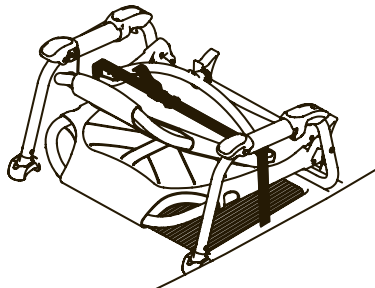

Transducer Installation



NOTE: Transducer installation parts are included with your kayak.

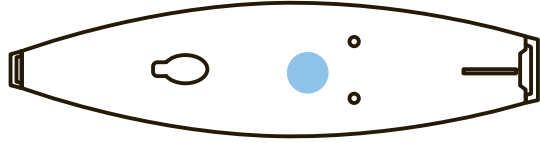

①

Remove the Hobie Guardian Shield from hull by unthreading the three screws fastening the shield to the kayak.

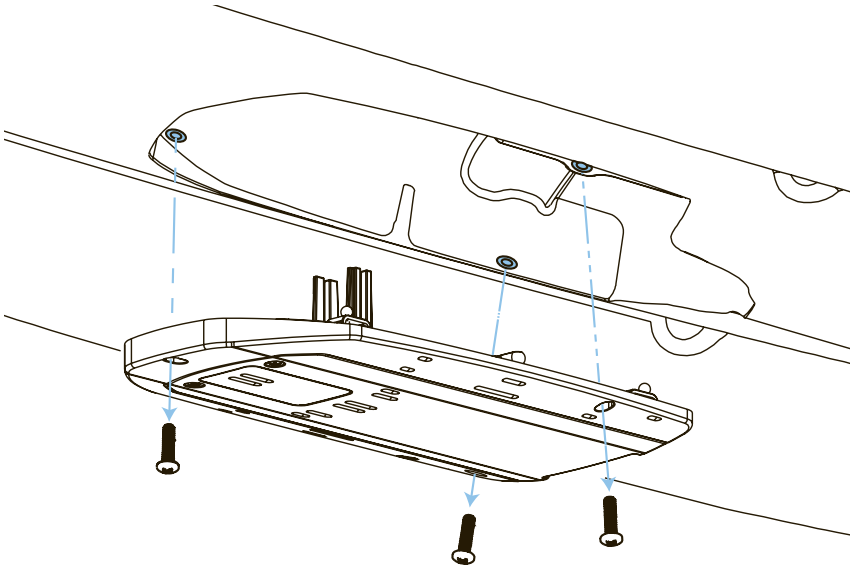

②

For Skimmer style transducer installation, skip forward to page 24. For side imaging transducer installation continue on to the next page.

Side Imaging Transducer Installation

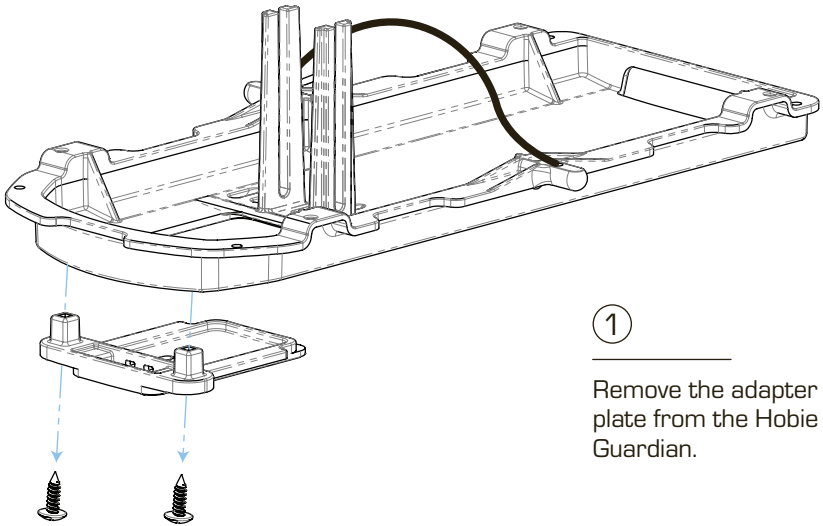

1

Remove the adapter plate from the Hobie Guardian.

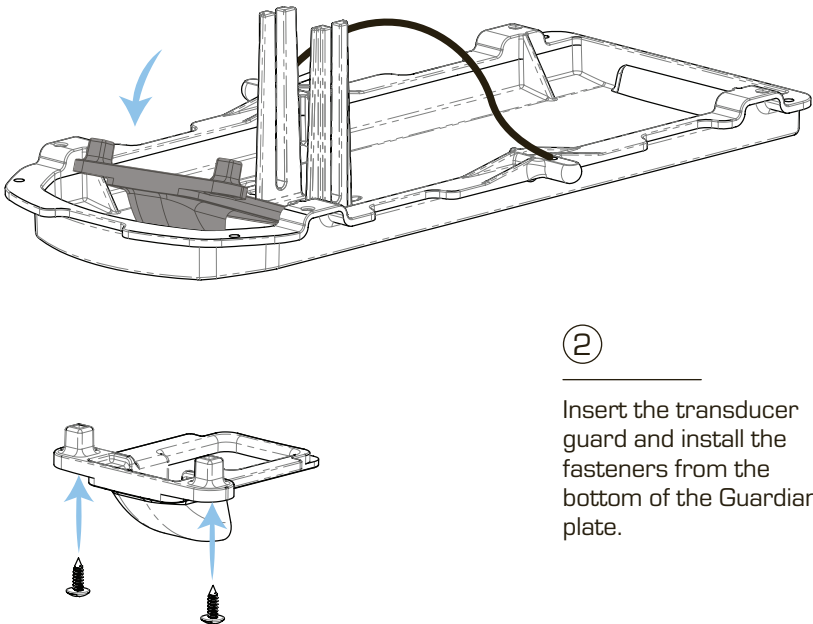

2

Insert the transducer guard and install the fasteners from the bottom of the Guardian plate.

③

For most side imaging transducers, we recommend using the mounting bracket included with your fish finder as a drill template for creating mounting holes in the Guardian plate.

④

Some side imaging transducers, like the Lowrance **TripleShot**, will mount through the bottom of the transducer guard and to the post on the inside of the Guardian plate. For these units, refer to the Skimmer Style Transducer Installation. If the transducer is not sitting flush with the shield, 2 small holes (one on each side of the transducer) can be drilled and a zip tie used to secure the transducer to the shield.

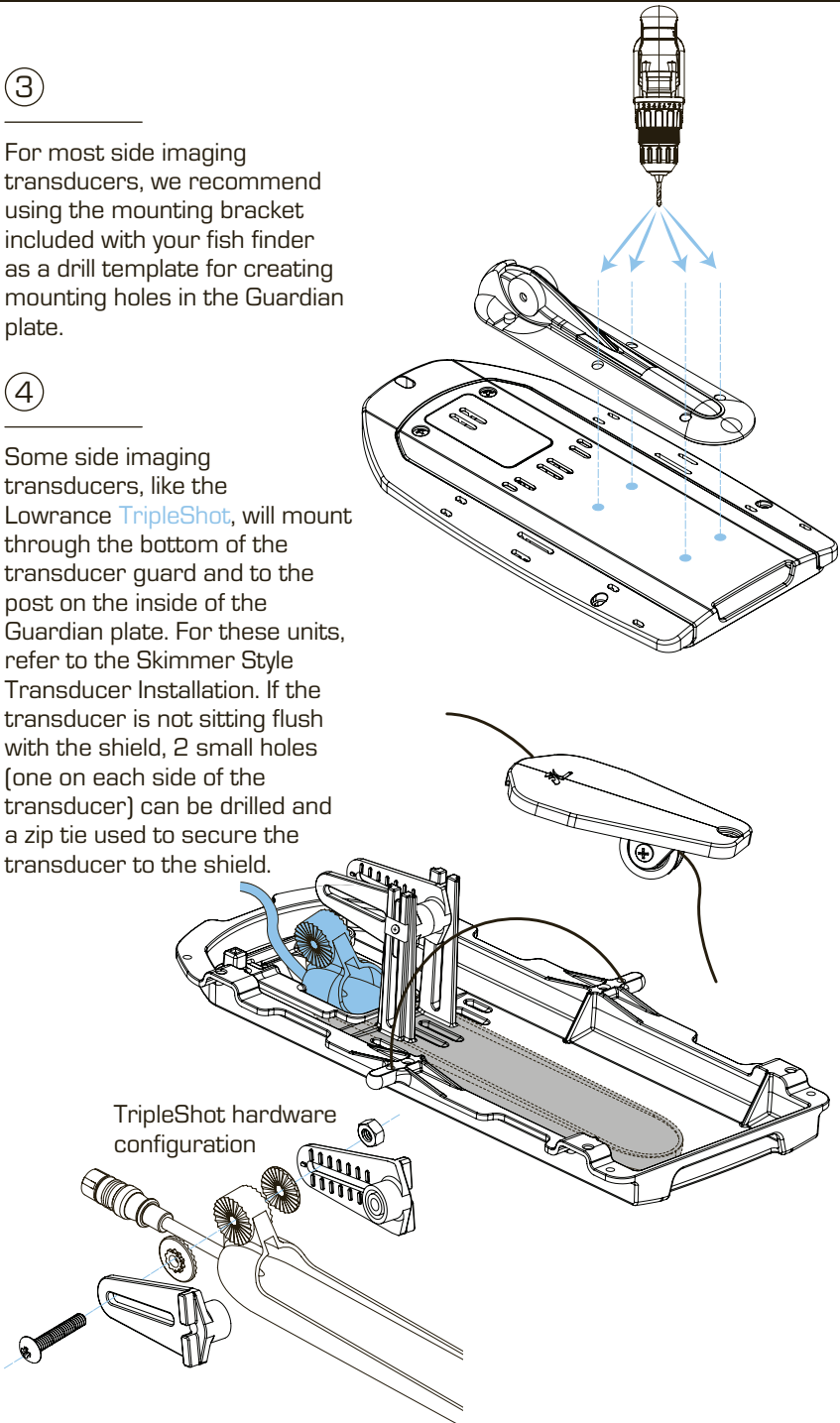

⑤

After mounting your side imaging transducer to the Guardian plate, you can choose to activate its retraction feature. Remove the screws holding the mounting plate to the Guardian frame.

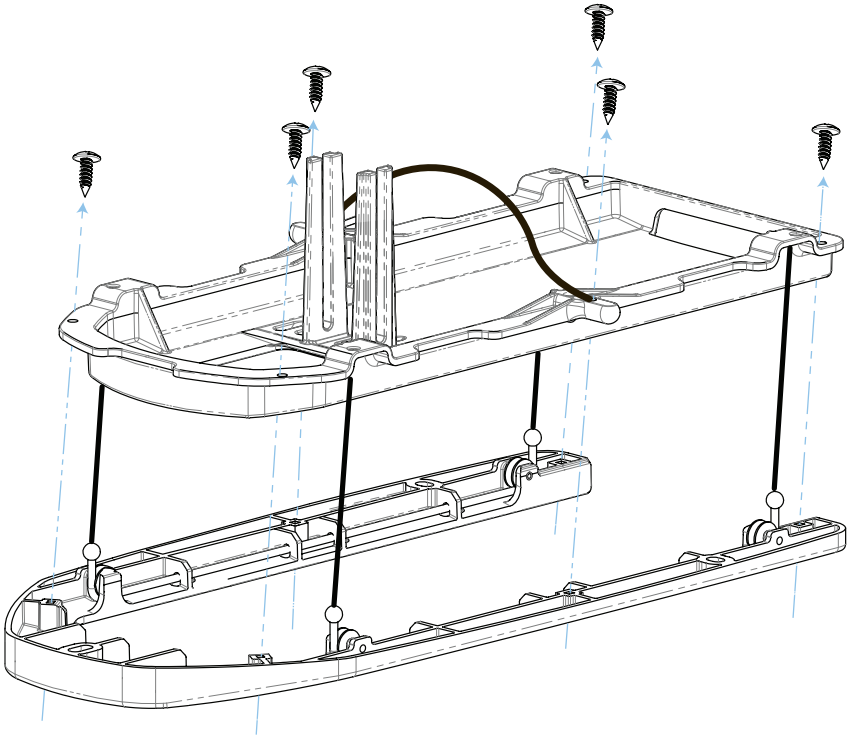

⑥

Attach the retraction line (tied to the cover plate) to the bridle line for up/down control.

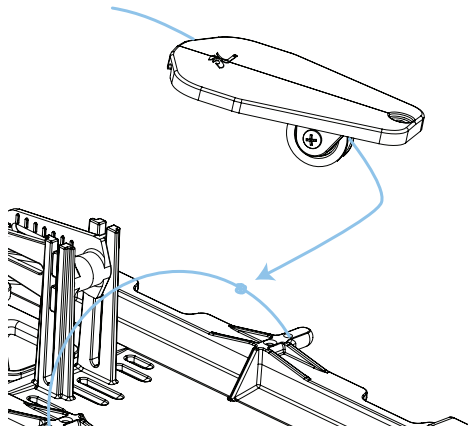

Skimmer Transducer Installation

①

Skimmer style transducers will mount to the posts inside the transducer cavity using the hardware that comes with the Kayak's Owners Manual.

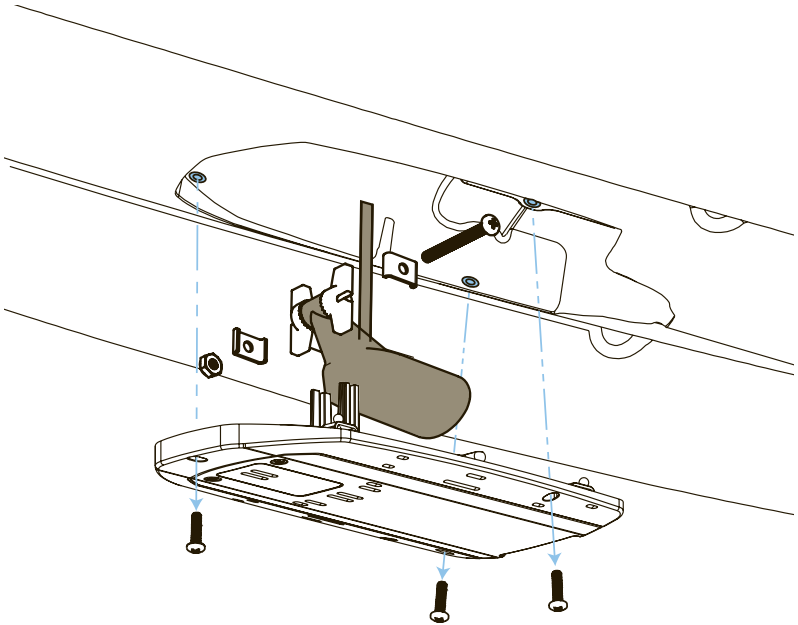

②

Leave a small gap between the bottom of the transducer and shield to allow water flow.

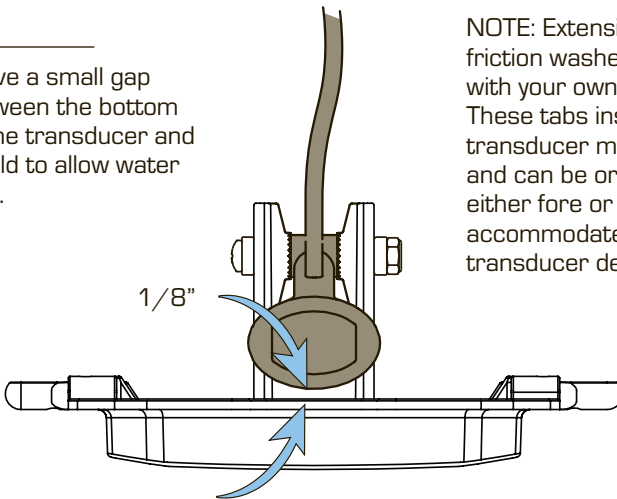

NOTE: Extension tabs and friction washers are included with your owner's manual. These tabs install to the transducer mounting post and can be oriented to face either fore or aft to accommodate a variety of transducer designs.

Run the Transducer Cable

①

Once the transducer is installed, feed the transducer cable through the scupper hole above the cavity and screw the plate back into place.

You should now have the transducer cable accessible in the cockpit of the kayak.

②

Remove the plug next to the scupper above the transducer cavity using a phillips head screwdriver. Feed the cable through the gasket and into the hull. Find the rubber adapter that matches the diameter of the transducer cable and fit it to the cable. Attach the adapter and cable to the plug and reinstall. Be careful not to overtighten and strip the screws.

TIP: Lubricate the cable with soapy water to allow it to slide through the rubber adapter more easily.

NOTE: Rubber adapters can be found in the kayak owner's manual.

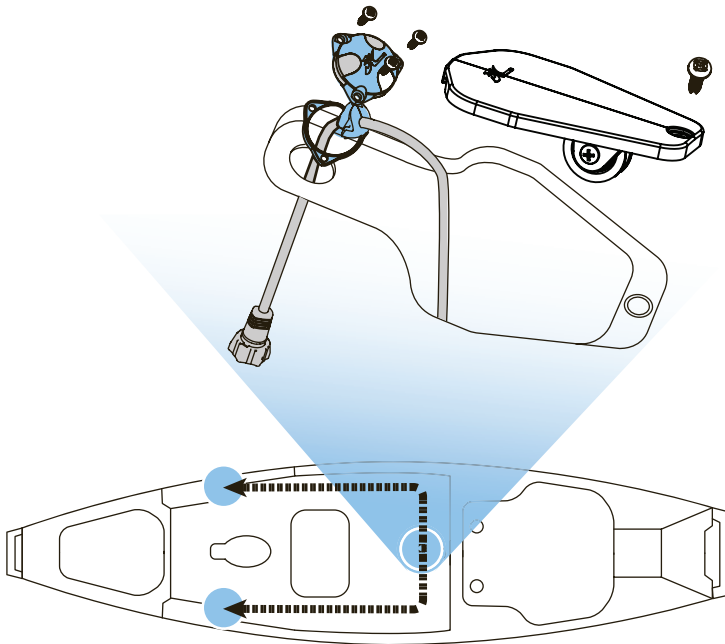

③

Remove the 3-way plug in the cockpit. Lead the cable through the inside of the kayak and exit the cable out through the hole for the 3-way plug in the cockpit.

There are plugs for the wire to exit the hull on either side of the kayak to accommodate a right or left sided screen location. Some plugs are located in cup holder or mesh pockets.

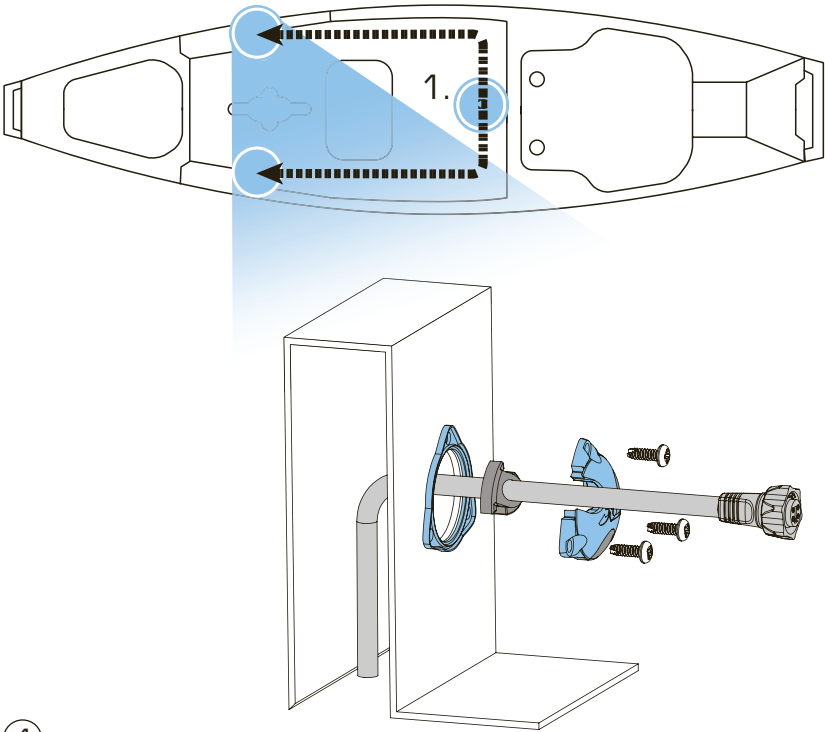

④

Using the same plug, install the power cable.

Thru-Hull Plugs Single and 3-way



①

Locate the thru-hull plug and unscrew the screws or nut on the inside of the boat.

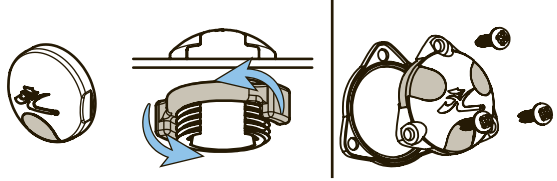

②

Remove the solid rubber plug.

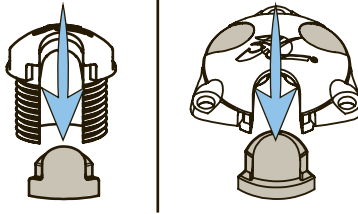

③

Choose the correct plug for your wire size and insert wire by opening the plug along the slit.

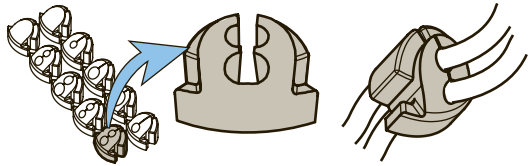

④

Press the new plug with the wire installed into plastic plug, making sure it fits properly.

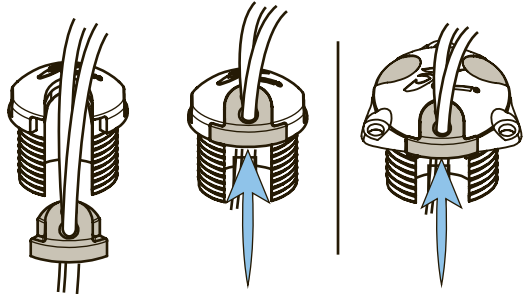

⑤

NOTE: DO NOT USE A DRILL Screw the 3 way plug to the hull by hand. Bolt or screw the thru-hull wire assembly to the hull using the nut or screws. Ensure the gasket is installed.

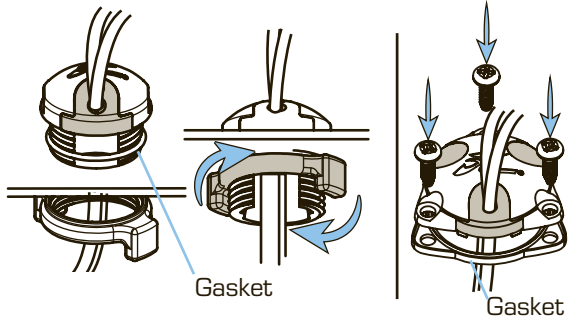

Clamping

①

Clamp accessory
around H-Rail Tube.

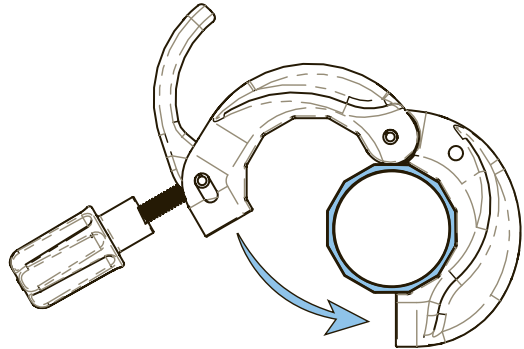

②

Lock tension knob.

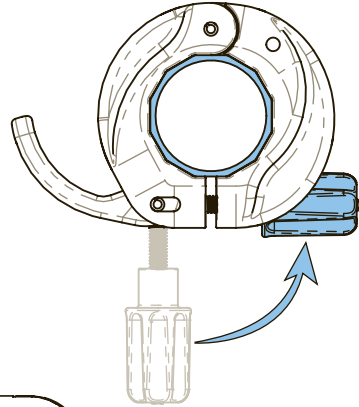

③

Tighten or loosen
knob per your
clamping
requirements.

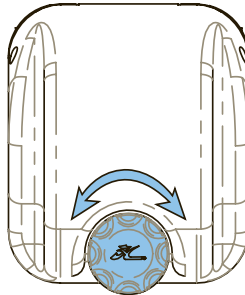

④

Close the lock
lever. If the lever
is difficult to close,
loosen the knob in
step 3.

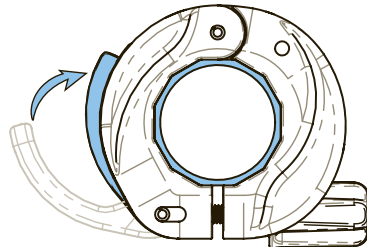

Adjusting Clamp Position

①

Unlock lever.

②

Slide to new position.

③

Adjust angle.

④

Lock lever.

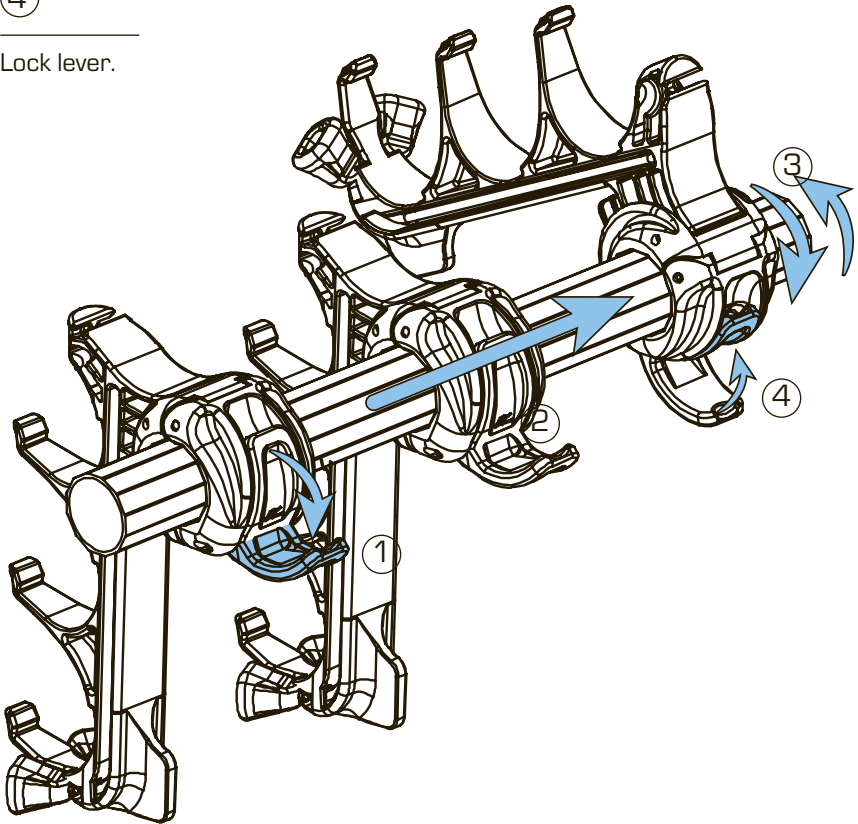

Rod Rack Retainer

During launch or transport, you may want to keep your rods held in place using the H-rail Rod Rack.

①

Lay your rods in the holders.

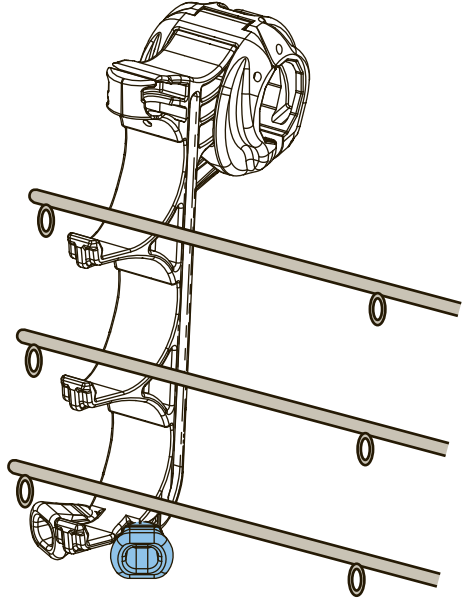

②

Stretch the bungee over the rods and hook at the top.

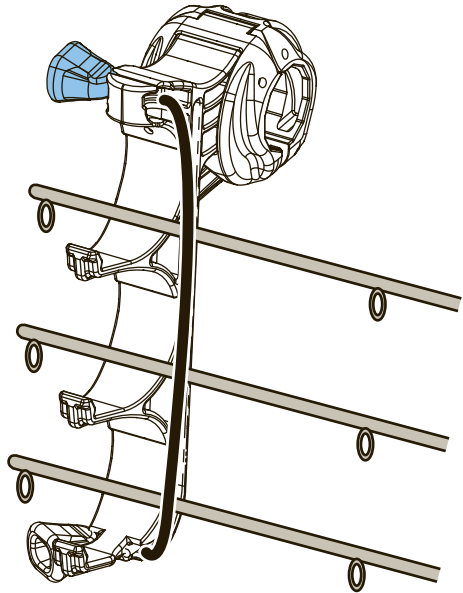

Additional Accessories (Not included with boat)

Review your parts and accessory catalog for all of the latest H-Rail mounting accessories or go to <http://www.hobie.com/catalogs-brochures/>

Universal Mounting Plate

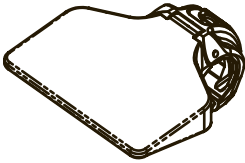

Rod Holder

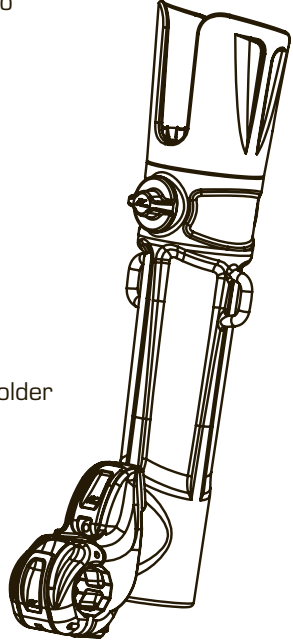

Ram® Ball Mount

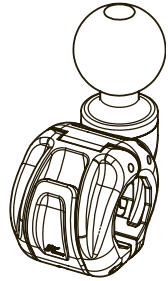

Tackle/Tool Box

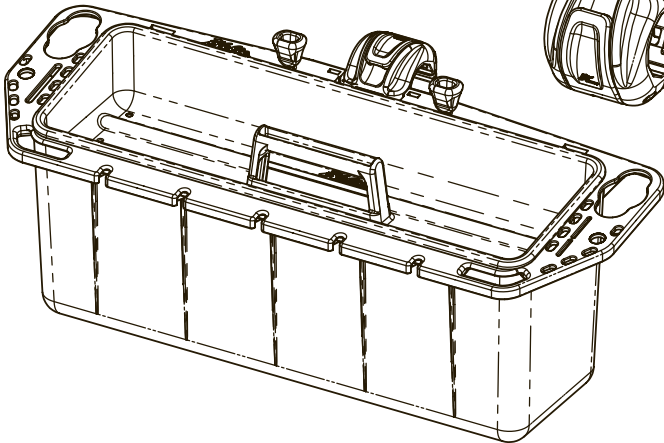

Storage Do's

Storing your boat upside down on crossbars, hanging from wide strapping, or on hull cradles are the best ways to keep the boat stored.

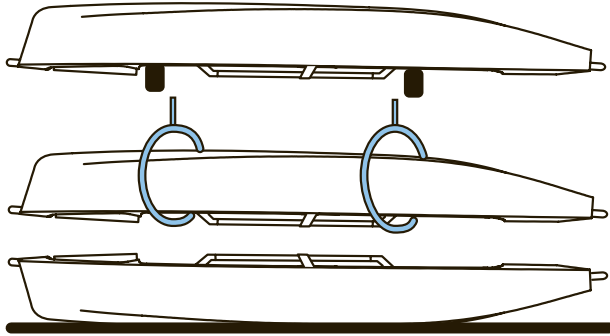

Storage Don'ts

Storing your boat cockpit side up on crossbars can dent the bottom.

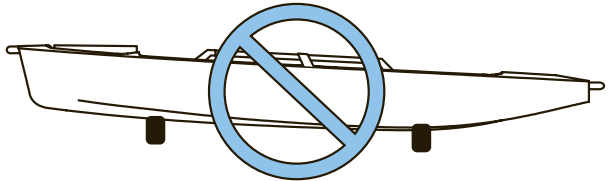

Storing your boat on its side over a long period of time can flatten/dent the sides.

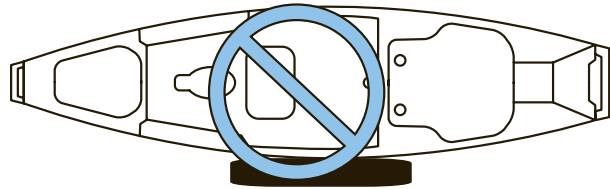

Hanging the boat by the scuppers can distort the scupper holes.

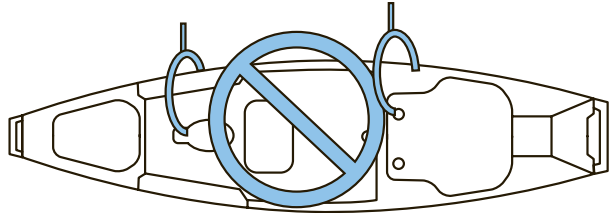

Never hang the boat by handles or pad eyes. They are not designed to handle long-term load and will fail.

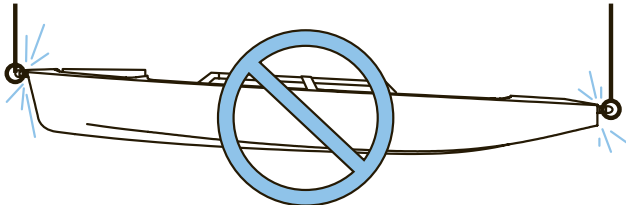

Never use PVC runners or tubes to store boat on.

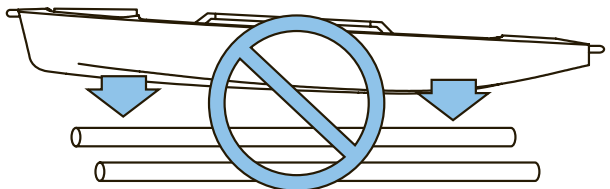

Additional Storage Key Points

Always open drain plugs and remove all water from boat

Don't leave tie-down straps tight over a long period of time

Storing in non-recommended configurations can result in hull damage

Never hang from handles or padeyes

Cart

The cart should be used for transportation purposes only and not as a storage platform. Do not leave your boat on the cart for more than one hour (less time in warmer temperatures or direct sunlight).

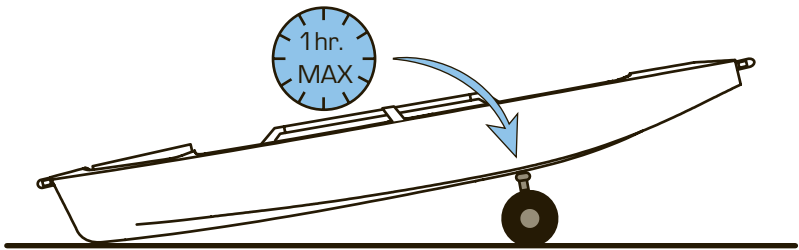

Store out of Weather

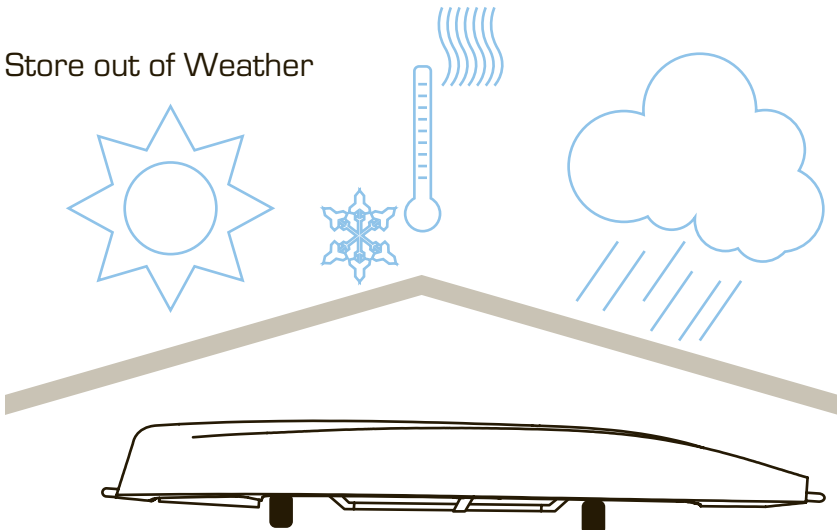

Check hobie.com for optional storage covers.

The best way to transport your boat is to purchase a trailer or roof rack from your dealer. Using proper cradles that support the hull, the boat can be transported right side up. Straps can then be laid across the boat and tied to the bars. Straps should be tight, but not so tight that they distort the shape of the boat. Avoid using ratchet straps to prevent overtightening.



Be sure to first consult your car and roof rack owner's manual to ensure that you comply with all of their recommendations, precautions and specifications.

Running a line or strap from the bow and stern of the boat to each bumper is required. If your bumpers do not have a gap to pass a rope around, look underneath. There should be a loop of metal, which is used by car transports such as tow trucks.

Many people like to use the scupper holes to tie the boat to the car. This helps prevent the boat from sliding back and forth or the tie-down rope from slipping off the boat. (This is an acceptable method for tying the boat down for transport.)

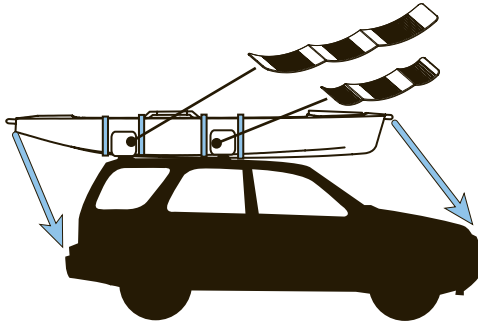

Pro Angler Roof Topping Technique

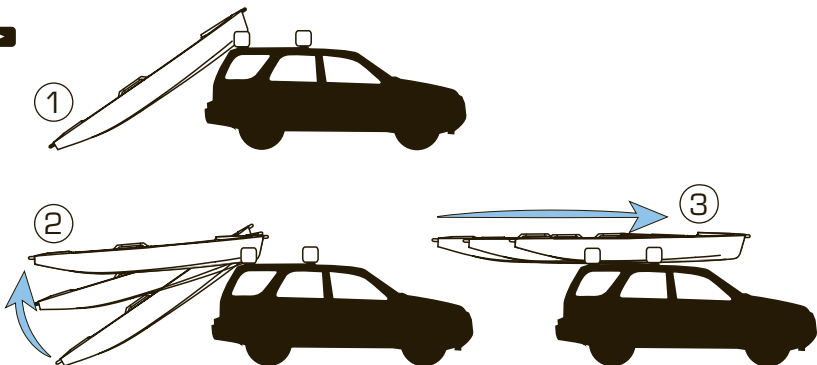

MirageDrive Regular Maintenance

The 360 drive has an open bearing design to allow sand and debris to flush through the drive. If there is sand in the drive unit, before leaving the water, dunk the drive while working the pedals back and forth to clear sand.

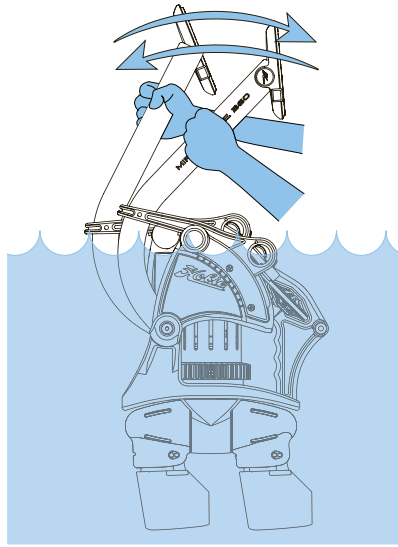

Checking Cable Tension

①

To check cable tension, insert 5/32" hex key into hole on bottom of lower unit. Turn clockwise by hand until it is tight.

②

If the drive is full of sand, loosen the cable tension with global adjustment screw, flush out with water, and re-tension.

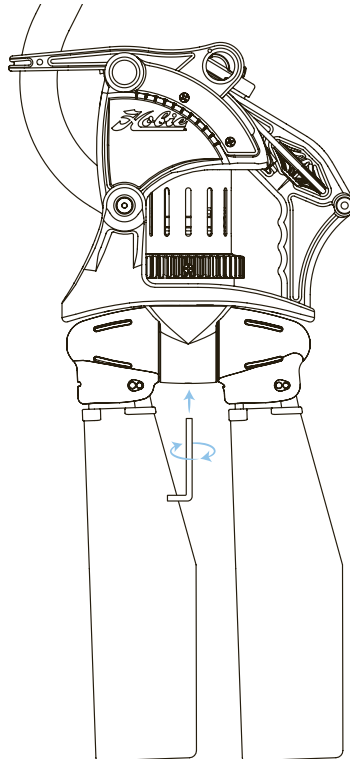

Rudder Tuning

①

Pull up rudder.

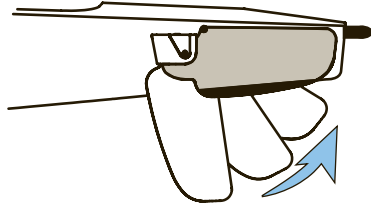

②

Remove rudder cover.

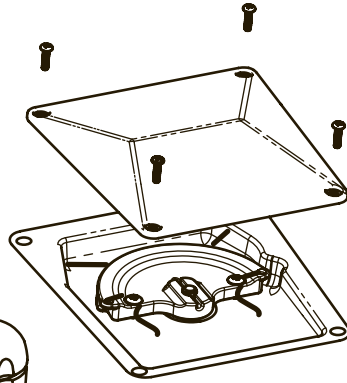

③

Loosen screw clamping the rudder line.

④

Pull the slack out of the rudder line making sure the steering handles are still straight. If they are not straight, adjust the lines accordingly.

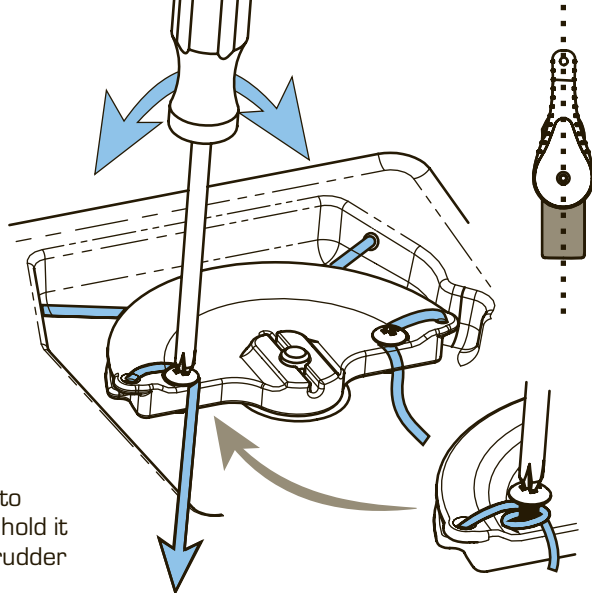

⑤

Tighten the screw to clamp the line and hold it in place. Replace rudder cover.

Checklist

Please read through the owner's information package prior to using this product.

The user of this product acknowledges both an understanding and assumption of risk involved in paddle/pedal sports. Consult your physician about physical activity.

Always:

Wear a Coast Guard approved personal flotation device.

Always file a float plan: Let someone know where you are going and when you will return.

Dress appropriately for weather conditions; cold water and/or weather can result in hypothermia; apply sunscreen and other sun protective clothing.

Check your equipment prior to each use for signs of wear or failure.

Tie a leash to your paddle and MirageDrive.

Scout unfamiliar waters prior to launching.

Be aware of river water levels, tidal changes, wind conditions, obstacles in and above the water and weather changes.

Always make sure your hatches are secure.

Carry a pump and/or bailing device.

Always carry the paddle provided with the boat.

Never:

Never go in flooded and/or fast moving water conditions. Hobie kayaks are not designed for fast moving water.

Never exceed your ability and be aware of your limitations.

Never use alcohol or mind-altering drugs prior to or while using this product.

Never open your hatches in unstable water conditions.

Never remove the foam pieces inside the hull. They are installed for structure, additional flotation and safety reasons.

Shakedown Cruise

As with any new product, it is important that you become familiar with the boat and all its features. Before long trips, it is important to determine that the boat is sound. We recommend that you do what we call a “shakedown cruise” when the boat is new, after shipping or transport, before long trips and after installing any thru-hull fittings. This test is typically done in shallow, calm conditions where you can familiarize yourself with or test the boat before taking long trips into open water. Things you should check or practice are:

- MirageDrive installation, adjustment and removal
- Rudder Operation
- Getting in and out of the boat from a capsized state
- Drain plug locations to make sure they are properly installed
- Closing hatches properly
- Taking the kayak sail down while on the water (if applicable)

Getting into your Boat

Falling out of your boat is something that rarely happens, but it is important to practice and prepare for this type of situation. We recommend that you try climbing into your boat in a pool or shallow water to improve your technique. We recommend that you enter your boat from the side or back of the boat depending on conditions.

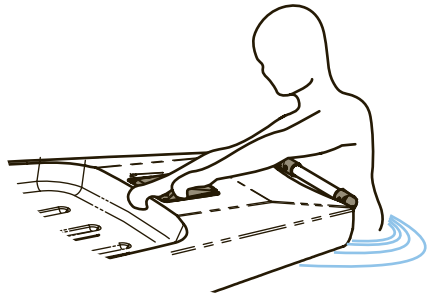

Mirage Cassette Plug

Your Hobie is shipped with a Mirage Cassette Plug. The plug is provided as standard equipment in the Mirage Kayak package. Insert the plug into the Mirage well when the MirageDrive is removed to provide added safety and to “fair” the bottom of the hull when paddling.



Kayak Sail Safety

The kayak sail is a very popular optional accessory that works quite well with Hobie Mirage Kayaks. It is important to familiarize yourself with the use of the sail and how wind power affects the stability of the boat. The sail is not recommended for use in wind conditions over 10 MPH/8.7 knots unless you are using the furling kit or stabilizing amas available through the Hobie Parts and Accessories Catalog.

It is very important that you complete and send us your Warranty Registration Card as soon as possible.

This information enables Hobie Cat Company to contact you should there be important product information that needs to be shared with you in a timely manner. Please complete the Warranty Registration Card in your Owner's Packet, or take advantage of our online option at:

<http://www.hobie.com/product-registration>

or

Scan this QR code with your smart phone



If you have a question or issue with your Hobie product, please see your Authorized Hobie Kayak Dealer. They will assess the problem, assist with a repair and file a warranty claim with Hobie Cat Company if needed. All warranty claims must go through your Authorized Hobie Kayak Dealer. The Warranty Registration Card and Warranty Policies are included with each model in the Owner's Packet. Type in the address below to go to our dealer finder webpage.

All specs, colors, graphics and features are subject to change without notice. Please refer to the website for complete details.

<http://www.hobie.com/dealers>

Warranty does not cover normal wear and tear, improper storage or running into objects. The warranty covers defects in the materials, manufacturing and design.

Hobie Soft Cooler/Fish Bag**Tie Down Straps****Lowrance Fishfinder****Hobie Polarized Sunglasses****Hobie Multi-Lube****Power-Pole Mirco****Kayak Trailer****Inflatable PFD**

For more accessories see:
<http://www.hobie.com/catalogs-brochures/>

Livewell XL



Kayak Cover



Hobie H-bar



H-Crate

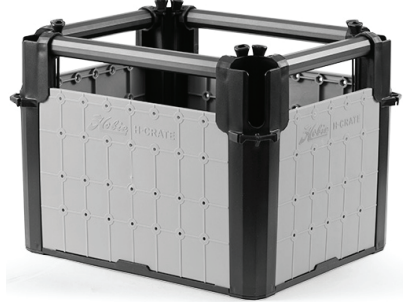

Anchor Trolley Kit



Hobie Vantage Seat bag



Rod Holder Extension



Heavy Duty Plug-In Cart



Enjoy the Ride!

NOTES



Corporate Headquarters
Oceanside, CA USA

www.hobie.com

PN 27700131
REV 211103