

Hobie

KAYAK AND ECLIPSE PARTS & ACCESSORIES



THROUGH MARCH 2020



SCAN TO GO TO
HOBIE SUPPORT PAGES



SCAN TO GO TO
HOBIE PARTS LOOKUP

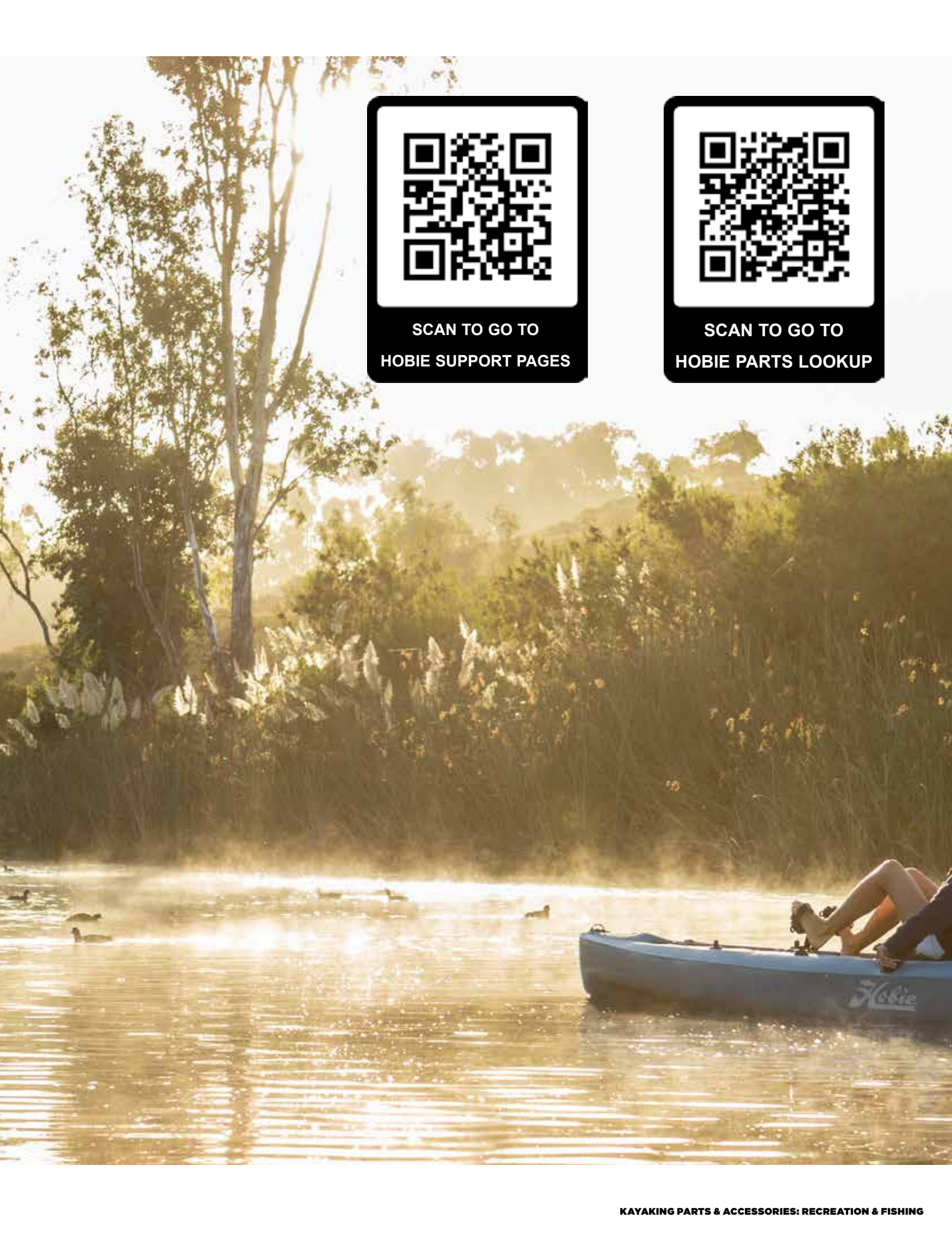



CONTENTS

ITEM	PAGE
LIFE VESTS / PFD	2-3
MIRAGEDRIVE® ACCESSORIES	4-5
SAIL KITS / GLOVES	6-7
BIMINI / SIDEKICK / DODGERS / MISC	8-9
ISLAND SPINNAKER / TRAMPOLINES	10-11
HATCH LINERS / HATCHES / BAGS	12-13
KAYAK CARTS	14-15
KAYAK DOLLIES / TRAILERS	16-17
RACK PADS / STRAPS	18
LOAD ACCESSORIES	19
COVERS / BAGS / ACCESSORIES	20-21
EVOLVE / TROLLING MOTORS	22-23
LIVEWELLS	24-25
H-BAR / H-CRATE / H-RAIL KITS	26-27
H-RAIL ACCESSORIES & HOBIE ROD HOLDERS	28-29
RAM ROD HOLDERS / MOUNTS	30-31
RAILBLAZA MOUNTS / ACCESSORIES	32-33
SCOTTY ROD HOLDERS / MOUNTS / HUNTING	34-35
STAKE OUT POLE / DRIFT CHUTE / ANCHOR KIT	36
POWER-POLE	37
FISHFINDERS / MOUNTS / INSTALL KITS	38-39
ACCESSORIES / DECK PAD KITS	40-41
ECLIPSE ACCESSORIES / SUP PADDLES	42-43
SAFETY / ACCESSORIES / PET PFD	44-45
MAINTENANCE / MISC ACCESSORIES	46-47
HARDWARE / LINE / TOOLS	48-49
HOBIE SUNGLASSES / APPAREL HOBIE.COM	50-53

Note: Freight to dealers is not included in pricing.
 No portion of this catalog may be reproduced without the express permission of the Hobie Cat Company.
 All rights reserved. ©2019 Hobie Cat Company. Oceanside, CA 92056
 Pricing subject to change. Printed in USA

LIFE VESTS & PFDs



S6103xx (xx = size)
MEN'S SUN

HOBIE THIN-BACK by Stohlquist

Features a thin foam back design ... perfect for use with Hobie Vantage seats. This thinner back profile provides more mobility and comfort, while reducing interference with taller seat backs.

THIN-BACK S6103-6

THIN-BACK FISH S6107

FEATURES:

Thin back design works with all seat styles; Graded Sizing provides the best possible fit; Open sides for ventilation; Cross-chest cinch harness for zero ride-up; Mesh shoulders & interior panels for maximum ventilation; Adjustable shoulders, and dual forward pulls for a custom fit; Zippered front pockets offer organization; Built-in beverage holder and neoprene sunglasses sleeve; Entry grip tab at zipper base; #10 YKK zipper with non-corroding slider; Lightweight PE Foam; Type III PFD with sea level buoyancy: SM: 16 lbs, 8oz / LXL: 17 lbs / XXL: 17 lbs, 8oz

CONSTRUCTION:

- Mini Ripstop nylon outer shell
- 200 denier oxford liner
- USCG approved

SIZING:

MEN'S

SIZE	CHEST
SM	30" - 40"
LXL	40" - 46"
XXL	46" - 52"

WOMEN'S

SIZE	CHEST
XSS	28" - 34"
ML	34" - 40"
PL	40" - 46"



S6104xx (xx = size)
MEN'S SLATE



S6107xx (xx = size)
MEN'S FISH SLATE GREEN



S6105xx (xx = size)
WOMEN'S SUN



S6106xx (xx = size)
WOMEN'S SLATE

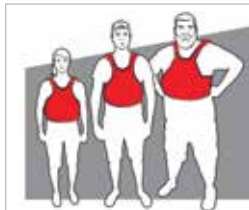

GRADED PFD SIZING

Fine tuned for each individual size, and sculpted foam footprint and foam thickness to provide a better fitting, and more comfortable PFD for people of all sizes.



HOBIE MIRAGE PFD

This PFD was designed for Vantage high back seats on Hobie Mirage Kayaks. The flotation in the back is thin for more comfort while seated and helps to prevent the vest from riding up as you pedal. A vent along the spine adds to the comfort. Front zip entry for easy on and off. Large pockets on the front for easy storage and access of small items. High waistline cut so the vest does not ride-up while pedaling. Huge arm cutouts and the short waist allow excellent freedom of movement. Adjustable side straps offer enough size variation for many layers underneath or none! Reflective tapes for visibility during low light conditions. Back logos vary between "H" and Penguin Logo. (xxx = SMD - MLG - LXL) (UL - Approved) for use in USA Only
S6800xxx PFD MIRAGE GRAY

SIZING

SIZE	CHEST
SM	33" - 39"
LXL	40" - 46"
XXL	48" - 54"



HOBIE EDGE by Stohlquist

An innovative, high mobility, low profile boating vest for kayaking, SUP, and wetsailing.

S6108xxx (xxx = size)

FEATURES:

Ergonomic WRAPTURE™ shaped torso; Adjustable shoulders, 4 side pulls, and front waist buckle closure; Low cut, offset front-zip entry; Large arm openings for unrestricted whitewater and SUP paddling; Contoured padded shoulder straps; High visibility 3M™ reflective accents; Roomy, top loading front pocket for secure storage and easy accessibility; Mesh sides for maximum ventilation; Mini-Ripstop nylon shell & 200 denier oxford liner; Type III PFD with sea level buoyancy listed: SM: 15 lbs, 8oz / LXL: 16 lbs, 8oz / XXL: 17 lbs, 8oz

CONSTRUCTION:

- Mini Ripstop nylon outer shell
- 200 denier oxford liner
- USCG approved

! SAFETY TIP

LIFE VESTS: Get a good, comfortable life vest and WEAR IT! A life vest does you little good stored on your boat, especially if you get tossed into the water and away from your boat. Accidents happen and by their nature, they happen when you are not prepared. A life vest can keep you afloat until you can rescue yourself or you can be rescued by others. In the worst cases when injuries or cold water are involved, your life vest can make all the difference! Be sure everyone onboard your boat wears a life vest too! Pass the word! Federal law now requires that all persons below the age of 13 must wear a life jacket while aboard a boat.



HOBIE INFLATABLE PFDs

Light weight and comfortable. Ready when you need it, manual CO2 inflation or by mouth inflator allows for swimming, wading and intentional immersion. **NOTE: AIR SHIPPING RESTRICTIONS CO2 / DANGEROUS GOODS**

Coast Guard Approved Type III Nearly twice the buoyancy of USCG foam PFD Shortened slim fit shell for improved comfort when pedaling a Mirage kayak Mesh Yoke Back Strap for breathability and preventing ride-up Large Easy Access Storage pocket for increased storage capacity Inflates manually for flotation only when it's desired D-ring for accessory attachment Accessory attachment straps Interior pocket for holding spare CO2 inflation cylinder Fits 30-52" chests and users 16+ years Included 24g CO2 cylinder provides 26 lbs. of flotation

- S6782BL** PFD INFLATABLE BLUE - 24g
- S6782GR** PFD INFLATABLE GREEN - 24g
- S6782RD** PFD INFLATABLE RED - 24g
- S6782TN** PFD INFLATABLE TAN - 24g
- S6779R** PFD INFLATABLE REARM KIT 24g



HOBIE INFLATABLE BELT PACK PFDs

Belt carried PFD designs are cooler and more comfortable than typical PFDs. Functional design for multiple types of water sports from fishing, kayaking, sailing to stand up paddling (SUP). USCG Approved Type III PFD, approved for use by persons 80 lbs and 16 years of age or older. Size: Universal Adult Size. Durable ripstop nylon pack. 2" wide, adjustable, nylon waist belt. Includes (1) CO2 Cylinder and instructions.

16g offers Buoyancy 16.5 Pounds. Slim fit. **NOTE: AIR SHIPPING RESTRICTIONS CO2 / DANGEROUS GOODS**

- S6783BL** PFD BELT PACK BLUE 16g
- S6783YL** PFD BELT PACK YELLOW 16g
- S6780R** PFD INFLATABLE REARM KIT 16g

HOBIE INFANT/CHILD/YOUTH VESTS

These are easy to adjust for different small sized crews.

- (Lime Green)
- S6771CLG** LIME 30-50#
- S6771ILG** LIME <30#

- S6771YLG** LIME 50-90#



MIRAGEDRIVE



Hobie
MirageDrive 180

HOBIE MIRAGEDRIVE *Note: "ST" = SQUARE TOP*

- 81189001** MIRAGEDRIVE 180 SQ CRANK - ST FINS
81189101 MIRAGEDRIVE 180i SQ CRANK - ST FINS iSeries
81188001 MIRAGEDRIVE 180 SQ CRANK - ST TURBO FINS

- 81183** MIRAGEDRIVE 180 ARC CRANK - ST FINS
81185 MIRAGEDRIVE 180i ARC CRANK - ST FINS iSeries
81184 MIRAGEDRIVE 180 ARC CRANK - ST TURBO FINS

- 80010501** MIRAGE DRIVE GT - ST FINS
80013501 MIRAGE DRIVE GTi - ST FINS iSeries
80012501 MIRAGE DRIVE GTT - ST TURBO FINS

PERFORMANCE FINS - ST TURBO!

Increase your performance or increase your fitness routine, you choose the fin that is right for you: Standard or Turbo... low or a higher gear! This is very evident when using a sailing kit. The added power and speed of the sail often outpaces the standard fins (similar to pedaling a bike down hill in first gear).

Want to go really fast? Add TURBOs. Hobie Mirage kayak users report as much as 10% increase in speed and more using TURBO Fins. But its not all about speed, you can get top end speed and a slower cadence for cruising (Less pedals per mile). All achieved with these larger and more efficient fin designs. These longer fins can also increase lateral resistance for sailing upwind.

ST TURBO FIN KITS

Kits come with 2 fins & 2 longer masts

- 72067032** MD180 ST TURBO FIN KIT **NEW!! KU VERSION** - GRY/BLK
 (Only for MD180 KU DRIVE)

- 72067002** MD180 ST TURBO FIN KIT V2/GT - GRY/BLK

- 72066001** ST TURBO FIN KIT V2/GT - GRY/BLK (Threaded Sprocket)
72066021 ST TURBO FIN KIT V2/GT - RED/BLK (Threaded Sprocket)
72066031 ST TURBO FIN KIT V2/GT - BLU/BLK (Threaded Sprocket)

- 72065** ST TURBO Fin Kit (Older SS & Set-screw Sprocket)



ST TURBO
V2/GT RED FIN KIT

MD180 ST TURBO FIN KIT
72067002

MIRAGEDRIVE SPARE PARTS KITS GT & MD180

Spare parts kits include a fin, mast, sprocket (For GT Version), chain and appropriate parts for the drive version. Threaded sprockets and masts. All in a handy zippered pouch. Available for ST or ST Turbo fin drives.

80010401 GT ST BLUE FIN PARTS KIT

80013401 GT TURBO BLUE FIN PARTS KIT

81527021 MD180 ST PARTS KIT

81527022 MD180 ST TURBO PARTS KIT



80010401 SHOWN



LEASH KIT - MIRAGEDRIVE

Protect your investment from an accidental drop overboard. Includes hardware for attachment to the hull.

74052101 LEASH KIT - MIRAGEDRIVE



HOBIE MULTI-LUBE

A planet-safe lubricant recommended for lubricating MirageDrives and many other uses. Environmentally friendly for in-the-water applications. Hobie Multi-Lube offers excellent lubrication, is an anti corrosive coating, great for cleaning and many other uses... use on nearly anything that squeaks, rusts, corrodes or binds up; MirageDrives, rudder drums, cams, fishing reels and more. The 1 oz size is perfect for getting the lubricant into tight spaces by using the needle applicator. The 4 oz size has a spray applicator for coating chains and larger surfaces, shafts and bulky parts. Every Hobie owner should have Hobie Multi-Lube. Be nice to our planet, keep MirageDrives and other components running smoothly and lasting longer without polluting our waterways. Use it for all shop, home and sport lubrication needs.



5120 HOBIE MULTI LUBE 1 OZ

5121 HOBIE MULTI LUBE 4 OZ



PEDAL PAD KIT

Softer on your feet! Neoprene pads are self adhesive and stick right to your pedals. Stock on Drives built in 2010+

72020034 PEDAL PAD KIT BLACK (PAIR)



DRIVE WELL SEAL

For older version MirageDrives (pre-2013). Keeps the seat area drier. Kit includes one seal and two attachment "zip ties".

81037001 WELL SEAL

81038001 i - WELL SEAL



SCAN TO GO TO
HOBIE SUPPORT PAGES



SCAN TO GO TO
HOBIE PARTS LOOKUP

MIRAGE SAIL KIT

ADD SAILING TO YOUR HOBIE
MIRAGE KAYAK EXPERIENCE!



MIRAGE KAYAK SAIL KIT

Add sail power to Hobie Mirage Kayaks! (Fits all current models of Hobie Mirage Kayaks). Sail with ease maintaining excellent speed with or without pedaling while sailing. Easily pedal out to sail or pedal home when the wind is too light. Add a SideKick ama kit for additional stability if desired. The MirageDrive pedal system's fins act as a keel or centerboard when in the down position offering the lateral resistance needed for upwind sailing.

SAIL KIT INCLUDES:

Mast*, sail (20.25 sq ft.), lines, fittings and storage bag.
(*2 Piece mast standard / 4 Piece mast for i-Series)

Add the large rudder #81397001 for more responsive rudder control. Adventure / Revolution 16 models can add the dagger board for enhanced upwind performance.

- 84512002** SAIL KIT RED/SILVER
- 84514002** SAIL KIT PAPAYA/ORANGE
- 84513002** SAIL KIT CHARTREUSE/SILVER
- 84515002** SAIL KIT AQUA/CHARTREUSE

84516002 i-SAIL KIT WHITE/PAPAYA
(Not available for i11s)



HOBIE GLOVES

Protect your hands while increasing your grip strength. Gloves add grip strength on lines which can ease up on the amount of force you need to exert. Available in small, medium, large & extra-large. (xx = size)

3188xx HOBIE GLOVE



AIR-FLOW TELS

Trim your sails for optimum performance. Attached air flow over sails is critical. Air flow directions are indicated by these tell tails. Made of light weight rip stop nylon (Red / Green). Attaches to sails with waterproof adhesive disks.

334 SET OF 14

SAIL KIT SPARE PARTS

- 84503** REPLACEMENT 2-PIECE MAST
- 79052251** REPLACE 4-PIECE (i-SERIES) MAST
- 84511** REPLACEMENT SAIL BATTEN W/CAP
- 84509001** REPLACEMENT BATTEN CAP
- RH112WHT** BATTEN TIE LINE (PER FOOT)



ROLLER FURLING KIT

This is the ultimate for easy operation of a Hobie Mirage sail kit. Start with the sail rolled around the mast. When you are ready... un-furl to expose the sail or leave a little rolled on the mast to test the wind! By partially unrolling the sail, you are "reefing" some of the sail for better control and stability. If you are ready for full power... roll it all out! Heading back to the beach? Roll the sail up tight on the mast and beach or dock the kayak with ease. Fits any Hobie Mirage sail kit (not for i-Series kayaks due to their stayed rig). The rolled sail will fit in current full-length sail bags. Hardware is easy to install and removal of the sail and control lines is simple for storage.

84517001 ROLLER FURLING KIT

LARGE TWIST AND STOW "SAILING" RUDDERS

81397001

81397101 for use on i-Series, Quest



ADVENTURE / REVO 16 DAGGERBOARD

RUDDERS

81397001 LG RUDDER BLADE

81397101 LG RUDDER BLADE/QUEST i-Series

79502001 DAGGERBOARD



SAILING TIP!

SAIL POWER: Watch the sail, pay close attention to the trim or adjustment of the sail. When the front of the sail, just behind the mast, luffs or flutters in the breeze, you lose power. To start moving, pull the sail in just enough to stop the sail from luffing or turn the boat away from the direction the wind is coming from. There are also short ribbons hanging on either side of the sail called "tell tails". The tell tails react to air flowing over the sail and will help you see that the sail is pulled in too tight or too loosely. If you pull the sail too tight you will stall the sail power. The tell tail on the back side of the sail will drop or do circles. Ease the sail out until it luffs, then pull it in just a little until it stops luffing. You will adjust the trim whenever the wind changes direction or you change course.



BIMINI



Relax all day under the cool shade of our all new kayak Bimini. UPF 50+ fabric and sophisticated articulation feature provide sun and rain protection no matter the time of day. Customize your setup, multiple color options help create your unique look. The Hobie Bimini offers unprecedented comfort and sun relief to let you enjoy and extend your time on the water. Integrates with the Hobie accessory mount base for simple, no-drill installation to get you on the water in no time. The Aircraft grade aluminum mast provides a sturdy and stable base. Over-center, support beam adds extra rigidity and structure. A slight push retracts the beam, quickly collapsing for disassembly on the water should an unexpected squall pass through. Rear hooks easily fasten to pre-installed cargo padeyes and Bungees® for secure attachment and use on the water. **UPF 50+** fabric provides protection from the sun's powerful rays all day long, creating the space for longer and cooler days on the water. **Water-Resistant** Water-resistant coating guards against unexpected showers or ocean spray keeping you safe and dry from the elements. **Durable** The Hobie Bimini is designed to effectively withstand all of the action from your water adventures. The lightweight ripstop nylon is rugged and durable.

For detailed information, more images and setup video: hobie.com/accessories/bimini

- 72020520** HOBIE BIMINI POSEIDON BLUE
72020521 HOBIE BIMINI MARINE GRAY
72020522 HOBIE BIMINI SUN YELLOW



SIDEKICK AMA KIT

Great added stability for use when sailing, fishing, standing when sight fishing, diving or shooting photos! SideKick ama kit is simple, light weight and effective! Floats are inflatable.

The SideKick's cross arms adjust the float height with a simple "click-twist-click". Just like a paddle shaft adjustment. Three positions offer you high - medium - low positions. Set the floats high for cruising (less drag) or secondary stability. Use the medium or low settings for primary stability (less initial roll). Fine adjustments for float height are done by twisting the main crossbar within its mounts and tensioning with the fastening hardware.

Set up and use right off the beach or disassemble and deflate to store inside the hull. Then assemble and inflate when you get to your dive or fishing spot. Inflation is simple. Just blow a few breaths into each float through their one-way valves. Valve cap unscrews for rapid deflation. Installs with 4 bolts using expanding nuts. Not for use on Pro Angler models.

- 72062101** SIDEKICK AMA COMPLETE KIT - Light Gray
72063101 SIDEKICK AMA COMPLETE KIT - Dark Green
72062061 SIDEKICK +07 ADVENTURE MOUNTING ADAP PLATE SET
(Adapts Island crossbar attachment point to SideKick mount spacing)

- 72062062** SIDEKICK - MOUNT KIT W/CENTER BAR
(For second hull installation. Crossbar and mount hardware only)



DODGER

DODGER



HOBIE DODGER

The Hobie Dodger is a spray, cool breeze and sun shade for your lower body. Deflect bow spray, block cool breezes and stay warmer in cold conditions.

Works like a small pop-up tent. Loops of bungee connect to the boat via small fittings installed along the rails. The entire dodger folds forward to enter or exit the kayak, to make pedal adjustments or reach items in the cockpit. An access panel is built-in for using the sailing rig. A great combination when there is wind and spray!

Great for hunters, animal and bird watchers as the Dodger conceals your legs movement. The Hobie Dodger makes your kayak a sit-inside sit-on-top!

Installs in minutes initially, but installs in moments once the fasteners are in place. Packs away into a small stow bag 5" round by 24" long (1.8 lbs).

Mirage Dodger Fits the Hobie Mirage Outback, Sport, Adventure and Revolution, Island kayaks (May fit other models with some modification to hardware placement). Includes an opening for a sail kit or Bimini mast. Island versions include a larger opening for the Island mast.

HOBIE MIRAGE DODGER

72721001 DODGER SILVER

72722001 DODGER RED

HOBIE ISLAND DODGER

72730002 ISLAND DODGER SILVER

72730004 ISLAND DODGER RED

Tandem Island: Island Dodger forward / Mirage Dodger aft



HOBIE ISLAND MAST HEAD WIND DIRECTION VANE

The mast head wind vane will help you keep your Island on the best angle to the wind for better sailing. Helps you understand shifts in wind direction so you can adjust course or sail settings. Achieve the most performance and optimal course. Up on the mast head is the least disturbed wind flow, so the optimal location for a wind direction vane. As you sail, wind directions are not typically constant. As the wind changes direction or oscillates, you need to adjust heading and or sail trim for best performance. Use the vane for rough adjustments and the wind tell tails on the sail for fine adjustments. This wind vane is designed for all Hobie Islands when not using a spinnaker kit. Simply slips over the mast head and tightens in place with a thumb screw.

72020356 MAST HEAD VANE

HOBIE ISLAND SPINNAKER/REACHER KIT

Add performance when reaching or running to your Hobie Island. Off-the-wind sailing is typically the slowest point of sail, add a spinnaker and the Island comes alive! The Hobie spinnaker kit includes a snuffer launching and retrieving bag which makes handling the spinnaker as easy as can be. Simply pull on the halyard line to launch, set the sheet and off you go! To lower, ease off the halyard and pull on the retrieval line. The spinnaker drops and stows directly into the snuffer system. The kit includes a mast head wind direction vane for use while rigged for the spinnaker. The mast head wind direction vane will help you keep the Island on course for spinnaker sailing. Spinnakers are for broad reaching across the wind to directly sailing down wind. They are not for sailing higher angles than a reach across the wind. *May require sail head modification by a sailmaker in older model Islands. Requires several inches of mast above sail head to fit into mast head fitting.

Note: Spinnaker sailing can be challenging and may not be for the novice sailor. We strongly suggest learning to sail your spinnaker in light winds. Once you learn how to handle a spinnaker... You are going to LOVE IT! Spinnakers add a whole new dimension to your sailing experience.



72020350 SPINNAKER KIT ADVENTURE ISLAND (57 sq ft / 5.30 m²)

72020351 SPINNAKER KIT TANDEM ISLAND (73 sq ft / 6.78 m²)

72020358 WIND VANE REPLACEMENT (WIRE AND VANE)



HOBIE MIRAGE ISLAND TRAMPOLINES

Added space for carrying gear, allows you to move weight outboard for better performance in windy conditions, comfortable sitting or laying down position, carry additional crew / kids / pets (does not increase basic weight capacity), reduce spray in cockpit. The trampolines are made from mesh vinyl as used on our catamaran product. Available in Gray or Black. Easy installation. Fast (side-release) buckles across aft aka make folding akas quick. Adjustable webbing straps for a tight fit. Rolls down and straps to forward aka for storage or easily slips off the aka. Paddle storage, gear pockets and lanyard grommets included. (200 Lb Capacity)

88527001 TRAMP SET AI / TI* - BLACK

88527011 TRAMP SET AI / TI* - GRAY

**Fits all TI and 2015+ AI (54 3/4" Length)*

79527001 TRAMP SET 2014-OLDER AI - BLACK

79527011 TRAMP SET 2014-OLDER AI - GRAY

Fits older AI (57 1/4" Length)

HALF TRAMPS AND PARTS

88527201 TRAMP LEFT SIDE AI / TI* - BLACK

88527301 TRAMP RIGHT SIDE AI / TI* - BLACK

79527101 LACING ROD

79527201 WEB/BUCKLE ASSY

91050020 SEW ON HOOK BLK



ISLAND HIKING STICK

Extend your reach to your steering. Allows you to move your weight (hiking) outboard onto tramps or hakas for better stability, speed and comfort. Fits 2011+ Mirage model steering handles and all Tandem Islands.

72020063 HIKING STICK - AI/TI



OUTBACK

REVOLUTION

HOBIE HATCH LINERS

For Hobie Mirage Outback, Revolution and Quest. The forward hatch liner is a space to store gear or fish just inside the forward hatch lid. Keeps items from sliding forward or back inside the hull and keeps them up off the bilge. Now available for the Hobie Outback, Revolution 11 / 13 and Quest 11 / 13 (2014+).

HOBIE HATCH LINERS

72020041 OUTBACK <=2018

72020109 OUTBACK 2019+

72020042 REVOLUTION 13 / 2014+ QUEST 13

72020044 REVOLUTION 11 / QUEST 11



PLANO TACKLE BOX

TACKLE BOX SMALL - 10

adjustable dividers create 5-15 compartments.

Clear/Yellow 9.13" x 5" x 1.25"

72020311 TACKLE BOX SMALL



TACKLE BOX MEDIUM - 15 adjustable dividers create 5-20 compartments.

Clear/Blue 11" x 7.25" x 1.75"

72020321 TACKLE BOX MEDIUM

TACKLE BOX LARGE - 25 dividers create 3-28 compartments. Perfect box for extra long bulk storage. Clear/Red 14" x 9.13" x 2"

72020331 TACKLE BOX LARGE



3 PACK

HOBIE GEAR BUCKET

Add a drop-in "tackle box" to your 8" Hobie Twist and Seal hatch. The Gear Bucket containers are 2 1/2" deep and hang on the hatch lip or can be slipped down into the hull so you can carry several. Keep one on the hatch lip for easy access. Easily size-adjustable storage segments. Get the three pack with handy storage bag and pre-pack your fishing tackle for fishing different species.

71704001 HOBIE GEAR BUCKET

71706001 3 PACK WITH BAG (8" Hobie Gear Bucket)

71705001 BAG FOR 3 HOBIE GEAR BUCKETS



HOBIE GEAR BUCKET - DEEP

Add a drop-in "storage box" to your 8" Hobie Twist and Seal hatch. 5" deep bucket without dividers.

Note: Does not fit Pro Angler Aft Hatch

71704021 HOBIE GEAR BUCKET - DEEP



HOBIE TWIST AND SEAL HATCHES

Lids hinge open, so you never lose the lid. A simple twist of the handle opens or closes the hatch. The hatch does not have to be held down against a flat surface to seal. This allows the hatch to seal even if the lid is partially open or tipped. Available in 6" and 8" diameters. * Kits include gaskets and screws (8031131).

71701001 6" TWIST AND SEAL KIT *

71701011 6" TWIST AND SEAL HATCH

71321001 6" MOUNT GASKET

71701021 6" TWIST AND SEAL O RING

71702001 8" TWIST AND SEAL KIT *

71702011 8" TWIST AND SEAL HATCH

71331001 8" MOUNT GASKET

71702021 8" TWIST AND SEAL O RING



VANTAGE SEAT ACCESSORY BAG

The Vantage Seat Accessory Bag is the perfect addition to your MirageDrive® kayak. Ideal for storing extra tackle, keys and wallet, lunch, a foul weather jacket, birding glasses, safety gear and more.

Vantage Seat Accessory Bag Features:

- 4 easy Velcro straps for attachment to the Vantage seat back
- Water resistant construction for keeping things dry
- Key tether with YKK snap swivel for extra security
- Interior zipper pouch for organizing smaller items
- Drainage hole in the bottom of the bag to rid water and allow the interior of the bag to dry completely
- Clear visibility window in the top of the bag so you know exactly what you're reaching for
- Dimensions: approx. 8" Tall x 8" Wide x 3" Deep

72020117 VANTAGE SEAT ACCESSORY BAG



HOBIE RECTANGULAR TWIST AND SEAL HATCH KIT

The Horizontal hatch is stiff and strong as designed for standing-on. Unique Hobie designed seal and flange lip drainage keeps water out. Add the optional tackle management tray that deploys two tackle boxes as you open the hatch or the drop-in hatch bucket for versatile small parts storage (both shown below). Includes backing ring. The kit includes the Hatch, gasket, backing ring, screws and instructions.

71707003 HOBIE RECTANGULAR HATCH KIT



HOBIE RECTANGULAR HATCH ACCESSORIES

Add a drop-in "storage box" to your Hobie rectangular hatch or tackle management tray that deploys two tackle boxes as you open the hatch.

71709002 HOBIE RECTANGULAR BUCKET

71708001 HOBIE TACKLE MANAGEMENT

Some hatch locations may not allow bucket use due to hull depth



GUSSETED STOW BAG

6" by 12" gusseted bag has hooks on both ends to clip to your boat. Also available in 8" x 15" size. Securely stow tools, gloves or small parts for easy access.

72000B 6"x12" GUSSETED STOW BAG

72005B 8"x15" GUSSETED STOW BAG



72020111



72020113



HOBIE SOFT COOLER/FISH BAG

Keep your food or catch cold all day, even in very hot conditions. High quality construction includes half-inch closed cell foam that insulates, vinyl coated polyester that's durable and YKK zippers that are strong. Has handles for carrying and d-rings on the sides for attaching to the kayak.

Large size Bag is approximately 70 qt. The top has an adjustable bungee cord for storing additional gear. Dimensions: 36 inches long, 8 inches tall, bag tapers from 10 inches wide in the front to 20 inches wide in the back. **Medium size Bag** is approximately 26 qt. Easy access zipper on top and drain plug on bottom. Fits inside front hatch of many Hobie kayaks. Dimensions: 24 inches long, 7 inches tall, bag tapers from 7 inches wide in the front to 16 inches wide in the back. **Compass Bag** is made specifically to fit the bow recess of the Mirage Compass.

72020114 SOFT COOLER / FISH BAG - COMPASS

72020113 SOFT COOLER / FISH BAG - MEDIUM

72020111 SOFT COOLER / FISH BAG - LARGE

72020118 SOFT COOLER / FISH BAG - XL

PA BUCKET/ALL CARGO COOLER

This cooler is designed to fit within a Pro Angler forward hatch liner. It will also fit nicely in all other Mirage aft cargo areas. Bring along your favorite cool beverages and foods or use as a catch bag. Includes several mesh pockets, shoulder strap, carry handles, tiedown rings.

72020087 COOLER - PA BUCKET / ALL CARGO



HOBIE SMALL ROLL TOP DRY BAG

8" diameter x 14". This dry bag is built of tough materials. Seals tight to keep your stuff dry.

71703001 8" HOBIE DRY BAG



VIEW DRY BAG

Transparent 13 oz. vinyl bags make quick work of locating things. Its cylindrical shape will hold various shapes such as clothing, cameras, binoculars, lunches, etc. without distortion of bag and resultant potential leakage. Air purge vent.

72210L VIEW VENTED (10L)

72230L VIEW VENTED (30L)

CARTS

Kayak Carts or Dollies are a must for easily transporting your kayak from car to water's edge. Simply roll the kayak down to the water and off you go! All of the latest Hobie Kayaks can use "Plug-in" carts. "Plug-in" carts do just that...they plug right into the bottom of your kayak. Choose Standard for light duty and solid surfaces, Heavy Duty for heavy loads and rough terrain or the "all-terrain" Hobie Trax "2" version which is the best over soft sand. Each cart has a sturdy stainless steel frame. Some older models, i-series or other brands of kayaks may require the use of a different type of cart.

KAYAK CART "PLUG-IN" STANDARD

Light weight with durable 26 cm tires and strong spoked wheels. Stainless steel frame. Wheels are easily removable for storage. Also includes cart keeper feature and cart clamps. This cart has the medium capacity. (150 lb Capacity). Great for transport over solid surfaces.

80045001 STANDARD CART

**Note Tandem Island use issue*

KAYAK CART - "PLUG-IN" HEAVY DUTY

Highest capacity cart with very durable knobby (Solid Foam) 26 cm wheels. Welded Stainless steel frame. Wheels are easily removable for storage. Also includes cart keeper feature and cart clamps. This cart has the highest capacity. (225 lb Capacity) Suitable for Pro Angler and Tandem Island. Best for transport over solid surfaces.

80046001 HEAVY DUTY CART

**Note Tandem Island use issue*



KAYAK CART "PLUG-IN" HOBIE TRAX "2"

The Trax "2" Cart has 24 cm (blow-molded polyurethane) pneumatic tires. These tires have a high capacity and are very durable! Welded Stainless steel frame. Wheels are easily removable for storage. (176 lb Capacity) This is an all around cart for soft sand and uneven terrain. The tires are wide and can be deflated for better performance over softer sand and soil.

80044101 TRAX "2" CART

**Note Tandem Island use issue*

KAYAK CART "PLUG-IN" HOBIE TRAX "2-30"

All of the great features of a Trax 2 cart with **higher capacity!** The Trax "2-30" cart has 30 cm tires, bringing the capacity up to 242 lbs. Even with a lighter load, the Trax 2-30 will be the best plug-in cart for sand.

80043001 TRAX "2-30" CART

**Note Tandem Island use issue*



80044202 CRADLE / PLUG-IN CART

80046021 PIN, QUICK CLIP

Wheel retainer pin replacement kit.

KAYAK CART "PLUG-IN" FOLD AND STOW

All new Plug-In Cart! Hobie Fold and Stow! Easily assemble for use or disassemble (<30 seconds) and stow on / in your boat. Disassembled parts fit inside most kayak hulls that have larger hatches. Stow bag included. New cart keeper feature is simple to use. Rotate the ball to the side to lock the cart in place. Pull on the cart to disengage and the ball pops back on top of the post. Aluminum frame (175 lb Capacity) No tools required. **80047001** CART FOLD AND STOW

**Note Tandem Island use issue*



- Quick release wheels
- Collapsible frame
- Stows in most hulls
- Ball lock cart retainer
- Carrying bag included



CART KEEPER FEATURE (Pin replacement 80044151)

Standard on Hobie Plug-in carts shown to the left (Not this version on Fold and Stow Cart)! After insertion of the cart, pull the dome pin out and re-insert as shown to keep the cart captive.

POST COLLAR / CLAMP FEATURE (80044201 Set Of 2)

Collar clamps help reduce the direct loading of the cart on your kayak's bottom / keel. Direct loads on hull bottoms can cause deformation of the kayak. Even loading at scuppers and hull bottom reduces hull-bottom deformation issues. Included with all new plug-in carts.

CAUTIONS

Be certain that the cart inserts clear through the kayak and protrudes into the cockpit / cargo area surface. Kayaks should never be left on carts for prolonged periods of time.

**Note Tandem Island use issue. Plug in carts are not recommended for the Tandem Island due to weight. Using a plug in cart can damage the scuppers or deck area in the hull.*



KAYAK CART C-TUG

Carries up to 80kg (170lbs), dismantles for easy stowing, won't rust. Requires no tools and assembles in seconds. Dismantles in seconds, allowing you to stow it in your kayak hatch. Made of non-corroding engineering polymers, with stainless steel reinforced axles, this cart is designed for harder terrains.

80047201 C-TUG CART

KAYAK CARTS FOR I-SERIES KAYAKS AND ECLIPSE

Plugs into the bottom of the Eclipse or inflatable series kayak's MirageDrive well. Stainless steel frame. Wheels are easily removable for storage. Standard is Light weight with durable 26 cm tires and strong spoked wheels. This cart has the medium capacity. (150 lb Capacity). Great for transport over solid surfaces. Trax is designed for soft surfaces such as sand or pebbles.



80045101 i/E STANDARD CART

Fits Eclipse and i-Series Kayaks (150 lb Capacity).



80045201 i/E TRAX CART

Fits Eclipse and i-Series Kayaks Pneumatic tires are great for soft sand and rough surfaces. (176 lb Capacity)

HOBIE KAYAK DOLLIES

Full size dollies for the Adventure / Tandem Island or Pro Angler / Universal includes a hull / ama cradle, and a pull handle. Much stronger and easier to load and use than plug-in carts for larger, heavier models. Two different wheel styles allow for optimum performance on hard pack surfaces – or soft sand beaches. Choose beach wheels for use over soft sand or other surfaces. Choose the tuff tire if your launch surfaces are solid. The handle makes it easier to insert or remove the cart under the boat or pull along when un-loaded. The handle also acts as a “kick-stand” to keep the cradle upright during loading. The handle and wheels are easily removable for storage. The Pro Angler / Universal dolly will fit a wide variety of Hobie Kayaks including Pro Anglers, Outback and Oasis. Recommended maximum load equal to one Tandem Island without excess personal gear.



80046200 AI/TI DOLLY DOLLY
W/ 42 cm BEACH WHEELS

80046200 AI/TI DOLLY - WITH BEACH WHEELS

80046201 PA/UNI - WITH BEACH WHEELS

80046202 PA17 - WITH BEACH WHEELS

(72061001 Replacement wheel retainer pin)



80046100 AI/TI DOLLY
W/ 38 cm TUFF TIRES

80046100 AI/TI DOLLY - WITH TUFF TIRES

80046101 PA/UNI - WITH TUFF TIRES

80046102 PA17 - WITH TUFF TIRES

(72061001 Replacement wheel retainer pin)

LOADING

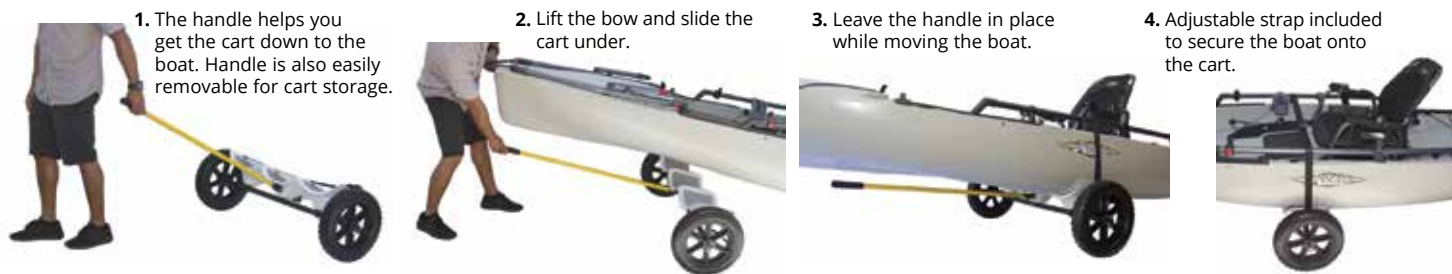



38652202 TRAILEX TRAILER - PA17T
Shown with optional cradles, dolly and dolly hanger kit installed

KAYAK TRAILERS

Trailers ride on 8" wheels and use a 1 7/8" coupler. Trailex trailers are certified to USA DOT standards for use on USA roads.

Carry one or more kayaks inverted on the crossbars (crossbar padding / cradles shown are not included with trailers). For the Adventure Island, Tandem Island or Pro Angler, add the custom designed hull cradle sets (Adventure Island V1 cradles shown to right on double trailer). These are form fitted and padding covered. For two Adventure Islands, order the double trailer (Double-Double for two Tandem Islands) add two cradle sets. The optional center Tower System adds storage possibilities. The Tower includes mast / sail hangers and is also designed to mount an equipment box on top. Easily mount the Hobie Toy Box on top of the Tower.

38652010 TRAILEX TRAILER - SINGLE AI / PRO A 12,14

Shown right. Order cradles separately.

(Crossbars 42" / 15' 2" assembled length / 220 lb Capacity).

38652011 TRAILEX TRAILER - SINGLE TI

Order cradles separately.

(52" Crossbars / 15' 6" assembled length / 350 lb Capacity).

38652200 TRAILEX TRAILER - DOUBLE

Shown above (Right) with AI and cradle set option and (#38652210) tower system.
(84" Crossbars / 16' 1" assembled length / 550 lb Capacity). Order cradles separately.

38652201 TRAILEX TRAILER - DOUBLE / DOUBLE

Not shown. Required to carry 2 Tandem Islands or one TI and AI side-by-side.

(96" Crossbars / 16' 1" assembled length / 550 lb Capacity). Order cradles separately.

38652212 TRAILEX TRAILER - PA17T

Order cradles (72020404) and optional Dolly Hanger Kit (72020405) separately.

38652210 TOWER

Add the optional tower for equipment box mounting on a double trailer, multi kayak transport (Up to 4 kayaks leaned against tower). Also includes two mast carriers for 2x AI/TI configuration.

Trailer prices DO NOT include freight to dealer or assembly costs.

38652000 SINGLE

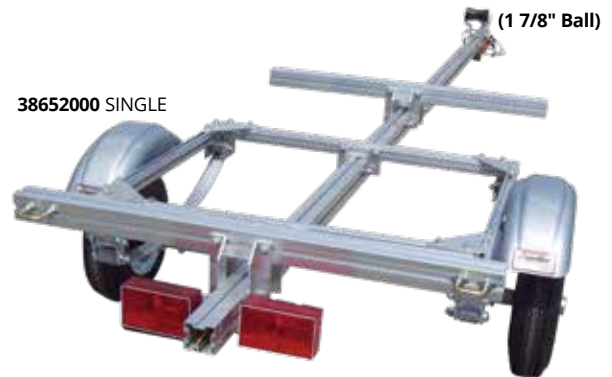

38652200 DOUBLE



**Trailer shown with Adventure Island cradles option*

NOTE: Loads may require a red warning flag if over hanging lights by over 4 feet.

CRADLES



72020406 AI V2 CRADLES



72020402 TI CRADLES



72020401 PRO A 12/14 CRADLES

** Refer to cradle instructions for proper spacing or 67" on all others*

72020401 CRADLE SET (1 boat) - PRO ANGLER 12 / 14

72020404 CRADLE SET (1 boat) - PRO ANGLER 17

72020428 CRADLE SET (1 boat) - COMPASS & DUO

72020407 CRADLE SET (1 boat) - OUTBACK <=2018

72020427 CRADLE SET (1 boat) - OUTBACK 2019+

72020406 CRADLE SET (1 boat) - ADVENTURE ISLAND 2015

72020400 CRADLE SET (1 boat) - ADVENTURE ISLAND V2 (2011-2014 MODEL YR)

72020402 CRADLE SET (1 boat) - TANDEM ISLAND

(No fasteners included)



STORAGE BOX "TOY BOX"

Roto-molded seamless. Big enough to hold paddles, MirageDrives, Seat backs, Life Vests and wet wear and have room left for odds and ends. The bottom is ribbed to allow wet things to drain. There is full access from front and back. Mounting hardware is not included. Length 10' 4", Width (rear) 21", Depth (rear) 13", Width (front) 19 1/2", Depth (front) 10", Weight 55 lb.

1825WHT TOY BOX

Prices DO NOT include freight to dealer. Additional freight charges may apply.



ROOF RACK PAD

Beefy car roof rack pads, made from durable black polyester with Hobie logo. Easy-on split bottom with Velcro™ closure.

72045 24" ROOF RACK PAD (Pair)

72046 36" ROOF RACK PAD (Pair)

72044 24" AERO RACK PAD (Pair)

72049 36" AERO RACK PAD (Pair)



HOBIE TIE DOWN STRAPS

Rack tie-down straps, made of durable black polypropylene webbing. Diagonal cut and ironed ends make threading ends into buckles easier.

72042001 TIE DOWNS 12' (Pair)

72043001 TIE DOWNS 15' (Pair)



MK0046 HOBIE CAUTION FLAG



QUICK STRAP SPORTRACK

Easily installs on any vehicle with front and rear doors or opening windows. The straps secure inside the car, no gutter hooks are required. Packed in mesh storage bag (#72040 with bow and stern tie downs).

72040 QUICK STRAP SPORTRACK (30" Pair)

72035 QUICK STRAP SPORTRACK (24" Pair / No Lines)

COMPASS LOADER



COMPASS LOADER

Molded to fit snugly on the transom of the Hobie Mirage Compass and Compass DUO. The Compass loader is a load-assist tool. It incorporates rubber skids and handles to make car top loading of the kayak easier and helps prevent damage to the kayak during loading.

View the Compass Loader video by scanning the QR code to the right. Most smartphones will direct you to a linked file by simply focusing the phone's camera on the QR Code. You can also Google "Hobie Compass Loader Video"

81711000 COMPASS LOADER



Compass Loader
Video

RHINO LOADING ACCESSORIES

Load a kayak on to your vehicle without having to lift the full weight. Perfect for loading up solo or for car topping heavier boats.



UNIVERSAL SIDE LOADER

The Rhino-Rack Universal Side Loader assists you in loading your kayak, ladder, camping gear or other longer heavy items, onto your roof rack crossbars. Simply lift one end of your load onto the Rhino Universal Side Loader, then pivot your load onto your crossbars.

Be sure to tie down your load once it is safely on the crossbars using load rated fastening straps.

FEATURES INCLUDE:

Push button for quick release and easy storage; Crossbar clamps to suit all popular roof racks; Heavy duty storage bag; Support pole for loads greater than 44lbs (up to 132lbs); Integrated load stop prevents load from sliding off bar; foam padding for protection of your gear; Padding on the underside of clamps to protect vehicle roof; Fits all Rhino Aero, HD/Euro, all Thule Square, Aero bar & Wingbar, Rola, Prorack and Whispbar

72040011 RHINO UNIVERSAL SIDE LOADER

NAUTIC KAYAK LIFTER

Is a complete system for easily loading and unloading sit on top kayaks. 80kg (176 lb) load capacity, does not require any heavy lifting and a single person can operate it using the included winch.

The unit is designed to be neatly stored on the roof of your vehicle beside your kayak when not in operation.

Important Note: Designed to fit Rhino roof rack systems with bar overhang with at least 100mm. Contact Rhino for other rack Mfg compatibility.

72040012 RHINO NAUTIC KAYAK LIFTER



T-LOAD HITCH MOUNT

The Rhino-Rack T-Load Mount is the perfect load carrying solution for long loads. Built tough from E coated Steel, the T-Load allows you to effortlessly load and transport your kayak. Mounting to a 2" hitch receiver the T-Load features an adjustable tilt position.

A fitting kit is provided to attach your Rhino-Rack crossbars directly to the top of the T-Load and because we're top blokes we've also thrown in a non-slip mat to stop slippage when loading.

FEATURES INCLUDE:

Single person use; Adjustable height & tilt position: Minimum height 950mm; Maximum height 1540mm; 1 x Rhino-Rack Aero crossbar; Rhino-Rack crossbar fitting; 1 x RTLK (Rhino-Rack T-Load Sling Kit); Non slip mat; 3 year warranty

72040013 RHINO 2" RECEIVER T-LOADER





KAYAK COVERS

Easy to install or remove, fits over the hull (like a fitted sheet on a mattress). Straps and pull string adjust for a tighter fit. Cross straps secure the cover on your hull for windy conditions. Heavy duty UV resistant canvas material in a neutral color for better aging. Universal covers fit over the hull when upright or upside down. To help prevent distortions to the hull bottom shape, Hobie recommends that our kayak hulls be stored upside down resting on the cockpit rails. This is also best for deflecting rainwater and prevents water pooling in the cockpit or on the cover. When planning to store a hull upright, be sure to properly support the hull bottom to prevent hull distortions. Universal fit covers may not entirely cover some hulls, especially with accessories installed.



DRAW STRING



CINCH STRAPS



72055 Kayak Cover PA14 Custom

72056 Kayak Cover PA12 Custom

UNIVERSAL FIT COVERS:

72050 Kayak Cover / 9'-12' 6" x 49"
(Lanai, Maui, Sport, Revolution 11, Compass, Outback <=2018, Kona-Tight, Quest 11)

72051 Kayak Cover / 12'-15' x 49"
(Kona [Loose], Pursuit, Mirage Classic, Tandem, Oasis, Outfitter, Quest 13, All Outback, Revolution 13)

72052 Kayak Cover / 14'-16' x 55"
(Adventure, Revolution 16, Tandem, Oasis, Odyssey)

OUTBACK 19+ CUSTOM FIT COVER:

72063 Kayak Cover Outback 19+ Custom

PRO ANGLER CUSTOM FIT COVERS:

72056 Kayak Cover PA12 Custom

72055 Kayak Cover PA14 Custom

72057 Kayak Cover PA17 Custom

ISLAND CUSTOM FIT COVERS:

72058 Kayak Cover AI Custom 2015+

72059 Kayak Cover TI Custom 2015+

RUDDER COVER ISLAND / TI

Rudder protection for 2011+' AI and all Tandem Island Rudders.

82420001 RUDDER COVER ISLAND / TI



MULTI STRAP SYSTEM

Hang your kayak for storage, use as bow and stern lines or use them as carrying handles. Multi purpose straps can be attached to the boat and adjusted for many uses. Made from durable black polypropylene webbing.

72041 MULTI STRAP (Pair)



MIRAGEDRIVE STOW BAG

This heavy duty Cordura and mesh bag fits the complete MirageDrive with standard fins or the ST Turbo length. There is extra space in the bag for things like a life vest or drive well plug. Also includes "D" ring fittings to allow attachment to Inflatable rolling bags. Large enough to store your Inflatable's drive, pump and 4 piece paddle.

80024 MIRAGEDRIVE BAG

ECLIPSE BOARD BAG

These heavy duty padded travel bags fit the ECLIPSE 10.5 or 12.0. There is extra space in the bag for the handlebar assembly.

72050002 ECLIPSE 10.5 BAG

72050001 ECLIPSE 12.0 BAG



Cart Access Slots. Use the plug-in Cart while the board is covered.



HOBIE ECLIPSE MIRAGEDRIVE STOW BAG

This heavy duty Cordura and mesh bag fits the complete MirageDrive with Flow Fins. There is extra space in the bag for things like a life vest or drive well plug.

72050011 ECLIPSE MIRAGEDRIVE BAG

ONE WRAP VELCRO®

Cut this double faced Velcro® product to length and wrap it around items, line or whatever you need to secure. One side is hook and the other a loop, so a single piece is all you need.

7904 ONE WRAP, PER FOOT



SHOCKCORD BALL TIES

Lashing equipment to your boat is quick and easy with this handy tie-down. Dozens of uses.

370 SHOCK CORD BALL TIES EA

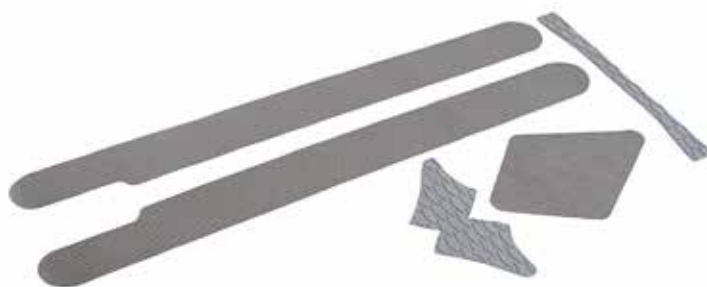

HOBIE NOSE-RAIL PROTECTION KIT

Protect your Eclipse nose, rails and deck surfaces with EVA stick-on coverings. Kit includes sections to protect nose, rails and decks. Protects from scuffs and scratches.

72050013 NOSE-RAIL GUARD KIT

HOBIE ECLIPSE PROTECTION KIT

Protect your Eclipse rails and surfaces with clear plastic stick-on coverings. Kit includes sections to protect rails and decks. Protects from scuffs and scratches.

72050005 RAIL PROTECTION KIT

HOBIE evolve POWERED BY TORQUEEDO

This quiet and efficient electric motor will dramatically expand your horizons. With the Hobie evolve, you can either maintain steady cruising speeds of two knots (motor only) for hours, or you can open the throttle for short sprints. Best yet, depending on your set-up, you can use the evolve to augment your boat speed while also using your MirageDrive. And thanks to its cockpit-mounted Remote Throttle, you always know how much juice you have left in the system's 320 Wh Lithium-Manganese battery. Runtime estimated as 8 hr 20 min at 2.6 mph / 48 min full throttle.

The evolve offers increased battery capacity, longer range and solar charge / run capability. Includes well mounted drive for all Mirage Kayaks and optional Twist and Stow rudder attachment for (most) non-inflatable models.

72022030 HOBIE evolve v2 MOTOR KIT - Kayak

72022040 HOBIE evolve v2 MOTOR KIT - i Series

KIT INCLUDES:

Ready-to-go Mirage well-mounted Hobie evolve v2; All cables for the motor and throttle units; All mounting hardware; Assembly that integrates the motor with a Twist and Stow rudder*; Sealed/Waterproof Lithium-Manganese high-performance battery; 320 Wh (charger included); Remote throttle system displays speed and distance information generated by an onboard GPS unit; Magnetic safety key; Waterproof fittings and cable connectors; Solar charging port; Corrosion-resistant materials ensure durability and performance; Lightweight power: Total weight of installed kit is 18 lbs (8.16 kg) or less, depending on the configuration.

72022032 evolve MOTOR KIT - Kayak / NO Battery

SPARE BATTERIES

72022126 V2 BATTERY 320 wh

72022141 BATTERY 915 wh (Large Case)

LITHIUM BATTERY V2

6.6-pound, 320 Wh Lithium-Manganese battery (11Ah at 29.6V) The battery is buoyant and completely waterproof. Its built-in GPS unit generates pertinent information such as speed and range. Solar charge / run port.



REMOTE THROTTLE

Remote Throttle, which attaches via a RAM mounting unit (included) to provide throttle control from your favorite seating position. The LCD screen displays all the trip info you need (such as speed and range) while you're underway. For safety, the unit features a magnetic key-to-throttle connection; break this magnetic connection and the motor immediately stops.

SOLAR PANEL

Add a solar charging panel to your evolve v2 system. Can charge the battery or run the motor indefinitely at approximately 2 knots (with optimum sun conditions). Solar panel uses dedicated plug-in on the v2 battery. 23 Watts of power for charging in best sun conditions, Weatherproof, Marine-grade connection, Ultra Light Weight, Ultra Thin, Ultra Durable, Roll for easy storage, Easy to use, Tested in salt water, Stainless Steel Grommets, Stainless Steel Rivets, Custom Built for Hobie Cat, Made in the USA.

Size Unrolled: 35.55" x 26.15" / **Size Rolled:** 26.15" x 6.0" / **Cable:** 10' / **Watts:** 23 Watts / **Operating Amps:** .75 Amps / **Operating Volts:** 30 Volts / **Weight:** 1.4 Lbs

72022133 v2 SOLAR PANEL 23w



MIRAGE WELL MOUNT

Mirage-mounted evolve weighs a scant 6.4 pounds—that's 0.2 pounds less than the MirageDrive.

2 for 1 BOTH MOUNTS INCLUDED

* Rudder Mount for all Mirage Series Kayaks with Twist and Stow Rudder Systems. Not Compatible with Inflatable Kayaks, Island Series or Pro Angler



RUDDER MOUNT

A lightweight assembly to easily integrate the evolve motor with a Twist and Stow rudder. Pedal and motor; motor, or simply pedal. When off, the engine becomes your rudder or it can be brought on deck via the Twist and Stow controls. *(The rudder mount option is not compatible with inflatable series, Island series or Pro Anglers)*

Note: Torqeedo Warranty is handled directly by Torqeedo. Refer to documentation included with these products.

TORQ TRAC

The dashboard for electric motors on your smartphone. Bluetooth accessory plugs in-line on the throttle cable and transmits a variety of great information to a smartphone. The App can be downloaded for free from the App store on your device.

FEATURES

Everything easily readable, even at night; Know how far you can still go: remaining range is shown on a map in real time; Uses waypoints for navigation and estimated time of arrival; GPS information; Trip logging and eco logging: see exactly how you're doing; Warning messages in plain language Individually adjustable

72022010 TORQ TRAC ACCESSORY

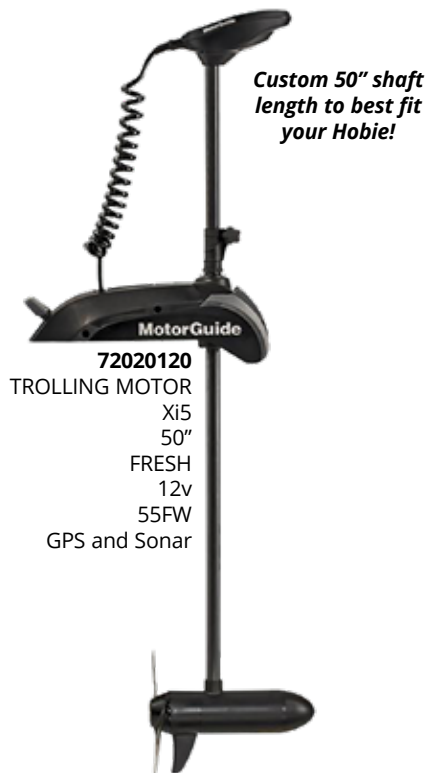

#1 CHOOSE A TROLLING MOTOR...**MOTORGUIDE® Xi5 TROLLING MOTOR**
12V 55FW CUSTOM-HOBIE 50" SHAFT AND PINPOINT GPS**72020120** TROLLING MOTOR Xi5 50" FRESH

Anglers can command precise motor and steering control while seated or standing with the wireless remote. Engage the motor's Pinpoint GPS functions, including anchor and jog, route record and playback, heading lock, and cruise control, to optimize kayak/boat control in all angling locations and conditions. A built-in 83/200 kHz transducer is standard with the freshwater model. Motors provide a quiet and smooth ride that will assist anglers in getting to the fish without disturbing them. Requires MotorGuide QR bracket (72020100) and Hobie trolling motor mount (72020090) to mount on the Pro Angler 17T.

#2 ORDER MOUNTS...**HOBIE PA17 TROLLING MOTOR MOUNT**

Easily mount a trolling motor to your Pro Angler 17 Tandem using the Hobie trolling motor mount. Designed specifically for the PA17 the mount allows easy removal of the motor for storage. Fits standard width motors. MotorGuide models listed here require a wider mount so add the 72020100 Quick release bracket.

72020090 TROLLING MOTOR MOUNT / PA17**72020100** MOTORGUIDE QR BRACKET

We chose a 50" shaft specifically for Hobie Pro Angler 17T. See the motor head for directional control when seated while keeping the motor depth optimal. Longer shafts can either catch on over hanging trees or be too deep in the water. Too short and the motor head is not visible over your PA17 crew.

INCLUDES WIRELESS CONTROL RIGHT OUT OF THE BOX, DURABLE AND RELIABLE, PRECISE STEERING AND CONTROL, AND VERY QUIET ON THE WATER.

Key Features:

- **Anchor Hold**
 - Hold position with a touch of a button, no matter how deep
 - "Jog" in precise increments from an anchor point using directional arrows
 - Save/recall 8 locations
- **Heading Lock**
 - Maintains compass heading navigation
- **Routes**
 - Record/recall 8 routes of up to 4 miles each
 - Virtually unlimited route record/recall when connected to certain Lowrance fishfinders
- **Cruise Control**
 - Maintain a GPS speed while navigating

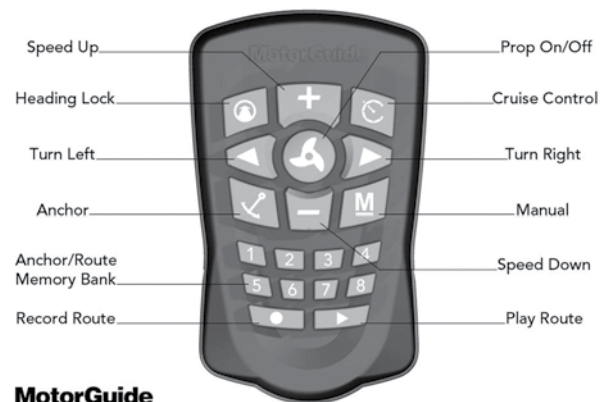
**MotorGuide**

Note: MotorGuide Warranty is handled directly by MotorGuide. Refer to documentation included with these products.

#3 ORDER WIRING KIT...

This kit simplifies the installation process of the MotorGuide Xi5 on your Pro Angler 17T, and includes all the marine grade components necessary. The Trolling Motor Wiring Kit allows you to run all your wiring in-hull and facilitates easy removal of the motor for trailering the PA 17T. *Deep cycle battery not included.

**72021090** WIRING KIT, PA17 TROLLING MOTOR

#4 ALL THAT IS LEFT IS TO GET A 12V DEEP CYCLE BATTERY FROM A LOCAL SUPPLIER!..

PARTS**72020123** BATTERY CHARGER 12 / 6 VOLT**72020124** PROP WEEDLESS 2 BLADE 3.5"**72020125** PROP NUT / WRENCH / PINS**72020126** PINPOINT GPS GATEWAY KIT**72020127** NMEA2000 STARTER KIT**72020128** 6-PIN LOWRANCE TOUR ADAP



LIVEWELL

Liven up your day on the water with the Hobie Livewell!

HOBIE LIVEWELL V2

The newly redesigned Hobie Livewell sports a fresh color scheme, modern lines and more built-in features than ever before. This livewell is plug-and-play with most Hobie kayaks and includes: (1) 6V sealed gel cell battery + charger for powering the pump, an adjustable downspout for filling the tank half way, a corrosion resistant power switch, 3 integrated rod holders, a threaded drain plug, easily removable tank partitions for keeping bait healthy, an 8" Twist and Seal hatch for access and bait concealment, heavy-duty straps for attaching it to the kayak and a carrying handle for easy transport.



72020077 HOBIE LIVEWELL V2 BAIT TANK

72020015 ROD HOLDER - LIVEWELL

(Additional rod holders include the required fasteners)



Weight: 12.7 lbs / 5.76 kg

6V SEALED GEL CELL BATTERY



FEATURES

High output pump circulates aerated water to keep bait alive, Battery and Charger included, Sealed Marine Switch for ON/OFF control, Adjustable downspout for water level control and drainage, Holds up to 8 gallons of water, Removable tank partition provides a rounded surface for keeping bait healthy, 3 vertical rod holders included, with pre-marked locations for adding more, 8" Twist and Seal lid for tank access & bait concealment, Carrying handle for easy transport, Heavy Duty straps secure livewell to cargo area, Pump cap for filling the tank with non-circulating water, Threaded drain plug keeps tank interior dry between uses



HOBIE LIVEWELL XL

Larger capacity, fits all Pro Angler models. 6 gal/22.71 L and 11 gal/41.64 L

72020072 HOBIE LIVEWELL XL BAIT TANK

72020015 ROD HOLDER - LIVEWELL

(Additional rod holders include the required fasteners)

The Livewell XL comes standard with two additional rod holders for a total of four rod holders.

TANK WATER LEVEL CONTROL

Adjust the Livewell XL tank water level using the included "C-clip" or drain the tank with the simple twist of a knob.

Weight: 15.4 lbs / 6.98 kg

6V SEALED GEL CELL BATTERY

CORROSION RESISTANT POWER SWITCH

Wire connections are housed inside a magnetic (reed) switch, ensuring maximum durability and corrosion resistance.

REMOVABLE TANK PARTITION

The removable tank partition keeps debris and critters from clogging internal pumps and drains or hiding in hard to reach areas. The partition also provides a rounded surface so baitfish stay healthy and happy.



H-BAR



ADJUSTABLE H-BARS

Standing support for Kayaks! The adjustable H-Bar will integrate with all H-Rail accessories for easy customization. It folds up when you need it and away when you don't. The aluminum extrusion is strong and lightweight for leaning against or holding on to while entering/exiting the boat or pulling yourself up from a seated to a standing position. The Outback Universal kit is fully adjustable to fit a wide variety of kayaks. The PA17 requires an adapter kit (extra set of H-Rail clamps and a longer center bar) when used in the middle and aft seat positions.

- Lean against to stabilize
- Pull yourself up from a seated position
- Grab ahold to assist when entering the kayak
- Variable height settings
- Folds out of the way

- 84500116** HOBIE H-BAR PRO ANGLER
84500115 PA17 H-RAIL ADAPTER KIT
84500117 HOBIE H-BAR COMPASS
84500119 HOBIE H-BAR OUTBACK / UNI
84500120 HOBIE H-BAR OUTBACK 2019+
84500121 HOBIE H-BAR PASSPORT 12

H-RAIL EXTRUSION

Integrates with all H-Rail accessories, like rod holder mounts, for easy customization.

WEIGHT
4.5 lb / 2.04 kg

INCLUDES
Mounts
Hardware

ADJUSTABLE

Four telescoping legs, along with foot-mount placement, enable a wide range of height settings.

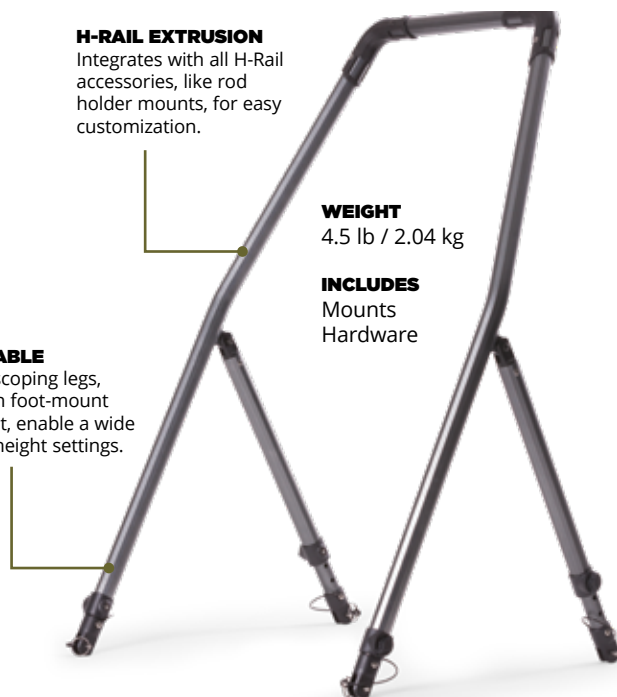

H-CRATE STORAGE SYSTEMS

72020088 HOBIE H-CRATE

72020298 HOBIE H-CRATE JR

- Fits on the back of a fishing kayak or SUP
- Keeps tackle, fishing rods and gear organized
- Lightweight & durable
- Can Be Disassembled to Store/Travel Flat

Weight: H-Crate 5.8 lbs / 2.63kg
Weight: H-Crate Jr. 5.05 lbs / 2.29kg
Includes: 4 Heavy duty straps
 (Replacement 72020284)

H-RAIL MOUNTING PLATFORM

Carrying Handles Provides structural strength and is great for mounting H-Rail accessories.

STORAGE
 Keeps your valuables organized in one easy-to-transport bin.

ROD HOLDERS

Four rod holders with shock cord rod retainers.

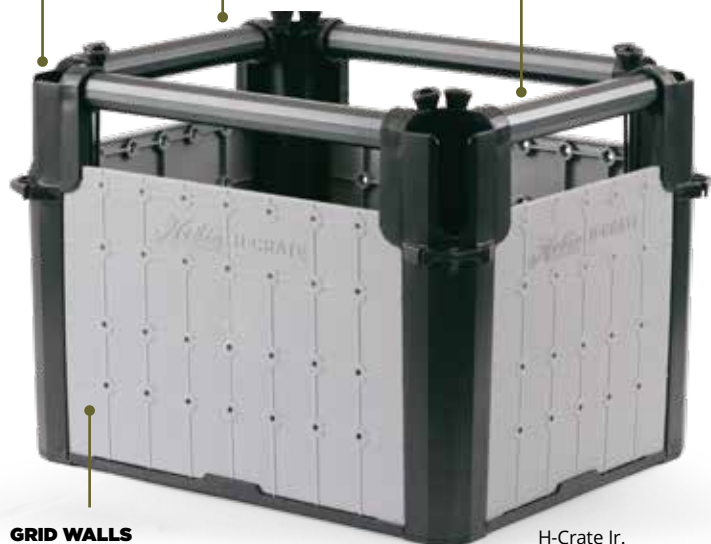

GRID WALLS

Attach additional accessories using the molded hole pattern (72020015 Rod Holders).

H-Crate Jr.
 Uses 4 short walls

H-CRATE SOFT COVERS

Vinyl cover with a zipper opening. Keeps gear drier and out of UV. Keeps gear in the crate from falling out in a capsize. Tested to extremes... the cover holds in place under heavy load even if inverted or tumbled. Easy to install using provided panel rivets. Double zipper is nylon, not corrosive and functions very smoothly.

72020097 SOFT COVER

72020297 JR SOFT COVER



MOUNT ADDITIONAL ROD HOLDERS TO H-CRATE

You can mount many additional rod holders to the grid walls.

72020015 ROD HOLDER - LIVEWELL

(Additional rod holders include the required fasteners)



PADEYE XL

Replace existing smaller padeyes to enable attachment of multiple straps or rod leashes on the same eye.

71125001 PADEYE XL



H-RAIL UPGRADE / ADD-ON KITS

H-Rail is a durable, lightweight, patent pending mounting system for quickly securing a complete line of H-Rail accessories. Easily attach, move or remove mounts and accessories quickly. The 12-Sided rails allow rotation at 30 degree increments and will hold when your H-Rail accessory is clamped in place. Get your FishFinder, Rod Holders, Tackle Buckets and more... right where you want them... then easily slide them out of the way!

Update older model Pro Angler 12 and 14s to the H-Rail system. Fits 2014 and some 2013 Pro Anglers. Other models may require some modification to steering crank (Note four screws in deck area near left steering handle indicates need for modifications). Kits include everything needed: Rails, mounts, attachment hardware and instructions. Instructional video also online.

84626104 OUTBACK H-RAIL UPGRADE KIT

84625312 PA 12 H-RAIL UPGRADE KIT

84625314 PA 14 H-RAIL UPGRADE KIT

For other kayaks or for just about any application add 9" and 21" straight H-Rails anywhere you like! Kits come with H-Rail tubes, end fittings and attachment hardware.

84626001 H-RAIL BOLT ON RAIL KIT 9"

84626101 H-RAIL BOLT ON RAIL KIT 21"

HOBIE H-RAIL SYSTEM

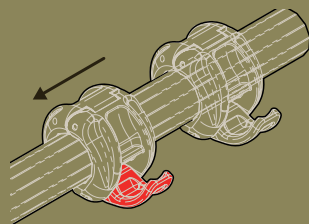

ADJUSTABILITY IS ELEMENTARY.

Attaching, removing and adjusting H-Rail accessories is literally as easy as one, two, three.

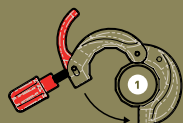

1. Wrap clamp around rail.

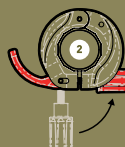

2. Latch gate and tighten.



3. Close locking lever.

H-RAIL RB STARPORT HD

Comes with the popular RAILBLAZA Starport HD with locking slide. Mounts to the 12-sided H-Rail without any drilling or tools needed.

84620204 H-RAIL STARPORT HD



H-RAIL RB MINIPOINT

The Hobie H-Rail MiniPort allows users to fit and re-task the full range of RAILBLAZA accessories to Hobie H-Rails. It clamps to the 12-sided H-Rail without any drilling or tools needed.

84620202 H-RAIL MINIPOINT



H-RAIL SCOTTY DECK/SIDE

We adapted this popular Scotty mount to fit our 12-sided H-Rail without any drilling or tools needed.

84620154 H-RAIL SCOTTY MOUNT



H-RAIL SCOTTY GEAR HEAD

H-Rail Gear-Head quickly slides into place and locks down your post mounted Scotty rod holders and accessories. This system allows you to quickly change rod holder positions with a simple "twist".

84620152 H-RAIL GEAR HEAD



H-RAIL MINI TACKLE BIN

The H-Rail Mini Bin packs serious utility! It's slim and rugged design features a built-in 42" retractable gear tether, a tool holder for pliers or fish grips, four clip points for leashing down gear and raised drain channels in the floor so your gear won't ever sit in water. Four mounting locations for its integrated H-Rail clamp allows for a variety of orientations, giving you the flexibility to mount the bin just about anywhere you've got an open section of H-Rail. Perfect for holding the tools you need close to hand including your VHF radio, cell phone, packs of soft plastics or a digital camera for those fishing CPR tournaments. Overall dimensions: 9" L x 3" W x 4" T; bin dimensions: 5" L x 3" W x 4" T.

84623004 MINI TACKLE BIN / H-RAIL



H-RAIL TACKLE BIN

Add more storage or hold more gear. Designed to hold fishing tackle boxes, the tackle bin also includes a removable tray, Bungee® retainers, and plenty of places to clip things to. Store tools and use it as a place to collect odds and ends that usually clutter your fishing area.

84623001 TACKLE BIN / H-RAIL

84624011 REPLACEMENT TRAY



H-RAIL CUP HOLDER

Always have your favorite beverage conveniently located and secure.

84621001 CUP HOLDER / H-RAIL



H-RAIL MOUNTING PLATE

Mount almost any accessory to the H-Rail using this universal mounting plate. It's durable, easy to drill through and flat on the top and bottom, allowing bolts, nuts and washers to fit snugly.

84622001 MOUNTING PLATE / H-RAIL



H-RAIL G-HOLD

Secure paddles, push poles, nets, gaffs or anything of moderate size up to 2 inches in diameter. The flexible quick-release strap has two securing points for security of minimum and maximum diameters, providing strong retention. It clamps to the 12-sided H-Rail without any drilling or tools needed.

84620200 H-RAIL G-HOLD



H-RAIL MIGHTY MOUNT

Use it to attach your track mounted accessories. Use it as a standalone mount to secure your VISICarbon Pro™. Use it with the brand new Screwball™ or the Panfish™ camera pole.

84620153 H-RAIL MIGHTY MOUNT



H-RAIL RAM® MOUNTS

Add your favorite accessories to RAM Mounts on the H-Rail using the 1" or 1.5" ball.

84620101 MOUNT 1" RAM BALL / H-RAIL

84620151 MOUNT 1-1/2" RAM BALL / H-RAIL



H-RAIL ROD RACKS

Designed for horizontal rod storage. Padding on the interior protects your investment, plus rod retainers secure your rods in position for easy access, surf landings or transport. When rotated, the Rod Rack can be used for storing other accessories like a paddle, sail or stakeout pole.

84625001 ROD RACK / H-RAIL



H-RAIL ROD HOLDER

The H-Rail Rod Holder clamps to Hobie's H-Rail making it easily adjustable along the H-Rail or rotated to a desired angle inboard or outboard. A second lever allows the rod tube to be rotated at angles forward to aft. The rod holder can be clamped facing inboard or outboard depending on the desired use. It's a tube design with a removable gimbal pin and a reel holder that can be rotated to orient baitcasting or spinning rods into the perfect position. The two oversized padeyes can be used for rod leashes or to secure the rod holder to the boat and prevent it from slipping under high loads. Hobie always recommends using a rod leash and suggests the 72020099 Strap Kit to secure the rod holder in position for big game trolling.

72020098 ROD HOLDER / H-RAIL

72020099 HD STRAP KIT



DLX MOUNTING BOARD KIT - PRO ANGLER

2018 Pro Angler Deluxe Mounting Boards feature a built-in, center loading accessory track, knife holder, pliers holder and clip points for leashing gear. We've also given the topside a textured finish to increase friction with track mounted accessories. Installs simply and securely to pre-2018 model year Pro Anglers using included hardware.

84502121 DLX MOUNTING BRD KIT - PRO A



HOBBIE HORIZONTAL ROD HOLDER KIT

Keep your fishing rod secure and protected along the side of your kayak. Insert the rod tip into the tip protector and lock the rod handle into the clasp. Easy to install using the provided hardware. Choose either through-bolts or sheet metal screws. Fits any kayak. Patent Pending.

72021060 HORIZONTAL ROD HOLDER KIT

ADJUSTABLE ROD HOLDER

Fits into Hobie's molded-in rod holders and fastens to the boat using 2 straps and padeyes (included). Release the lever to adjust the angle of the rod holder. Allows you to adjust the angle of their rod so it is best suited for the fishing situation. It is a tube design with a removable gimbal pin and a reel holder that can be rotated to orient baitcasting or spinning rods into the perfect position. The two oversized padeyes can be used for rod leashes. Extremely popular with anglers who like to troll. Hobie recommends using a rod leash to tether your rod to the kayak when fishing for big game.

72020074 ADJUSTABLE ROD HOLDER



HOBBIE ROD HOLDER EXTENSIONS

These fit right into the molded-in rod holders and offer a larger diameter sleeve that is deeper. Keep your fishing rods secure and reels higher out of the water. Leash the holder extension to the boat and the rod to the holder using the molded eyes.

72020014 ROD HOLDER EXTENSION



HOBBIE ROD LEASH

Secure the rod leash to boat and rod. Quick snap connection feature allows easy detachment when needed. Webbing construction with quick connect hook.

74052001 ROD LEASH - WEBBING



HOBBIE GEAR KEEPER

Keep your equipment onboard with Hobie Gear Keepers. These low force retractor tools are ideal for gear such as pliers, dykes, lipper tools etc.

72020000 SMALL HOBBIE GEAR KEEPER

Features: 36" 50lbs Breaking Strength Spectra Nylon Line, Plastic Snap Clip, 3/8" Quick Connect Split Ring.

72020001 LARGE HOBBIE GEAR KEEPER

Features: 36" 60 lbs. Breaking Strength Nylon Coated Stainless Steel Cable, Stainless Steel Spring and Hardware, Plastic Snap Clip.



72020000



72020001





RAM

The revolutionary universal ball and socket mounting system that allows you to mount practically anything anywhere.



72023051 RAM TUBE 2008
ROD HOLDER 1.5 BALL



72023049 RAM TUBE
JR HOLDER 1.5 BALL



72023050 RAM ROD 2000
ROD HOLDER 1.5 BALL



72023048 RAM ROD 2007 JR.
FLY ROD HOLDER 1.5 BALL

RAM CAMERA MOUNT

**Comes disassembled - requires glueing (PVC cement)*



72023032
CAMERA MOUNT
18" ARMS (PAIR)



72023033
RAM SMALL ROUND BASE
1/4"-20
1" BALL

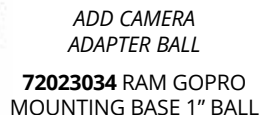

72023033
RAM SMALL ROUND BASE
1/4"-20
1" BALL

ADD CAMERA
ADAPTER BALL

72023035
Fits 1" Ball



RAM TRANSDUCER ARM MOUNT

Compatible with all transducers which attach using a 1/4" bolt. An 18" rigid aluminum rod can be bent to position your transducer to its optimum location. Patented socket technology allows for quick raising, lowering, removal and stowage of transducer arm. Transducer not included with purchase.

72023035 RAM 18" MOUNT
TRANSDUCER



72023056
RAM X-GRIP UNIVERSAL
HOLDER W/ 1" BALL ARM

H-RAIL RAM® MOUNTS

Add your favorite accessories to RAM Mounts on the H-Rail using the 1" or 1.5" ball.

84620101 MOUNT 1" RAM BALL / H-RAIL

84620151 MOUNT 1-1/2" RAM BALL / H-RAIL



The RAM Tough-Claw™ is the perfect mounting base for quick and easy tool-less installation and removal on round, square, odd shaped rails and bars.



ACCESSORY TUBE WEDGE MOUNT (ALSO FITS SCOTTY)
1" or 1.5" BALL (1.5" Shown)

72023016 1" BALL
72023015 1.5" BALL



RAM SMALL TOUGH CLAW
Clamping range .625" to 1.5"
72023064 w/1" BALL
72023065 w/1.5" BALL

RAM LARGE TOUGH CLAW
Clamping range 1" to 2.25"
72023066 w/1" BALL
72023067 w/1.5" BALL



72023045 RAM BASE 1"
BALL ROUND 2 7/16"



72023044
RAM BASE 1" DIAMOND
2 7/16" X 1 5/16"



72023046
RAM BASE 1.5" BALL 2" X 2.5"



72023058
RAM 1" TRACK BALL
72023059
RAM 1.5" TRACK BALL



RAM TRACK BALL QUICK RELEASE
72023062 1" BALL
72023063 1.5" BALL

RAM ROD HOLDERS / MOUNTS / BASES / ARMS

72023015 RAM MAST-TUBE WEDGE MOUNT 1.5"

72023016 RAM MAST-TUBE WEDGE MOUNT 1"

72023019 RAM DBL 1" BALL SOCKET ASSEMBL

72023032 RAM CAMERA MOUNT ARMS

72023033 RAM SMALL ROUND BASE 1/4"-20

72023034 RAM GOPRO MOUNTING BASE 1"

72023035 RAM 18" TRANSDUCER MNT

72023036 RAM 10" POST EXTENSION ARM 1.5

72023042 RAM BOND A BASE - INFLAT/GREY

72023044 RAM BASE 1" DIAMOND 2 7/16" X

72023045 RAM BASE 1" BALL ROUND 2 7/16"

72023046 RAM BASE 1.5" BALL 2" X 2.5"

72023047 RAM DBL BALL SOCKET ARM 1.5" P

72023048 RAM ROD 2007 JR. FLY ROD HOLDER

72023049 RAM TUBE JR HOLDER

72023050 RAM ROD 2000 ROD HOLDER

72023051 RAM TUBE 2008 ROD HOLDER

72023056 RAM X-GRIP UNIVERSAL HOLDER W/

72023058 RAM 1" TRACK BALL

72023059 RAM 1.5" TRACK BALL

72023062 RAM 1" TRACK BALL QUICK RELEAS

72023063 RAM 1.5" TRACK BALL QUICK RELE

72023064 RAM SM TOUGH CLAW w/1" BALL

72023065 RAM SM TOUGH CLAW w/1.5" BALL

72023066 RAM LG TOUGH CLAW w/1" BALL

72023067 RAM LG TOUGH CLAW w/1.5" BALL



72023036
RAM 10" POST
EXTENSION
ARM 1.5"



72023047
RAM DBL BALL SOCKET ARM
1.5" BALL / PLASTIC



72023019
RAM DBL SOCKET ARM
1" BALL



72023042
RAM BOND A BASE - WHITE
ONLY FOR 1" BALL MOUNTS -
INCLUDES FASTENERS AND GLUE



RAILBLAZA

Diverse, flexible and user-friendly mounting systems and accessories. Your StarPort™ can be mounted just about anywhere! Then add the desired accessories to mount onto the starport

STARPORT

The StarPort allows users to fit and re-task the full range of RAILBLAZA accessories. The StarPort can be used as either a deck mount or flush mount base. This base not only comes with a gasket and cap, but also features a slide locking mechanism to confidently lock the RAILBLAZA accessory in place. Stainless Steel mounting hardware included.

72026207 RB STARPORT BLACK



MINIPORT TRACMOUNT

The RAILBLAZA MiniPort TracMount is designed to fit industry standard gear tracks, and installs without tools. Re-positioning the MiniPort along the track is as simple as turning counter-clockwise to release the tension, sliding into the desired position and turning clockwise to secure the mount. NOTE: All single mount track bases are designed for use in light duty applications, and must be mounted on the starboard side if used with trolling.

72026213 RB MINIPORT TRACMOUNT



FIXED EXTENDER

The Fixed Extender gives you 5 inches of clearance from the StarPort – an optimum distance for freeing up the cockpit and creating additional leg room on kayaks.

72026211 RB 5" FIXED EXTENDER



AKA STARPORT MOUNT

AKA StarPort Mounts allow the easy attachment of a RAILBLAZA StarPort to your Hobie AKA (V2). The StarPort Mount is designed to fit securely on the AKA of an Island or Tandem Island without twisting.

72026210 RB RAILMNT AKA STARPORT COMB



STARPORT HD

The base combines the strength of a deck mount with the cosmetic appeal and practicality of a flush mount. The StarPort HD can also be mounted on many popular track systems. Versatility of tool-free adjustment. Stainless Steel mounting hardware included. Want a tool-free and centrally mounted lockable mount on your kayak track? The StarPort HD can achieve this with the addition of the StarPort HD TracMount Kit 72026212.

72026208 RB STARPORT HD BLACK



H-RAIL READY!

H-RAIL STARPORT HD

Mount the Hobie H-Rail StarPort HD on the 12-sided H-Rail without any drilling or tools needed.

84620204 H-RAIL STARPORT HD



H-RAIL MINIPORT

Mount the Hobie H-Rail MiniPort on the 12-sided H-Rail without any drilling or tools needed.

84620202 H-RAIL MINIPORT



H-RAIL G-HOLD

Secure paddles, push poles, nets, gaffs or anything of moderate size up to 2 inches in diameter. The flexible quick-release strap has two securing points for security of minimum and maximum diameters, providing strong retention. It clamps to the 12-sided H-Rail without any drilling or tools needed.

84620200 H-RAIL G-HOLD



ROD HOLDER II

Hold a bait caster, spinning rod, trolling rod, or fly rod. The rotating collar secures rod in place and the rear gimbal lock reduces rod rotation for compatible rods. Also offered with the StarPort HD mount (Stainless Steel mounting hardware included with 72026209 Rod Holder II / StarPort HD).

72026200 RB ROD HOLDER II ONLY BLACK

72026209 RB ROD HOLDER II WITH STARPORT HD



G-HOLD 50

The G-Hold 50 is recommended to secure paddles, boga grips and anything of moderate size up to 2 inches around. The flexible quick-release strap has two securing points for security of minimum and maximum diameters, providing strong retention. G-Holds install in any RAILBLAZA base.

72026202 RB G-HOLD 50MM(2") SINGLE BLK



GUNHOLD

The RAILBLAZA GunHold allows you to safely stow and transport your rifle or shotgun. The flexible rubber fingers shape to fit different gun butts and the strap secures the shotgun/rifle against vibration and damage. The GunHold is compatible with all RAILBLAZA Bases and can be used on ATVs, kayaks, boats, SUPs, and all other hunting vessels.

72026203 RB GUNHOLD (EA)



CAMERA MOUNT KIT

With the RAILBLAZA Camera Mount Kit, you can securely mount your camera on your kayak, paddleboard, or many other surfaces by simply making it StarPort compatible. The kit is compatible with any camera featuring a 1/4-20 thread insert while also including a GoPro tripod adaptor to make the kit compatible with all GoPro cameras.

72026205 RB CAMERA MOUNT KIT



RAILBLAZA ROD HOLDERS / MOUNTS

72026200 RB ROD HOLDER II ONLY BLACK

72026201 RB ROTATING PLATFORM 102MM(4")

72026202 RB G-HOLD 50MM(2") SINGLE BLK

72026203 RB GUNHOLD

72026204 RB CAMERABOOM 600 PRO SERIES

72026205 RB CAMERA MOUNT KIT

72026206 RB BLACK RIBPORT / STARPORT W/

72026207 RB STARPORT BLACK

72026208 RB STARPORT HD BLACK

72026209 RB ROD HOLDER II STARPORT HD K

72026210 RB RAILMNT AKA STARPORT COMB B

72026211 RB 5" FIXED EXTENDER

72026212 RB STARPORT HD TRACMOUNT KIT

72026213 RB MINIPOINT TRACMOUNT

72026214 RB VISIBILITY KIT II

84620200 H-RAIL G-HOLD

84620202 H-RAIL MINIPOINT

84620204 H-RAIL STARPORT HD

VISIBILITY KIT II

The RAILBLAZA Visibility Kit II is a must-have safety item for any kayak angler or recreational paddler. The Visibility Kit II meets US Coast Guard 2 Nautical Mile regulations, and disassembles when you're finished to be stored just about anywhere. The i360 light portion can be fitted to any RAILBLAZA StarPort around the kayak. The Extenda Pole 1000 portion can be used to display a flag, or combine with RAILBLAZA camera mounts as a camera pole.

72026214 RB VISIBILITY KIT II



CAMERA BOOM 600

The Camera Boom 600 is the perfect way to hold the camera and capture the action. Capturing your adventure from the perfect angle is now made easy. Over 30 inches long and fully adjustable with 4 moving joints, capturing any angle is possible. This camera mount will fit into any RAILBLAZA StarPort.

72026204 RB CAMERABOOM 600 PRO SERIES



ROTATING PLATFORM

The Rotating Platform allows for 360 degrees of rotation, easily clips in and out of your StarPort. Perfect for mounting fish finders, cameras, or other electronics.

72026201 RB ROTATING PLATFORM 102MM



STARPORT HD TRACMOUNT KIT

Want a tool-free and centrally mounted lockable mount on your kayak track? The StarPort HD can achieve this with the addition of the StarPort HD TracMount Kit. This is the StarPort of choice for heavy-duty applications such as trolling or mounting heavier gear.

72026212 RB STARPORT HD TRACMOUNT KIT



I-SERIES BASE

Expand the rigging capabilities of inflatables, stand up paddleboards or coolers (without drilling). The i-Series Base allows the addition of useful StarPort attachments. The 6x4-1/2 inch base is easily applied to any flat surface with the included 3M backing adhesive.

72026206 RB BLACK RIBPORT / STARPORT



FOR ALL ITEMS WITH POLYCARBONATE LOCKING SLIDE;

IMPORTANT: Use of petroleum based lubricants on the StarPort slide will cause failure. Silicone based products are best suited (please check contents of lubricant before using).



SCOTTY

Innovative designs and many versatile mounting options, we're sure you'll find the exact combination you're looking for. Scotty Rod holders were designed with one major purpose in mind: Fight the fish, not the fishing gear!



BAIT CASTER

Holds a bait caster reel in a cushioned cradle. A slot in the front of the rod holder allows for a spinning reel to be securely held in position. The rod holder design has a side mounted flange, which leaves the bottom open. This allows for the rod holder to accommodate trigger grips. Pistol grip rod butts easily clear the sides of the rod holder for quick rod retrieval. Rod can be secured in holder with a soft latching strap which snaps over the top. Mount not included.

80048011 BAIT CASTER ROD HOLDER

ROCKET LAUNCHER

Fully Adjustable rod holder, composite construction, accommodating all rods. Mount not included.

80048015 ROD HOLDER ROCKET LAUNCHER

FLY ROD HOLDER

Allows hands free trolling with a fly rod. Fully adjustable and includes a safety strap. Fly Rod Holder Interior Diameter: 1.16" Mount not included.

80055011 FLY ROD HOLDER



RODMASTER II

Fibre reinforced engineering nylon offers strength, resilience and reliability. Also comes with a removable gimbal pin. Mount not included.

80048014 ROD HOLDER RODMASTER II



72020051

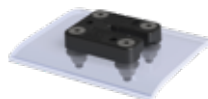

72020052

MIGHTYMOUNT™

Use it to attach your track mounted accessories. Use it as a standalone mount to secure your VISICarbon Pro™. Use it with the brand new Screwball™ or the Panfish™ camera pole.

72020051 W/ MOUNT HDWR

72020052 SCOTTY KIT W/HDWR

FLUSH MOUNT

Sealed base for watertight applications (such as kayak decks). For all Scotty post mount rod holders. Dimensions: 4" x 2" x 2", Bolting Dimensions: 1 5/16" x 3 3/16"

80049011 FLUSH MOUNT W/HDWR



DECK / SIDE MOUNT

1.16", Mount Dimensions: 4" x 2" x 2", Bolting Dimensions: 1 5/16" x 3 3/16"

80052011 DECK / SIDE MOUNT W/HDWR

H-RAIL SCOTTY DECK/SIDE

We adapted this popular Scotty mount to fit our 12-sided H-Rail without any drilling or tools needed.

84620154 H-RAIL SCOTTY MOUNT



ADJUSTABLE EXTENDER 6.5"

Easier access to your rod and reel. Extends the height of the rod holder by 6 1/2", allowing for faster access when that fish strikes. Allows angle adjustments. Made from super tough re-enforced nylon. Works with Scotty post mount rod holders

80048010 ROD HOLDER HEIGHT EXTENDER 6.5"



CAMERA MOUNT

The Scotty Portable Camera Mount is fully twistable, turnable, rotatable, and best of all, instantly portable. Locks down a standard camera or sports cam without needing a special adaptor.

80048020 CAMERA MOUNT POST - SCOTTY



LOW PROFILE TRACK

The lowest profile track on the market and a top load design allows for quick and easy setup of all your Scotty Rod Holders and Accessories (Mount using #10 x 3/4" PHSMS)

80048021 TRACK, 1" LOW PROFILE SCOTTY.

80048022 TRACK, 4" LOW PROFILE SCOTTY

80048023 TRACK, 8" LOW PROFILE SCOTTY

H-RAIL GEAR HEAD

H-Rail Gear-Head quickly slides into place and locks down your post mounted Scotty rod holders and accessories. This system allows you to quickly change rod holder positions with a simple "twist".

84620152 H-RAIL GEAR HEAD



GEAR HEAD TRACK ADAPTER

Gear-Head Track Adapter quickly slides into place and locks down your post mounted Scotty rod holders and accessories. This system allows you to quickly change rod holder positions with a simple "twist". Designed to fit all kayak track systems.

80048007 GEAR HEAD TRACK ADAPTER



GEAR HEAD MOUNT

Quick and Easy, Drop and Lock System. Allows you to secure and re-position your rod holder with just a twist. Use in conjunction with an extender to bring your rod closer to you.

80048006 GEAR HEAD MOUNT

SCOTTY ROD HOLDERS / MOUNTS

80048011 Rod Holder - Bait Caster

80055011 Rod Holder - Fly Rod

80048014 Rod Holder ROD MASTER II

80048015 Rod Holder Rocket Launcher

80048006 Gear Head Mount

80048007 Gear Head TRACK ADAPTER

80052011 Mount - Deck / Side W/HARDWARE

80049011 Mount - Flush W/HARDWARE

80048009 BACKING PLATE / HARDWARE

80048010 ADJUSTABLE EXTENDER 6.5"

80048020 CAMERA MOUNT POST - SCOTTY

80048021 TRACK, 1" LOW PROFILE SCOTTY

80048022 TRACK, 4" LOW PROFILE SCOTTY

80048023 TRACK, 8" LOW PROFILE SCOTTY

HUNTING

GUN MOUNT for your kayak.

Mounts to kayak rail for easy access.

72020013 GUN MOUNT



GUNHOLD

The RAILBLAZA GunHold allows you to safely stow and transport your rifle or shotgun. The flexible rubber fingers shape to fit different gun butts and the strap secures the shotgun/rifle against vibration and damage. The GunHold is compatible with all RAILBLAZA Bases and can be used on ATVs, kayaks, boats, SUPs, and all other hunting vessels.

72026203 RB GUNHOLD (EA)

Choose an appropriate RailBlaza base Page 32-33





HOBIE STAKE-OUT POLE

Hold position in shallow water by inserting the Hobie Stake-Out Pole into sand or mud. Fiberglass pole with metal tip, rubber grip handle and attachment line system.

(Connect to the Hobie Anchor Trolley System for best results)

72076001 STAKE-OUT POLE

HOBIE ANCHOR TROLLEY KIT

Easily deploy your anchor, drift chute or stake out pole over the side of the cockpit area, then move the attachment position forward or aft to hold your boat in the position desired. Easily sit facing down stream / wind at anchor. Simple pulley system and cleat allows adjustment all along one side of your boat anywhere from bow to stern. PA 12 and 2013+ PA 14s are "Trolley Ready" with molded-in fittings to mount the turning blocks.

72020073 TROLLEY KIT - TROLLEY READY or THROUGH BOLT

72020273 TROLLEY KIT - WELLNUT / COMPASS/DUO/OUT19/PASSPORT



PARKNPOLE LINK, 3 PIECE 12' STAKEOUT / PUSH POLE

A floating stakeout / push pole with lots of great features. Lightweight and incredibly durable. Simply remove the middle section and go from a 12' push pole to an 8' stakeout pole, or break down for easy transport to and from the water.

72020131 PARKNPOLE LINK 3PC 12'



ANCHOR KIT

3.5 pound folding anchor, bag and 60 feet of line. (Connect to the Hobie Anchor Trolley System for best results)

80035A ANCHOR



HOBIE DRIFT CHUTE

Large cone shaped "para" chute deployed in the water slows your drift in windy conditions when anchoring is not possible or desired. Design keeps chute just under the surface and fully inflated. Anchor line not included. (Connect to the Hobie Anchor Trolley System for best results)

72020009 DRIFT CHUTE



POWER-POLE

Fast and secure anshoring for Hobie Pro Angler, Outback and Compass; Power-pole, mount and power supply! Easy as... 1 - 2 - 3!

1 - POWER-POLE MICRO AND SPIKE

Includes Micro Driver Unit and 8ft UL Spike. This all-electric unit is extremely quiet and easy to use. It works with a 3/4" spike to stop and anchor your kayak at the push of a button. It functions as a conventional stakeout pole or shallow water anchor without having to manually deploy it yourself. When the wind and water are moving, you won't be. With Power-Pole's signature strong hold, the Micro gives you a smooth stop on the spot in seconds. Whether you're anchored in sand, rock or mud - it's swift, silent, and secure.

72020083 POWER-POLE MICRO AND SPIKE

(Mounting requires Hobie mounting kits to properly distribute loads. Not approved for use on other Hobie models at this time)



2 - MOUNT KIT

Attach a Power-Pole Micro to the stern of your Hobie using the hardware and mounting plate that comes in this kit.

72020176 Pro Angler

72020138 Outback 2019

72020175 Compass



2 - OUTBACK MOUNT KIT

This Yakattack adaptor plate is specifically designed to stern mount a Power-Pole Micro to a <=2018 Hobie Outback. The offset mount allows for use with the rudder. Hardware included.

72020132 OUTBACK MOUNT KIT

or ...



3 - LITHIUM BATTERY PACK

The Micro Battery Pak is not just any battery pack; it utilizes advanced Lithium-Ion technology to ensure the longest performance while maintaining the highest built-in safety standards. Delivering a minimum of 100 cycles per charge, it can easily handle a full day of excitement on the water. The Micro Battery Pak includes battery pack, mounting harness, AC wall adapter, and charger.

72020185

3 - HOBIE POWER KIT

Power up your Power-Pole Micro using this Hobie kit. Kit includes 12V battery, charger, battery holder, and all of the wire plugs, adapters and connectors.

72020076

INDIVIDUAL PARTS / SPARES:

POWER-POLE MICRO ANCHOR MOTOR Micro Driver Unit includes wireless remote control, advanced wireless dash switch, mounting hardware, fully adjustable mounting bracket, electrical cord/plug/ battery terminals, quick release cord, free app (Android), USB Connector, and Bluetooth

72020084 POWER-POLE MICRO ANCHOR MOTOR

72020085 8 ft SPIKE - POWER-POLE MICRO

72020079 6 ft SPIKE - POWER-POLE MICRO

MOUNT PLATE For Pro Angler 12/14/17T

72020177 POWER-POLE MOUNT PLATE ONLY



- 1 - CHOOSE A FISHFINDER...**
2 - CHOOSE A MOUNT... CHOOSE A BASE...
3 - CHOOSE AN INSTALLATION KIT

FISHFINDER HOOK2 4X GPS

Great for kayaks, the compact HOOK2 4x GPS features proven Broadband Sounder™ and a basic GPS plotter. If basic navigation is all you need, the simple and accurate GPS plotter of the HOOK2 'x' models let you add waypoints, follow trails and navigate to your favorite fishing spots. (*'x' models do not support add-on mapping such as C-Map).

Compatible FF Mount 72023060 RAM 1"

72020208 HOOK2 4x GPS



HOOK2 5 SPLITSHOT

The versatile Hook2 5 SplitShot pairs wide-angle Broadband Sounder™, High CHIRP and DownScan Imaging™ with built-in mapping. This 2-in-1 sounder fits the needs of most fishing trips. Track baits, mark fish, and identify structure under your kayak. The Hook2 5 SplitShot will help narrow your search for productive water features like ledges, points or drop-offs with a bird's eye view of 1-foot contours on more than 3,000 lakes.

Compatible FF Mounts 72023060 RAM 1" or 72023061 RAM 1.5"

72020209 HOOK2 5 Splitshot



HOOK2 7 SPLITSHOT & TRIPLESOT

The 2-in-1 SplitShot version pairs wide-angle Broadband Sounder™, High CHIRP and DownScan Imaging™ with built-in mapping. TripleShot gives you all that, PLUS SideScan imaging for scanning large areas around you. Track baits, mark fish, and identify structure under and around your kayak. The Hook2 7 SplitShot or TripleShot will help narrow your search for productive features like ledges, points or drop-offs with a bird's eye view of 1-foot contours on more than 3,000 lakes. Compatible FF Mount 72023055 RAM 1.5" for HDS

72020210 HOOK2 7 SplitShot

72020211 HOOK2 7 TripleShot



72020221 C-MAP INSIGHT PRO

Coverage of the entire US Inland and Coastal on a single SD card without any download required.

72020222 POINT-1 GPS ANTENNA

The ideal position and heading device. The Point-1 provides extremely accurate and rapid boat position and speed updates.

72020127 NMEA2000 STARTER KIT

HOOK2 9 SPLITSHOT & TRIPLESOT

Big screens give you better target separation, allowing you to see exactly what's what in the water column. The 2-in-1 SplitShot version pairs wide-angle Broadband Sounder™, High CHIRP and DownScan Imaging™ with built-in mapping. TripleShot gives you all that, PLUS SideScan imaging for scanning large areas around you. Track baits, mark fish, and identify structure under and around your kayak. The Hook2 9 SplitShot or TripleShot will help narrow your search for productive features like ledges, points or drop-offs with a bird's eye view of 1-foot contours on more than 3,000 lakes.

Compatible FF Mount 72023055 RAM 1.5" for HDS

72020212 HOOK2 9 SplitShot

72020213 HOOK2 9 TripleShot



ELITE 7Ti2

Featuring support for Active Imaging™, FishReveal™ and built-in US Inland charts and Genesis Live onscreen mapping, the Elite-7 Ti² fishfinder/chartplotter is a small enough footprint to be a perfect fit for kayaks. Elite Ti² packs Active Imaging™, our highest quality sonar ever, FishReveal™, built-in Genesis Live real-time mapping and enhanced screen clarity and target separation. Plus, with features that make your life easier on the water, like an easy-to-use touchscreen, wireless networking, smartphone notifications and trolling motor/Power Pole® integration – Elite Ti² was designed to help you have an easier time finding fish.

Compatible FF Mount 72023054 RAM 1.5"

72020218 ELITE 7 Ti2



ELITE 9Ti2

A larger screen than the 7" version gives you even greater target separation and image clarity. Featuring support for Active Imaging™, FishReveal™ and built-in US Inland charts and Genesis Live onscreen mapping, the Elite-9 Ti² fishfinder/chartplotter is a small enough footprint to be a perfect fit for kayaks. Elite Ti² packs Active Imaging™, our highest quality sonar ever, FishReveal™, built-in Genesis Live real-time mapping and enhanced screen clarity and target separation. Plus, with features that make your life easier on the water, like an easy-to-use touchscreen, wireless networking, smartphone notifications and trolling motor/Power Pole® integration – Elite Ti² was designed to help you have an easier time finding fish.

Compatible FF Mount 72023055 RAM 1.5" for HDS

72020219 ELITE-9 Ti2 TotalScan



Warranty on Lowrance product is handled by Lowrance: <https://www.lowrance.com/help-and-support/warranty-information/>

Transducer Reference chart: "BULLET" indicates a single frequency, skimmer style transducer with GPS. Mounts inside the Lowrance Ready cavity using our factory installed Lowrance Ready mounting plate. "SPLITSHOT" indicates a skimmer style transducer, equipped with High CHIRP and DownScan Imaging, plus detailed GPS mapping. Mounts inside the Lowrance Ready cavity using our factory installed Lowrance Ready mounting plate. "TRIPLESOT" indicates a long, skinny transducer profile, equipped with High CHIRP, DownScan Imaging and SideScan Imaging, plus detailed GPS mapping. Mounts to our Lowrance Ready cavity using mounting kit: **TripleShot Transducer Mount Kit, Hobie Part Number 72020220** incorporates a modified TotalScan Lowrance Ready mounting plate, Tripleshot adapter mount and necessary hardware.

2 - FISHFINDER MOUNTS BY RAM

72023052

72023053
7202305472023060
7202306172023055
FITS HDS

72023052 RAM FISH FINDER BASE W/ 1" ARM
72023053 RAM LOWRANCE BASE W/ 1" ARM
72023054 RAM LOWRANCE BASE W/ 1.5" ARM

72023055 RAM LOWRANCE BASE W/ 1.5" ARM
72023060 RAM LOWRANCE BASE W/ 1" ARM
72023061 RAM LOWRANCE BASE W/ 1.5" ARM

...THEN CHOOSE RAM BASE (PAGE 31)

3 - FISHFINDER INSTALLATION KITS**FISHFINDER INSTALLATION KIT FOR LOWRANCE READY/GUARDIAN**

This kit includes everything you need for wiring up your fishfinder to any Hobie kayak with the "Lowrance Ready" feature. Kit Includes: (Shown with) 12V 9AH waterproof gel cell battery and charger or NOCQUA Lithium battery system, wiring hardware, and battery holder which mounts to the sail / accessory post or in the lip of an 8" twist and seal hatch. (For Passport 12 requires 72026217 Fit Kit).

72020070 KIT WITH GEL CELL (SHOWN)



72020145 KIT WITH LITHIUM PRO POWER

FISHFINDER I-SERIES INSTALLATION KIT

Hobie's plug-and-play option for outfitting your inflatable kayak with a fish finder. This kit includes everything you need to install and power a fish finder on your Hobie iSeries kayak. We've incorporated our Rudder Ready* transducer mounting kit, a custom RAM fishfinder mount extension that attaches to your Vantage seat, a lightweight PRO POWER 12V, 10 amp hour lithium battery, charger and wiring components. Simplifies transducer mounting on inflatable kayaks with wires run externally. *Not suitable for retractable Pro Angler style rudders.

72020143 i-SERIES KIT

**FISHFINDER RUDDER READY INSTALLATION KIT**

Hobie's Rudder Ready fish finder installation kit provides everything you need for wiring up and powering a fishfinder on your rigid kayak without the Lowrance Ready feature. Kit includes Hobie's Rudder Ready* transducer mount, thru-hull plugs, 12V gel cell battery and charger, battery holder, wiring components and zip ties for tidying everything up. *Not suitable for retractable Pro Angler style rudders.

72020144 RUDDER READY KIT

**HOBIE - PASSPORT 12 FISHFINDER FIT KIT**

72026217 FIT KIT

HOBIE - LOWRANCE READY HUMMINBIRD ADAPTER

84505901 ADAPTER KIT, HUMMINBIRD FF

HOBIE RUDDER READY KIT

Hobie's answer for outfitting your inflatable kayak with a fish finder. The Rudder Ready* kit allows you to securely mount a transducer to any kayak with a Twist and Stow style rudder system. Eliminates the need for over-the-side mounting arms, and simplifies transducer mounting on kayaks without the Lowrance Ready feature. *Not suitable for retractable Pro Angler style rudders.

79050306 RUDDER READY KIT

**LOWRANCE® READY TOTALSCAN® PLATE**

The Lowrance Ready TotalScan transducer plate mounts in the same location as the standard Lowrance Ready transducer plate found on your Hobie fishing kayak. This mounting plate leaves the TotalScan transducer free of obstruction, allowing the side imaging technology to function with optimal performance. A protective dome on the front end offers protection against head-on collision damage. *Transducer mounting hardware included.

72020207 LOWRANCE READY TOTALSCAN PLATE



72020220 TRIPLE SHOT KIT WITH PLATEZ

LITHIUM PRO POWER KIT

The perfect lithium ion power source for running your fish finder, GPS and other electronics! Nocqua's 12V, 10Ah Pro Power Kit is lightweight and compact, weighing in at just over 20 oz. It's safe, durable and water resistant and comes with all the components necessary for rigging up an individual device. Kit includes: 12V Lithium ion battery, 110V Charger, 12" connector with open leads, 6" heat shrink tubing and 2 heat shrink butt connectors.



72025010 LITHIUM PRO POWER KIT

HOBIE 12V BATTERY

Waterproof 9AH gel cell 12-volt battery with attached waterproof wiring and connectors, 12-volt battery charger.

72025001 HOBIE 12v BATTERY 9AH

72025002 CHARGER - HOBIE 12v BATTERY



HOBIE 12V BATTERY HOLDER

Hobie's battery holder is versatile! Hang inside an 8" Twist and Seal hatch or mount to the mast / accessory receiver inside the hull.

72025007 HOBIE 12v BATTERY HOLDER



HOBIE THRU HULL WIRING KIT

Hobie thru hull fittings for routing wiring through cockpit area for FishFinders, GPS and more. Includes two through hull fittings with backing nuts, o-rings and one "tree" of adapters for different wire diameters. 3-Way version does not require backing ring for easier installation and allows larger cable end fittings to fit through a larger hole. Has 3 possible cable pass-through points.

86505621 HOBIE THRU HULL WIRING KIT

86505613 HOBIE 3 WAY THRU HULL KIT

ELEC CONNECTOR SET

Set of male / female waterproof plugs with wires and 4 waterproof (silicone filled wire nut) connectors.

72021027 ELEC CONNECTOR SET

72025005 (1) SILICONE FILLED WIRE NUT



HOBIE MIRAGE KAYAK RIGGING STAND

Place your kayak at a comfortable height for preparation of gear or while mounting hardware. Move the rack and boat around easily using a set of plug-in wheels as shown (not included). Multiple options for wheel use depending on your needs. The rack easily disassembles for flat storage. Not recommended for long term storage.

87363222 FLOOR STAND, MIRAGE RIGGING



FLAT MOUNT TRACK KIT

Hobie's Flat Mount track kit provides 12" of track mounting real estate. These tracks are intentionally designed with a slight curvature to match the outline of most Hobie kayaks, allowing them to fit areas where many other gear tracks don't. A great choice for alongside the bow hatch or near the stern. High grade stainless steel thru-bolt hardware is included so you can be confident the track won't budge under load. Dimensions: 14" x 1 5/8".

72026218 FLAT MOUNT TRACK KIT



H-RAIL UPGRADE FOR H-TRACK DLX

Swap out the bungee in the rear H-Track DLX assembly with a second set of H-Rail + Integrated Track! This kit is a breeze to install, and increases no-drill mounting options behind the seat of any 2019 Outback.

Hobie's unique H-Rail with integrated track yields a 17.5" multi-purpose mounting system for light AND heavy-duty applications. Clamp H-Rail rod holders to the rail for heavy-duty trolling, or use the track feature for lighter-duty accessory installations!

72020153 H-RAIL UPGRADE FOR H-TRACK DLX



COMPASS FOOT BRACE KIT

The Mirage Compass is also such a great paddle kayak that Hobie decided to make it "foot brace ready". Foot braces improve the user experience by offering more comfort and power while paddling from a seated position. Current model year Compass and Compass Duo kayaks are outfitted with a brass insert on each side of the cockpit for easy foot brace installation.

The forward end of the Compass/Duo foot braces install to the brass inserts on either side of the cockpit, while the rear end thru-bolts using the included hardware and easy access through the 8" round hatch in front of the seat. The foot pads are easily adjustable to fit riders of various heights, and a trigger lock keeps the foot pad firmly in place while kayaking.

72020150 FOOTBRACE KIT COMPASS/DUO

COOL AND QUIET! HOBIE EVA DECK PAD KITS

These are custom fit to every curve of your Hobie kayak and deliver supreme comfort, traction and sound dampening qualities. The double layered, closed cell foam construction features a brushed finish and is mold, mildew and stain resistant. Applies using a strong peel-and-stick adhesive backing. UV stable in harsh climates. Choose complete coverage from bow to stern or the interior kits that cover just the cockpit and cargo areas.



PA12
AEGEAN/BLUE



PA14
GREEN/ESPRESSO



COMPASS
GREY/CHARCOAL

PRO ANGLER 14 COMPLETE

72020250 GREEN/ESPRESSO
72020251 AEGEAN/BLUE
72020252 GREY/CHARCOAL
72020242 GREY/BLACK 360
72020243 BLACK/GREY 360

PRO ANGLER 14 INTERIOR

72020244 GREEN/ESPRESSO
72020245 AEGEAN/BLUE
72020246 GREY/CHARCOAL

PRO ANGLER 12 COMPLETE

72020253 GREEN/ESPRESSO
72020254 AEGEAN/BLUE
72020255 GREY/CHARCOAL
72020240 GREY/BLACK 360
72020241 BLACK/GREY 360

PRO ANGLER 12 INTERIOR

72020247 GREEN/ESPRESSO
72020248 AEGEAN/BLUE
72020249 GREY/CHARCOAL

OUTBACK 2019+ COMPLETE

72020264 GREEN/ESPRESSO
72020261 AEGEAN/BLUE
72020267 GREY/CHARCOAL

OUTBACK 2019+ INTERIOR

72020263 GREEN/ESPRESSO
72020260 AEGEAN/BLUE
72020266 GREY/CHARCOAL

OUTBACK <=2018 COMPLETE

72020256 GREEN/ESPRESSO
72020257 AEGEAN/BLUE
72020258 GREY/CHARCOAL

COMPASS COMPLETE

72020259 GREY/CHARCOAL



MIRAGE ECLIPSE ACCESSORY BAG

The Mirage Eclipse experience just got even better! Now you can take your essentials along with you by packing them away in this convenient Eclipse Accessory Bag.

Eclipse Accessory Bag Features:

- 3 easy Velcro straps for attachment to the Eclipse handle bar
- Water resistant construction for keeping things dry
- Key tether with YKK snap swivel for extra security
- Interior zipper pouch for organizing smaller items
- Drainage hole in the bottom of the bag to rid water and keep the interior of the bag dry
- Clear visibility window in the top of the bag so you know exactly what you're reaching for
- Dimensions: approx. 8" Tall x 8" Wide x 3" Deep

72020116 ACCESSORY BAG



UNIVERSAL MOUNT & CAGE

Stay hydrated! This awesome mount with water bottle cage allows you to carry a water bottle on the Eclipse handlebar tubing. Adjustable for upper or lower tube size. Quick attachment and removal.

72020504 MOUNT W/BOTTLE CAGE



QUAD LOCK UNIVERSAL PHONE MOUNT

The Quad Lock adapter allows you to mount a phone or small device to Handlebars, H-Rail, H-Bar tubing. Designed for biking, but great for Hobie rail attachment too! Quick 45 degree twist to attach and lock. Release spring lever and turn 45 degrees to remove the device from the mount. Attaches to rails with rubber rings or zip ties that are included in the kit. 3M adhesive adapter attaches securely to your device (water proof cases recommended of course).

72020511 QUAD LOCK



HOBIE SUP / MSUP LEASH

Safety leash worn above your calf leashes you to your board in case you fall off. 8' Coil.
470145-10 HOBIE SUP / MSUP LEASH



SCAN TO GO TO
HOBIE PARTS LOOKUP



PADDLE "T" HANDLE

Convert your kayak paddle to a canoe style paddle. Easier to store on many models of Hobie Mirage kayaks where paddle use is unnecessary while using the MirageDrive. Plugs into the female half of the kayak paddle.

74049001 PADDLE "T" HANDLE

74048 2019 "T" HANDLE



SCAN TO GO TO
HOBIE SUPPORT PAGES



TELESCOPING PADDLE

Measures just 20" in closed position (45" when fully extended). Lightweight, anodized aluminum shaft corrosion resistant design. Floats too! 6 1/2" wide blade will fit into an 8" hatch opening.

3091 TELESCOPING PADDLE



3 PC FIBERGLASS PADDLE

Carry as a spare or emergency paddle. 3 piece easily assembles when needed. Includes carry bag.

P23074075-10 3 PC PADDLE



PADDLE LEASH

Secure a paddle to your boat's bow eye. Keep the paddle with the boat after a capsize. By holding the paddle after a capsize you can also be sure that the boat stays with you and cannot drift away. Web paddle leash is made from hollow webbing and an internal shock cord. Coil leash is elastic plastic coil.

74050001 PADDLE LEASH - WEB 4.5'

74051001 PADDLE LEASH - COIL

HOBIE SAFETY FLAG

New safety flag specially designed for Hobie kayaks. Be seen on the water! A triangle safety orange flag with reflective piping. The flag stands out from the pole without wind. Simple, easy to install and remove from the kayak and at a great low price! This new flag system uses the Hobie threaded fittings as the mount point. Simply remove one of the threaded fittings in the cargo area and install the specially designed flag holder fitting in it's place. The pole is held by a clamping thumb screw. When removing the flag, loosen the thumb screw and pull the pole out of the fitting. The threaded fitting remains in the kayak. The fitting also includes an eye to route the cargo bungee through.

72020108 HOBIE SAFETY FLAG

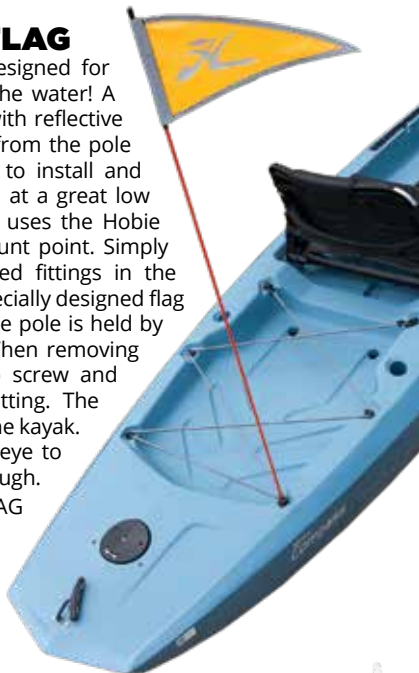

THE VISICARBON PRO™

The VisiCarbon Pro combines a high visibility light and safety flag with a light weight, low drag, and portable style. Insert foam base into molded-in or Live Well rod holders or flag attachment system provides a secure attachment that allows the flag to be removed in seconds. The 48" long VISICarbon Pro™ breaks down to 14" long in seconds. The folded unit can be stored inside the nylon flag which doubles as carry bag. (INCLUDES A "T" BOLT FOR TRACK MOUNTING OR ADD 72020051 MightyMount)

72020040 SAFETY FLAG/LIGHT COMBO



BILGE - HAND PUMP

This light weight bilge pump is extra security for long trips on the water. Features super-comfortable, easy-grip rubber over-molded handle and a high-visibility neon yellow stock for extra safety.

72020032 BILGE - HAND PUMP



SAFETY PACKAGE

72020029 DELUXE KAYAK SAFETY PACKAGE

- 1 **72020010** Hobie Safety Kit
- 1 **72020040** VisiCarbon Safety Flag / Light
- 1 **72020032** Bilge Pump

HOBIE SAFETY KIT

This kit has many useful items for added safety when boating. Hobie Gear Bucket with Orange safety lid. Ready access is assured by hanging the safety kit on the inside lip of an 8" Hobie Twist and Seal hatch. Includes a 33 piece first aid kit, water proof flash light, signal mirror, space blanket, whistle, utility tool, waterproof matches, duct tape, gauze bandage, gauze pads, cloth tape (specific items subject to change).

72020010 HOBIE SAFETY KIT



HOBIE FIRST AID KIT

Waterproof 3600 Plano box with essential first aid items. Fits tackle management rack.

72020078 HOBIE FIRST AID KIT



HYDROSTAR - SOS DELUXE

Everything you need for lighting in one compact waterproof package.

72020003 HYDRO STAR SOS LIGHT

FEATURES:

5 light settings; Magnetic base; Suction cup base; Lanyard clip; Integrated safety whistle; Submersible to 50ft

SPECS / FUNCTION:

- Dimensions: 6in H x 1.25in DIA
- 1 CLICK : 3 LED Light (10LM)
- 2 CLICKS : 3 LED Strobe (15LM)
- 3 CLICKS : 360° Deck Light (Red:6LM/Green 2LM)
- 4 CLICKS : Emergency 1 Watt LED Strobe (65LM)
- 5 SECOND HOLD : SOS Signal (65LM)"



SAFETY WHISTLE

A whistle can save your life! Keep one attached to your PFD in case of overboard emergency. Alert approaching vessels. Alert other boaters or people ashore that you need help.

MK0053 SAFETY WHISTLE

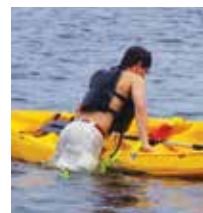

RESCUE STEP

"How do I get back in if I fall out?" The RescueStep features quick and easy installation and operation for vessel re-entry assistance, righting an overturned kayak and can also be used to tow or portage your kayak. Its compact size makes it easy to bring along anywhere you need it.

72020092 RESCUE STEP KAYAK

1266 RESCUE STEP BOAT



HOBIE PET PFDS

You can now take your best friend with you safely and in Hobie Style! Added flotation as a swim assist and grab handles, so you can help them back aboard more easily. Adjustable fit, leash attachment, side pockets, grab handles and soft foam undercarriage support. Happy days for dogs!

FEATURES:

Tri segmented soft foam design; Foam supported Ripstop-nylon collar; Dual cargo pockets (S, M, L, XL); Dual integrated grab handle design (M, L, XL); Soft foam undercarriage support chasis; Integrated leash attachment

- S9000XS** PET PFD XS MANGO <12#
S9000SM PET PFD SM MANGO 12-24#
S9000MD PET PFD MD MANGO 24-60#
S9000LG PET PFD LG MANGO 60-90#
S9000XL PET PFD XL MANGO >90#

SIZING:

SIZE	WEIGHT	COLLAR	BODY GIRTH
XS	12 lbs.	8" - 12"	13" - 17"
S	12 - 24 lbs.	10" - 14"	15" - 21"
M	24 - 60 lbs.	13" - 19"	18" - 30"
L	60 - 90 lbs.	18" - 26"	24" - 36"
XL	90 - 120 lbs.	22" - 30"	30" - 42"



MIRAGE SEAT PAD INFLATABLE "i-COMFORT"

Replaces the older style standard foam seat pad for the Hobie Mirage. Adjust the cushion by adding or releasing air pressure. Not designed for use on Hobie Mirage Inflatable kayaks. Can be used in combination (stacked) on a seat cushion.

72020028 MIRAGE SEAT PAD - INFLATABLE "i-Comfort"



HOOKLESS MAP POCKET

Molded material resists hooking. Replaces standard mesh pockets. Frame and fasteners included.

78565001 MAP POCKET HOOKLESS w/FRAME

78561001 HOOKLESS POCKET ONLY



HOBIE SNIPS

Retractable line cutters.

72020103 SNIPS



FISH GRIP

Handy fish grip in a glow-in-the-dark plastic material.

72020019 FISH GRIP



Includes knob, attachment bolt and cap

STEERING KNOB ASSY

More comfortable hand position - better leverage. Fits all 2011+ Mirage model steering handles and all Tandem Islands. Kit includes attachment screw, knob and cap.

88991355 KNOB ASSY



HOBIE FISHING HAWG TROUGH

Holds the big ones safely for measuring and photos before release. (30in / 76cm)

72020067 HAWG TROUGH IMPERIAL

72020167 HAWG TROUGH METRIC

ACCESSORY PACKAGES

72020024 MIRAGE PERFORMANCE PACKAGE

- 1 72066001** V2 ST TURBO FIN KIT
1 81397001 LARGE TWIST AND STOW RUDDER



72020029 DELUXE KAYAK SAFETY PACKAGE

- 1 72020010** HOBIE SAFETY KIT
1 72020040 VISICARBON SAFETY FLAG / LIGHT
1 72020032 BILGE PUMP

CLEAN AND PROTECT!

HOBIE MULTI-LUBE

A planet-safe lubricant recommended for lubricating MirageDrives and many other uses. Environmentally friendly for in-the-water applications. Hobie Multi-Lube offers excellent lubrication, is an anti corrosive coating, great for cleaning and many other uses... use on nearly anything that squeaks, rusts, corrodes or binds up; MirageDrives, rudder drums, cams, fishing reels and more. The 1 oz size is perfect for getting the lubricant into tight spaces by using the needle applicator. The 4 oz size has a spray applicator for coating chains and larger surfaces, shafts and bulky parts. Every Hobie owner should have Hobie Multi-Lube. Be nice to our planet, keep MirageDrives and other components running smoothly and lasting longer without polluting our waterways. Use it for all shop, home and sport lubrication needs.



5120 HOBIE MULTI LUBE 1 OZ

5121 HOBIE MULTI LUBE 4 OZ

SILICONE SPRAY

Dry silicone spray for cleats, hatch O-rings. (Image above may not represent current packaging or volume)

5107 SILICONE 7oz.



HOBIE UV PROTECTANT

Protect and rejuvenate fiberglass, polyethylene, vinyl and PVC materials. Wipe on, the protectant absorbs into the material and leaves a UV protective layer. Reduce the loss of essential oils and deflect the sun's harmful UV rays. 12 oz.

70060001 HOBIE UV PROTECTANT



MAGICA RUST REMOVER

Easily clean rust stains from fiberglass, plastic surfaces, metal parts or fabrics. Although metal parts are made from high quality stainless steel, machining tools often leave carbon particles imbedded in the metal surfaces. This material can bleed a rust stain onto other surfaces. Magica simply dissolves the rust away.

1603 MAGICA GEL 8oz. BOTTLE



TEAR-AID

Each TEAR-AID® repair patch is made from an exceptionally tough, matte finish, abrasion resistant, elastomer that resists puncture and tearing. It is combined with an aggressive adhesive formulated for high bond strength to a variety of surfaces such as canvas, leather, rubber, nylon, most plastics, paints, aluminum, stainless steel, fiberglass, polyurethane, polyethylene, polypropylene, vinyl and vinyl coated. TEAR-AID® Type A and TEAR-AID® Type B provide a simple and easy method of patching holes and tears, as well as an excellent protective film solution.

72020030 TEAR-AID / TYPE A (POLY)

72020031 TEAR-AID / TYPE B (VINYL)



EACH PATCH KIT CONTAINS:

(1) 3" x 12" TEAR-AID® Patch that cuts with scissors to any size, (1) 7/8" x 7/8" Patch, (1) 1 3/8" x 1 3/8" Patch, (1) 12" Reinforcement Filament for repairing tears at edges, (2) Alcohol Prep Pads, (1) Illustrated Instructions and a Product Repair List.

SAIL REPAIR TAPE

Don't get caught with your sails down! Extra strong, Rip Stop white tape for temporary on-the-spot repairs to torn sails, canvas, even foul weather gear. Keep a roll in your toolbox for emergencies.

1662 2" x 25' Roll



CLEAR SILICONE SEALER

Make sure your hulls are watertight! Clear Silicone seals leaks around all thru-hull fittings.

376 1.5oz. TUBE



AQUASEAL MIRAZYME ODOR ELIMINATOR

There's nothing quite like the odor of damp gear left in your car trunk for a couple of days. With one application eliminate those odors from booties, wet-suits, dry-suits and the rest of your gear. A 100% biodegradable product made from a blend of 10 highly specialized, light activated microbial elements. Works by penetrating into pores of fabric, rubber and even hard surfaces to eliminate odor naturally. (Packaging may vary)

7003 8oz.



BARNACLE PLUS BLUETOOTH SPEAKER

Features:

- Waterproof
- Floats
- Stores up to 1,000 songs / 4 GB internal memory
- Industrial suction cup base
- Sand / Dust proof
- Water pressure proof charging port
- Built-in mic & caller ID

Hobie® and Speaqua have partnered up to bring a portable, waterproof speaker into the accessories lineup! This floating, tennis ball sized speaker is both convenient and functional with Bluetooth connectivity, call-taking capability and built-in 4 GB memory for holding up to 1,000 songs. It mounts to any smooth surface using an industrial suction cup base, and is perfect for the kayak, SUP or Eclipse.

72026103 SPEAKER BLUE TOOTH AND 4GB

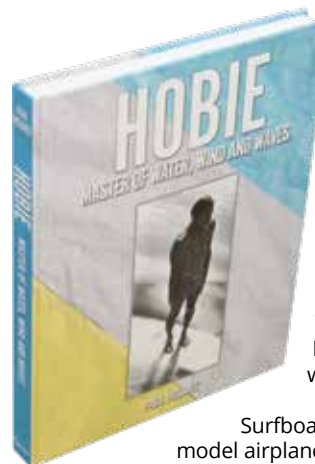

HOBIE-MASTER OF WATER, WIND, AND WAVES

The man, Hobie, known by just one name worldwide, has an epic life story. This 12" x 9" hardcover book shows how it all came to be, and more, in 17 chapters with 300 pages, 120,000 words of text and 585 photographs and illustrations. The book is available through Hobie Cat and Hobie Kayak dealers worldwide.

Surfboards, catamarans and boats, RC model airplanes (the Hobie Hawk), and a whole lot more "toys"—as Hobie himself describes his amazing life's work—will all be celebrated in the biography of the man who defined a lifestyle in surfing and sailing.

87369116 BOOK, HOBIE-MASTER OF WATER, WIND, AND WAVES



LICENSE FRAMES "HOBIE" OR "HOBIE FISHING"

3043 Chrome Hobie

3045 Hobie Fishing

BOOK - FROM PENGUIN WINGS TO BOAT FLIPPERS

Great book about taking ideas from nature to use in products. All about the Hobie Mirage pedal system. Written by Toney Allman from the series "Imitating Nature".

615 Each



STAINLESS WATER BOTTLE

71995001 20oz



HOBIE KEY FLOAT

Don't lose those keys! Keep a few bucks dry, inside the small compartment, while on the water.

72010 Each



HOBIE CROAKIES

Keep your glasses in place! Made from wetsuit fabric that will not stretch or lose shape when wet. Remains secure whether worn normally, raised or lowered around your neck.

1553CR Each

STICKERS See Parts List for Pricing



12451050 / 12451051 24"



36601000 6"
36601011 6"
13001001 12 5/8"



12453023 CHROME BLACK



12453024 12" BLACK
12453025 12" WHITE



12453021 4 1/2"



12453011 4 1/2"



12453031 4 1/2"



79545001 2 3/4"

BOW SHACKLE - THREADED PIN

Part #	Pin Dia.	Width	Length	Max Ld#
SP150061	1/4"	9/16"	15/16"	4400

**"D" SHACKLES - THREADED PIN**

Part #	Pin Dia.	Width	Length	Max Ld#
SP150041	5/32"	3/8"	5/8"	1100
SP150051	3/16"	1/2"	11/16"	2640
SP150052	3/16"	5/8"	15/16"	2640

**SAFETY SHACKLE WITH 1/2 TURN CAPTIVE PIN**

Part #	Pin Dia.	Width	Length	Max Ld#
SP185205	3/16"	1/2"	1"	2640
SP180005	3/16"	5/8"	1 7/16"	2640
SP180006	1/4"	7/8"	1 5/8"	4400

**FAST SHACKLE**

Avibank ball lock pin permanently wired to the shackle so it won't drop in the drink when released.

3062 EACH

**LOW STRETCH LINE**

Pre-stretched line with superior fatigue and abrasion resistance. Sold per foot.

RH112WHT 1/12" WHITE
RH018WHT 1/8" WHITE
RH316WHT 3/16" WHITE
RH014WHT 1/4" WHITE
RH516WHT 5/16" WHITE
RH038WHT 3/8" WHITE



H082



H083



H092



H166



H167

**HARKEN BULLET BLOCKS**

Medium size blocks that work well for control lines. Accepts up to 5/16" line, 2000 pound load, 1 1/8" diameter sheave.

H082 SINGLE

H092 CHEEK

H166 SINGLE w/ SWIVEL

H167 SINGLE w/ SWIVEL & BECKET

H224



H233



H225

**HARKEN MICRO BLOCKS**

Small blocks with high load capabilities, but light weight. Accepts up to 1/4" line, 1200 pound load, 7/8" diameter sheave.

H224 SINGLE

H225 SINGLE w/ BECKET

H233 CHEEK

REMOVABLE SHEAVE BLOCK

Simply remove the clevis pin that acts as the sheave axle, slide the sheave out of the frame, place the frame through the fitting and reinstall the sheave.

3103 EACH

**SUPER STRETCH SHOCKCORD**

This midnight-black shockcord has double the stretch of ordinary cord. If you've been getting your shockcord from the hardware store, you're in for a treat. The durable black cover is woven around an extra-flexible rubber core.

RS018BLK 1/8"

RS316BLK 3/16"

RS014BLK 1/4"

RS516BLK 5/16"

RS038BLK 3/8"

RS716BLK 7/16"

53180011 3/8" HOG RING

21180000 1/2" HOG RING

**SHOCKCORD SNAP HOOKS**

Easy to install shockcord snap hook. No tools required. Reusable!

2101 HOOK-1/4"

2102 HOOK-5/16"

**SPUN DACRON**

Soft matte finish rope. Runs well thru blocks and fairleads, has good abrasion resistance, is spliceable and easy to hold with wet hands. Available in white, black, red, blue.

This rope is not designed for winching. Sold per foot. Specify color choice.

(White, Blue, Red or Black xxx = color)

RM014WHT 1/4" WHITE

RM014XXX 1/4" COLOR

RM516WHT 5/16" WHITE

RM516XXX 5/16" COLOR

RM038WHT 3/8" WHITE

RM038XXX 3/8" COLOR

RM716WHT 7/16" WHITE

RM716XXX 7/16" COLOR

SPECTRA

Rudder Steering and Up / Down control line .

81023001 SPECTRA 1.75 mm



CLEATS

HARKEN CAMMATIC CLEAT

Rounded jaws assure quick cleating/release action and smoother teeth mean longer life for your lines.

H471 MICRO CLEAT, CARBO JAW 1/8" TO 1/4" LINE



HARKEN WEDGES

Fairleads and eyestraps designed specifically for each Cammatic, the wedges put the Cammatic on a 15 degree angle for ease of cleating or releasing. The fairleads are molded into a replacement base. The eyestraps are designed to be held in place over the cam by the mounting screws.

H297 WEDGE KIT

H284 WIRE FAIRLEAD

H281 EYE STRAP

GERBER NEEDLENOSE MULTI-PLIER®

Needlenose pliers, wire cutter, crimper, standard/ metric scale, lanyard ring, cross head screwdriver, bottle/can opener, serrated sheeps foot blade, large, medium, and small flathead screwdrivers, file, drop point blade. Stainless steel construction with a limited lifetime warranty!

83102 GERBER TOOL



HOG RING PLIERS

Cinch rings, hog rings, upholsterers clamp. They are all the same and these are the pliers to crimp them with. Use them on shockcord.

83104 EACH



Extra rod stock available at no charge

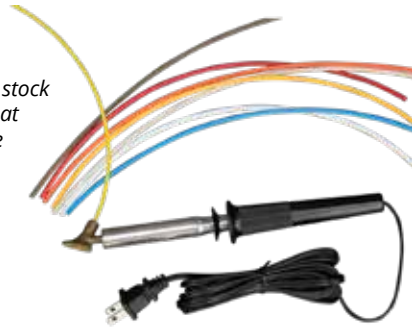

KC WELDER PRO WITH HOBIE COLOR ROD STOCK

200 Watt element, flat tip and a 3/16" hole in tip for rod insertion. Includes a selection of Hobie color welding rod. Fix holes and cracks or customize polyethylene products. Insert the rod into the tip and place against the product to be welded. The tip heats the plastic surface and the rod. As the materials melt, move the tip along the repair area while pushing the rod into the tip to fill the repair area with new plastic material. Plug small holes after moving accessories. Rebuild keels after excessive wear from dragging.

72097001 KC WELDER PRO

STAINLESS STEEL POCKET KNIFE

DELUXE - Marlin spike, knife blade, shackle tool, and screwdriver. 4.0 oz.

1551 DELUXE



TECH TIP!

"WELL NUT" FASTENERS are tubular rubber fittings with an imbedded brass nut in the base. These are similar to a molly screw commonly used in sheet rock. They expand within the structure and give you a virtual backing nut and washer in an area that is inaccessible. Well nuts can be used for mounting many accessories to kayaks. Simply drill a hole as a net-fit dimension for the well nut. Insert the nut and position the hardware to be fastened. Insert and thread in the screw. Tighten until very snug. The brass nut is drawn up against the inside surface of the kayak which expands the rubber to a dimension that is too large to pull through the hole.

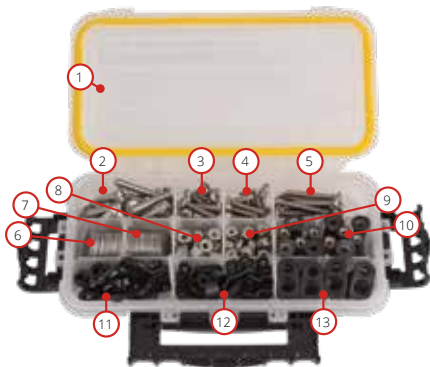

KAYAK RIGGING KIT - HARDWARE

Set of fasteners for rigging a kayak for fishing accessories. Includes stainless bolts, nuts, washers, well nuts and more. All packed in a handy Plano box. You can purchase any of the items separately. Purchase the kit and have it all, or pick and choose your own based on your individual needs. All included parts are listed below as well as many more in the numerical section of our catalog.

72020300 KAYAK RIGGING KIT

Item	Qty	Part	Item
1	1	72020311	PLANO BOX - KAYAK RIG KIT
2	12	8031191	SCREW 1/4-20 X 1-1/4 PHMS
3	12	8030111	SCREW 10-32 X 1 PHMS-P SS
4	12	8030251	SCREW 10-32 X 1" FHMS
5	12	8030161	SCREW 10-32x1 1/2 RHMS-P SS
6	18	8080701	WASHER 1/4 X 1 SS HP
7	24	8080731	WASHER #10 FNDR SS
8	12	8050111	NUT 1/4-20 HX NYLOCK
9	24	8050201	NUT 10-32 NYLOCK LOPRO
10	12	8050221	NUT (WELL NUT) 10-32 x1
11	8	71110001	PAD EYE-BLK NYLON-3/8"
12	18	81029	LINE HANGER
13	8	78510001	BUNGEE HOOK



Our mission remains true to the values set forth by Hobie Alter many years ago: build high quality, high functioning polarized sunglasses that will make getting on the water more fun.

LIFETIME WARRANTY

Hobie Polarized sunglasses are warranted to the original registered purchaser against defects in materials and workmanship for the LIFETIME of the sunglass.



**CLEARER.
SHARPER.
MORE PRECISE.**

POLARIZATION TECHNOLOGY

HOW HOBIE LENSES WORK



Looking into the ocean
without Hobie Polarized Lens



Looking into the ocean
with Hobie Polarized Lens

HOBIE POLARIZED LENS COLORS



HOBIE GREY

Blending green and smoke, this color tint works across any outdoor activity. Hobie Grey lenses are recommended for use in moderate to bright conditions, where minimal contrast enhancement is necessary.



HOBIE COPPER

Hobie Copper lenses enhance color contrast and provide extremely high resolution. Recommended for use in bright and overcast conditions, Hobie Copper allows for heightened perception to colors.



HOBIE SIGHTMASTER

Designed specifically for serious sight fishing. The Sightmaster lens allows you to see the contrast between fish and rocks below the surface of the water. Recommended for low-light, overcast or hazy conditions [not recommended for driving].

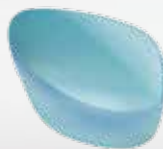

HOBIE COBALT BLUE MIRROR

Cuts blue light to protect your eyes while deep sea fishing. Recommended for extremely bright light conditions. Available with a gray base lens tint.



HOBIE SEA GREEN MIRROR

Providing enhanced color contrast and glare reduction while lightening shadowy areas. Recommended for everyday use but especially useful for conditions with varying light environments and overcast days. Available with a copper base lens tint.

NEW HOBIE FLOATING SERIES

FEATURING MOJO WITH HYDRO 360° LENSES

HOBIE TPX® FLOATING FRAME

Our specialized TPX® frame material is significantly lighter than standard sunglasses, providing extra buoyancy with impact on water. Highly durable and heat-resistant, these frames ensure comfort for long-term wear in any environment.



LENS TECHNOLOGY

EASY TO CLEAN, SCRATCH RESISTANT, AND HYDROPHOBIC | 100% UV PROTECTION | LIFETIME WARRANTY

SPORT COLLECTION

HYDRO 360° PC POLARIZED PROTECTION

The lightweight Injected Polycarbonate HydroClean™ Polarized lenses offer superior optical clarity and 360° of protection through dual-coated layers that repel water, prevent sweat and sunscreen from building up, and are easy to clean.

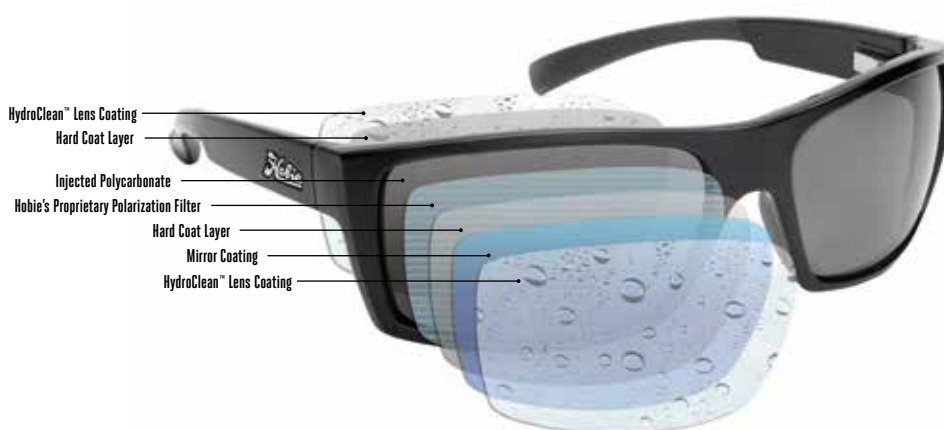

MOTION COLLECTION

HYDROCLEAN™ POLARIZED LENS TECHNOLOGY

The lightweight Injected Polycarbonate HydroClean™ Polarized lenses are for active sports as well as everyday wear. Each lens is comprised of 100% polarized injected polycarbonate: the lightest lens material offered that is virtually shatterproof with hard-coatings for scratch resistance.



FRAME TECHNOLOGY



STYLE SHOWN: BAJA

*TECHNOLOGY VARIES PER COLLECTION AND STYLE

Hobie®



OFFICIAL GEAR FOR LIFE ON THE WATER



**Apparel, Eyewear & Accessories
For Men & Women**

hobie.com

**HOBIE CAT COMPANY**

Holding Company
Oceanside, CA, U.S.A.
1-800-HOBIE-49
hobie.com

HOBIE CAT AUSTRALASIA

Subsidiary
Huskisson, NSW, Australia
1-800-4-HOBIE
hobie.com

HOBIE CAT EUROPE

Subsidiary
Toulon, France
+33 (0) 494 08 78 78
hobie.com

HOBIE KAYAK EUROPE

Independent Distributor
Stellendam, The Netherlands
+31 (0) 187 499 440
hobie.com

HOBIE CAT BRASIL

Independent Distributor
Porto Belo, Santa Catarina, Brasil
+55 (47) 9746-9735
hobie.com



KAYAKING AND ECLIPSE PARTS & ACCESSORIES

INTERNATIONAL 87367054