

# **FLOAT CAT**

# **ROWING KIT**

## **ASSEMBLY AND OPERATIONS MANUAL**

# Hobie Float Cat

## Rowing System Assembly

### Rowing System Parts List

- four footrest hangers: black plastic piece with 1 1/4" and 7/8" holes at 90
- two oarlock frames: tripod hinged 7/8" tubing with receptacle push button
- one footrest: two 48" lengths of 7/8" tubing with strut attachment tabs length 7/8" tubing with connectors & stainless steel screws
- two two piece oars with clips and attached oarlocks
- two lynch pins

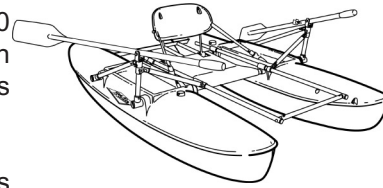

degrees  
inserts  
one 18"

**NOTE:** Right and left references assumes a seated position facing aft.

### Rowing System Assembly Instructions

(Instruction assumes installation after original complete installation)

#### STEP 1- Footrest Hangers

Remove one pontoon from crossbars by pushing in snap buttons and pulling pontoon off. Slide one foot rest hanger onto each crossbar, pointing the longer

off-set end of hanger towards the rear of the floatcat. Slide hanger on other cross bar. Position hangers between snap button and seat. Put pontoon back on crossbars and repeat procedure with other pontoon.

(SEE ALSO: Large Diagrams Pg. 18)

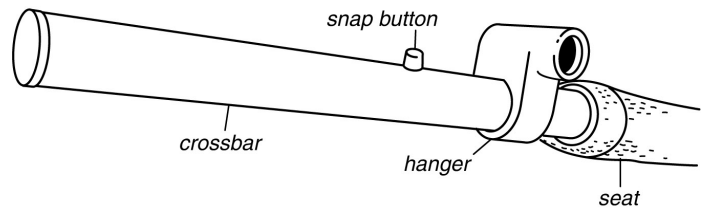

#### STEP 2- Footrest

Locate 18" length of tubing, remove screws and insert plastic end into 1/2" hole in 48' length. Secure with 1 1/2" screw through 1/4" hole, making sure half round seat is completely seated against 48" tubing. When footrest is not inserted into foot rest hangers it should be disassembled; the horseshoe shape allows for substantial leverage and can break.

Insert footrest evenly into 7/8" opening on hangers until all four hangers are supporting the footrest. Adjust footrest to desired length. Secure by inserting lynch pins through holes in footrest and hanger. Snug strut attachment tabs up against footrest hanger.

#### STEP 3- OarLock Frame

Snap hinged oarlock frame into receptacles on sides of pontoons with the short upright tube in receptacle nearest the stern and the long tube nearest the bow. Attach strut to strut attachment tab with screw and nut supplied.

#### STEP 4- Oar Assembly

Insert shaft into blade, depress snap button, continue until snap button po

#### STEP 5- Oar Alignment

Oars are marked right and left. This is based on right and left while seate on top of oarlock frame. Oar handle should be away and blade should be until oarlock drops down flush to top of opening, Rotate oar handle to row rotate oar nearly 180 degrees from rowing position. To determine if corre 90 degrees to the water while the oar is straight out from the side of the F

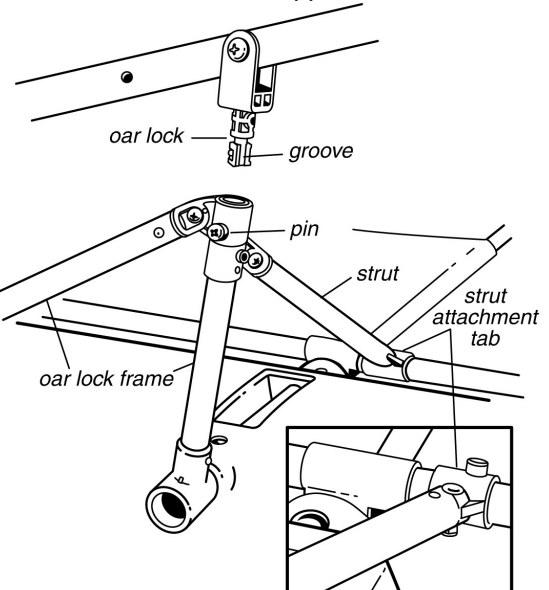

#### **STEP 6- Oar Clips**

(1" posts with plastic C-clamps attached) To install on oar, simply insert 3/8" post into 3/8" predrilled recess located near oarlock. Secure with 1 1/2" screw. Position opening in "C clamp perpendicular to shaft and tighten. Use the oar clip to snap the oars onto the crossbars when not in use. Lay the oar flat on the pontoon deck and snap clip onto crossbar where exposed in the trough on top of pontoon.

#### **\*\*Warning\*\***

All hinged and molded joint parts of the Float Cat Rowing System are designed and made specifically for use on the Hobie Float Cat. The rigid structure of the Float Cat is used to complete the rowing system for maximum strength. Do not twist parts into non intended positions while installing or removing the Float Cat Rowing System.

## **Hobie Float Cat Cargo Rack Assembly**

### **Cargo Rack Assembly**

Your cargo rack may already be completely assembled. If this is the case, proceed to Installation instructions.

**STEP 1-** Remove the screws from all of the threaded connectors.

**STEP 2-** Insert the end of the 17" piece of tubing into the 1/2" hole in the cross piece of the partially assembled rack.

**STEP 3-** Position the 17" piece so the 1/2" hole is facing the threaded connector on the short cross piece of the partially assembled rack. Insert the threaded connector into the 1/2" hole.

**STEP 4-** Secure both threaded connectors with supplied screws. Repeat process with second 17" piece to complete assembly.

### **Cargo Rack Installation Instructions**

**STEP 1-** Remove one pontoon from both cross bars.

**STEP 2-** Slide one cargo rack hanger onto the crossbar that the seat back attaches to.

**60:** The long off set end of the hanger with the hole drilled in it should face towards the center of the seat, and hang above the cross bar.

**75:** The long off set end of the hanger with the hole drilled in it should face towards the center of the seat, and hang underneath the cross bar.

**Rowing System Owners:** The cargo rack hangers should be on the inside, closest to the seat, of your footrest hangers.

Slide the pontoon back onto the cross as bars and repeat process with other pontoon.

**STEP 3-** Take the assembled rack and slide the ends, with 1/4" holes into hangers. The hangers must be on top of cross bar for Float Cat 60 and beneath cross bar for Float Cat 75.

**STEP 4-** Secure with lynch pins.

**60:** The cross piece rests on top of pontoons, with rack flat if the hangers were installed properly.

**75:** Push ends of long cross piece into indentations in pontoons. The cross piece will snap into place. Push hard to install and pull hard to remove; you will not damage the boat. The rack should sit flat if hangers were installed properly.

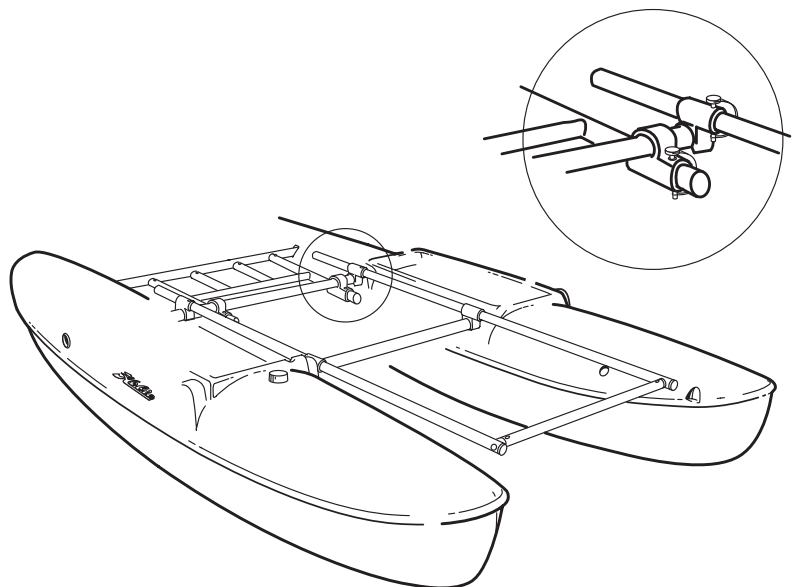

**(SEE ALSO: Large Diagrams Pg. 19)**



# HOBIE FLOAT CAT

---

## ASSEMBLY DETAIL

# EXPEDITION

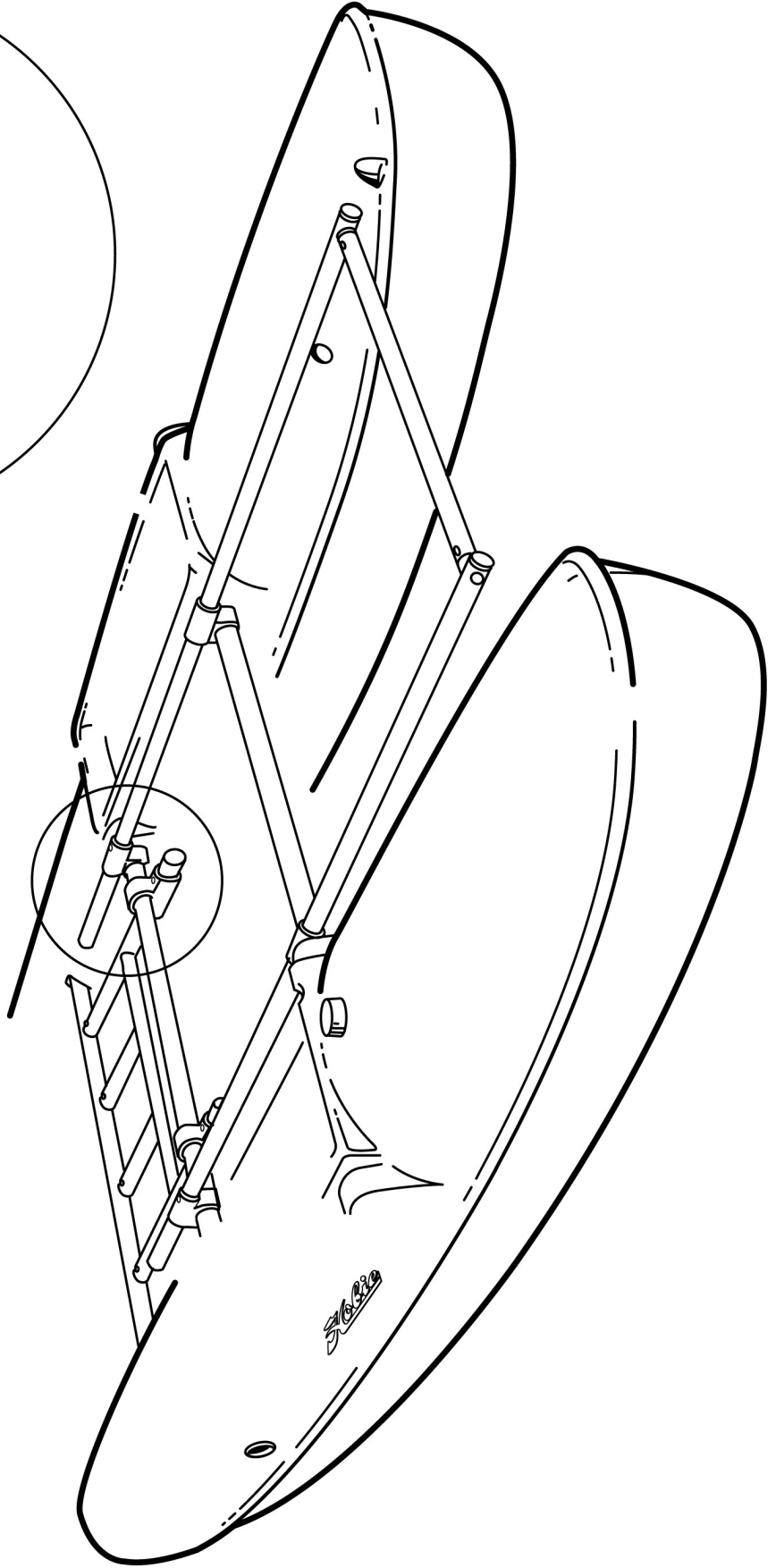
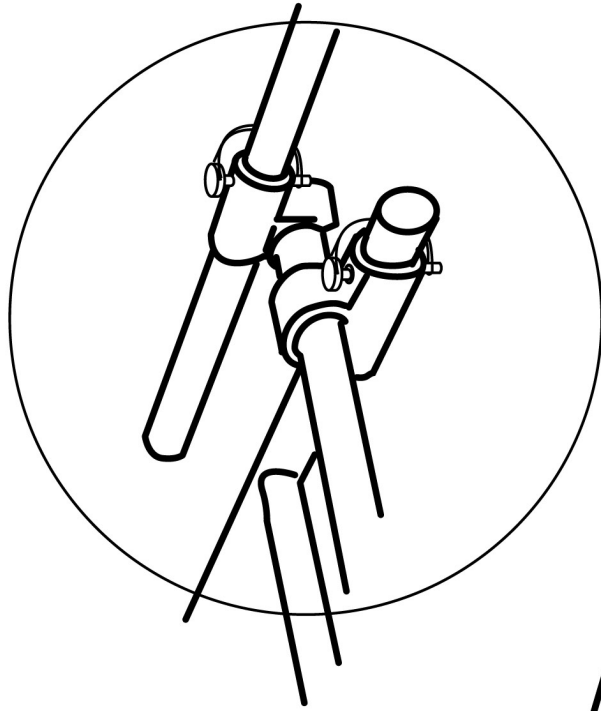

# Warranty

Hobie Outback warranties it's Float Cat products to be free of all defects in material and workmanship for the period of **Three years** from date of purchase. Upon receipt and inspection Hobie Outback will repair or replace at no charge any boats returned during the warranty period that are found defective. Please do not return the product without our prior authorization. If necessary repairs are covered by warranty, we will pay return shipping charges to any destination within the United States and Canada.

For the warranty to be effective, warranty card must be mailed with a copy of sales receipt. None of the exclusions may apply. All factory repairs after the three year warranty period carry a 90 Day Limited Warranty subject to exclusions and limitations as listed.

To enforce warranty or obtain repairs after limited warranty period, please contact us at (760) 758-9100 or by Fax at (760) 758-1841, and we will instruct you to either return the product to the company or how we can replace parts as needed. You must at your expense include postage, shipping charges, and insurance costs.

## Warranty Exclusions

This warranty does not apply under the following circumstances:

- If the product has been serviced or repaired by anyone other than an authorized Hobie Dealer.
- If the product has been altered, adjusted or handled in a manner other than according to the Owners Manual furnished with this product.
- If any defect, problem, loss or damage has resulted from any accident, misuse, negligence, or carelessness.
- If color fading or damage has taken place due to excess exposure to the sun.

We reserve the right to make changes or improvements in our product from time to time without incurring the obligation to install such improvements or changes on equipment previously manufactured.

## For Your Information:

Date Purchased: \_\_\_\_\_

Store Purchased: \_\_\_\_\_

Retain for your records



## Hobie Cat

4925 Oceanside Blvd., Oceanside, CA 92056

Tel: (760) 758-9100 Fax: (760) 758-1841

## SALT WATER USERS

Remove and discard crossbar endcaps. Flush crossbars and rinse entire float cat after each use with fresh water. Keep snap buttons protected with a lubricant such as WD-40TM

## SAFETY PRECAUTIONS

- Always wear a US. Coast Guard Approved Floatation Device. As with canoes and kayaks, there is a danger of falling over board. Always keep your weight centered. Flotation devices are mandatory for your safety.
- Your Float Cat was designed for Class 1 water or less. It was not designed for rough water, rapids, or high wind conditions. Always use common sense and take weather, wind and water conditions into account before using your Float Cat.
- Use common sense when using waders. Always wear a wader safety belt to keep water from entering your waders in case you need to get off your boat or you end up in the water.
- Always attach the supplied tether to yourself so you will never get separated from your boat.